

Serie Protection

H57PC

Nylon chain with opening aluminium covers

Inner height (D) 53,5 mm

Sideband construction with quickly removable pin. Covers openable from either side on both inner and outer radius. Vertical and horizontal modular separator system are available.

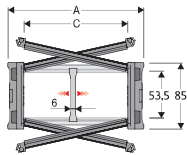

Separator	
- Unassembled	Part.no S57UA
- Assembled	Part.no S57UAMCI
- Assembled	Part.no S57UAMCE
Pin	
	Part.no PNH57RS

* for chain opening outer radius
** for chain opening inner radius

Technical characteristics when self-supported

Speed	8 m/s
Acceleration	40 m/s ²

For higher requirements please consult our technical dept.

For sliding applications, characteristics techniques may vary depending on the frequency, added weight and work environment.

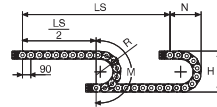

A	B	C	D	H	Weight/m	Chain
mm	mm	mm	mm	mm	kg	Part Number
113	85	75	53,5	180-200-250-300-350-400	4,23	H57PC075 □□□*
138	85	100	53,5	180-200-250-300-350-400	4,67	H57PC100 □□□*
163	85	125	53,5	180-200-250-300-350-400	5,11	H57PC125 □□□*
188	85	150	53,5	180-200-250-300-350-400	5,56	H57PC150 □□□*
213	85	175	53,5	180-200-250-300-350-400	6,00	H57PC175 □□□*
238	85	200	53,5	180-200-250-300-350-400	6,43	H57PC200 □□□*
263	85	225	53,5	180-200-250-300-350-400	6,88	H57PC225 □□□*
288	85	250	53,5	180-200-250-300-350-400	7,32	H57PC250 □□□*
313	85	275	53,5	180-200-250-300-350-400	7,77	H57PC275 □□□*
338	85	300	53,5	180-200-250-300-350-400	8,21	H57PC300 □□□*
368	85	350	53,5	180-200-250-300-350-400	9,09	H57PC350 □□□*
438	85	400	53,5	180-200-250-300-350-400	9,98	H57PC400 □□□*

*Complete the code by inserting the value of the radius (R); Ex. H57PC100 □□□□

Separator	
- Unassembled	Part.no S57CF3
- Assembled*	Part.no S57CF3MCI
- Assembled**	Part.no S57CF3MCE

* for chain opening outer radius
** for chain opening inner radius

H57PN Version nylon covers

A	B	C	D	H	Weight/m	Chain
mm	mm	mm	mm	mm	kg	Part Number
188	85	150	57	150-180-200-250-300-350-400	4,47	H57PN150 □□□*
238	85	200	57	150-180-200-250-300-350-400	4,92	H57PN200 □□□*
288	85	250	57	150-180-200-250-300-350-400	5,45	H57PN250 □□□*

*Complete the code by inserting the value of the radius (R); Ex. H57PN188 □□□□

**H57PN with R 150: not to be used in sliding applications.

R	H	N	M	N1	M1
mm	mm	mm	mm	mm	mm
150**	385	283	655	-	-
180	445	430	750	705	1570
200	485	480	810	805	1795
250	585	530	970	1040	2350
300	685	580	1125	1275	2905
350	785	680	1280	1510	3460
400	885	780	1440	1750	4020

Length of chain (L)
Half travel distance ($\frac{LS}{2}$)
plus length of curve (M) or (M1)

$$L = \frac{LS}{2} + M \text{ or } M1$$

Self-Supporting Capacity Diagram

The maximum capacity of the self-supporting capacity of the chain ($\frac{LS}{2}$) in relationship to the weight of the cables and hoses contained per linear metre.

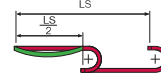
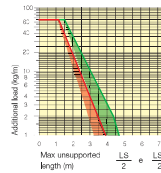

The area in the diagram considers the difference of weight between various widths of chain.

Red for self-supporting chain, green for chain in admissible sagging.

For applications with ($\frac{LS}{2}$) and weights not included in the diagram of self-supporting capacity, verify the possible use of support rollers (see page 30).

End Brackets

The end brackets set allows the two ends of the chain to be attached to the equipment. Set complete with tiewrap clamps available on request.

Nylon version

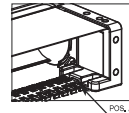
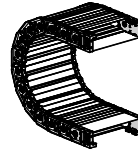
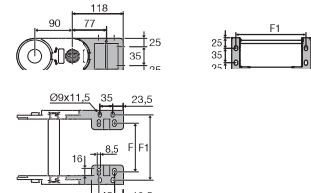

Fig. A The chain can be fixed frontally, inner or outer radius. (Fig A)



Chain Type	mm	F1	mm
H57PC075	51	H57PC075	98
H57PC100	76	H57PC100	123
H57PC125	101	H57PC125	148
H57PC150	126	H57PC150	173
H57PC175	151	H57PC175	198
H57PC200	176	H57PC200	223
H57PC225	201	H57PC225	248
H57PC250	226	H57PC250	273
H57PC275	251	H57PC275	298
H57PC300	276	H57PC300	323
H57PC350	326	H57PC350	373
H57PC400	376	H57PC400	423

Nylon Type Part Numbers

Complete Set Assembled Chain	End Brackets	Complete Set Assembled Mounting	Tiewrap Clamp
Type	Set	Position	set
H57P...	ANH57P□□□KMO**	Pos. A	SFCTH57□□□KMA

Complete Set Unassembled Chain	End Brackets	Complete Set Unassembled Mounting	Tiewrap Clamp
Type	Set	Position	set
H57P...	ANH57P□□□K	Pos. A	SFCTH57□□□KA

** 1=Pos.1; 2=Pos.2; 3=Pos.3

* Inner Width C



Serie Protection

H57PC

Nylon chain with opening aluminium covers

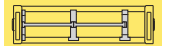

Separation System To choose the separators see page 196



How to open the cover

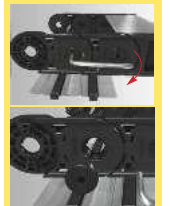

Easy opening of the pin junction.

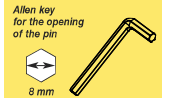

Allen key for the opening of the pin



Suitable for long travel distance.

For further information please consult Brevetti Stendalto's Technical Office