

Serie Heavy

308SU

Nylon Cable Chain with opening frames

Inner height (D) 57 mm

Strong double share Sideband & Frame construction with large anti-friction triple-pin. Frames opening from inner and outer radius. As standard the chain comes with frames every second link, on request with frames every link. Vertical and horizontal modular separator system is available.

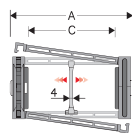

Separator	
- Unassembled	PartNo S308C
- Assembled	PartNo S308CMC
- Assembled**	PartNo S308CMCE
Strong-hold separator	
for C > 250 mm	
- Unassembled	PartNo S308SHF
- Assembled	PartNo S308SHFMC
- Assembled**	PartNo S308SHFVCE
Pin	
- Unassembled	PartNo PG308

* for chain opening outer radius
** for chain opening inner radius

Technical characteristics when self-supported

Speed	8 m/s
Acceleration	40 m/s ²

For higher requirements please consult our technical dept.

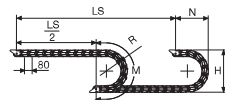

Length of chain (L)
Half travel distance ($\frac{LS}{2}$)
plus length of curve (M)

$$L = \frac{LS}{2} + M$$

R mm	H mm	N mm	M mm
135	345	255	585
150	375	270	635
180	435	300	725
200	475	320	790
230	535	350	885
280	635	400	1040
300	675	420	1105
400	875	520	1420
600	1175	720	2045

A mm	B mm	C mm	D mm	R mm	Weight/m kg	Chain Part Number
82	75	38	57	135-150-180-200-230-280-300-400-600	2.46	308SU038 □□□*
93	75	49	57	135-150-180-200-230-280-300-400-600	2.46	308SU049 □□□*
107	75	63	57	135-150-180-200-230-280-300-400-600	2.51	308SU063 □□□*
113	75	69	57	135-150-180-200-230-280-300-400-600	2.53	308SU069 □□□*
117	75	73	57	135-150-180-200-230-280-300-400-600	2.54	308SU073 □□□*
127	75	83	57	135-150-180-200-230-280-300-400-600	2.56	308SU083 □□□*
132	75	88	57	135-150-180-200-230-280-300-400-600	2.56	308SU088 □□□*
139	75	96	57	135-150-180-200-230-280-300-400-600	2.58	308SU096 □□□*
149	75	105	57	135-150-180-200-230-280-300-400-600	2.59	308SU105 □□□*
157	75	113	57	135-150-180-200-230-280-300-400-600	2.62	308SU113 □□□*
168	75	124	57	135-150-180-200-230-280-300-400-600	2.65	308SU124 □□□*
182	75	138	57	135-150-180-200-230-280-300-400-600	2.67	308SU138 □□□*
207	75	163	57	135-150-180-200-230-280-300-400-600	2.73	308SU163 □□□*
232	75	188	57	135-150-180-200-230-280-300-400-600	2.79	308SU188 □□□*
243	75	199	57	135-150-180-200-230-280-300-400-600	2.81	308SU199 □□□*
257	75	213	57	135-150-180-200-230-280-300-400-600	2.84	308SU213 □□□*
284	75	240	57	135-150-180-200-230-280-300-400-600	2.90	308SU240 □□□*
293	75	249	57	135-150-180-200-230-280-300-400-600	2.92	308SU249 □□□*
318	75	274	57	135-150-180-200-230-280-300-400-600	2.99	308SU274 □□□*
344	75	300	57	135-150-180-200-230-280-300-400-600	3.02	308SU300 □□□*
366	75	322	57	135-150-180-200-230-280-300-400-600	3.07	308SU322 □□□*
394	75	350	57	135-150-180-200-230-280-300-400-600	3.13	308SU350 □□□*

*Complete the code by inserting the value of the radius (R); Ex. 308SU105 □□□□
Chain equipped with nylon frame every pitch; complete the code by inserting the letter D.
Ex. 308SU105150 □□



Version with frames mounted on every pitch.

Self-Supporting Capacity Diagram

The maximum length of the self-supporting capacity ($\frac{LS}{2}$) in relationship to the weight of the cables and hoses contained per linear metre.

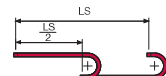
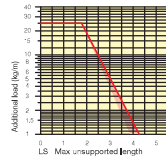

The red marking in the diagram area considers the difference of weight between various widths of chains assembled with nylon frames every second pitch.

For applications with $\frac{LS}{2}$ and weights not included in the area of the diagram showing self-supporting capacity, verify the possible use of support rollers (see page 30).

End Brackets

The end brackets set allows the two ends of the chain to be attached to the equipment. Set complete with tiewrap clamps available on request.

Nylon Type

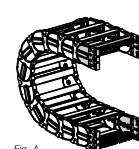
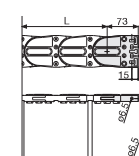

Fig. A The chain can be fixed frontally, inner or outer radius. (Fig A)



Chain Type	F mm
308SU038	62
308SU049	73
308SU063	87
308SU069	93
308SU073	97
308SU083	107
308SU088	112
308SU096	119
308SU105	129
308SU113	137
308SU124	148
308SU138	162
308SU163	187
308SU188	212
308SU199	222
308SU213	237
308SU240	264
308SU249	273
308SU274	298
308SU300	324
308SU322	345
308SU350	374

Nylon Type Part Numbers

Complete Set Assembled Chain	End Brackets
Type	Set
308SU...	AN308SKM
Complete Set Unassembled Chain	End Brackets
Type	Set
308SU...	AN308SK
Tiewrap Clamp	
Assembl.	CFC308S □□□*KM
Unassembl.	CFC308S □□□*K

Bright Zinc Plated Steel Type***

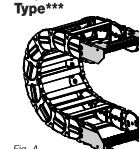
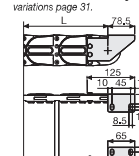

Fig. A Chain fixed outside the radius. (Fig A) See end brackets mounting variations page 31.



Chain Type	F mm
308SU038	62
308SU049	73
308SU063	87
308SU069	93
308SU073	97
308SU083	107
308SU088	112
308SU096	119
308SU105	129
308SU113	137
308SU124	148
308SU138	162
308SU163	187
308SU188	212
308SU199	222
308SU213	237
308SU240	264
308SU249	273
308SU274	298
308SU300	324
308SU322	345
308SU350	374

Bright Zinc Plated Steel Type Part Numbers

Complete Set Assembled Chain	End Brackets
Type	Set
308SU...	A308SKM □**
Complete Set Unassembled Chain	End Brackets
Type	Set
308SU...	A308SK □**
Tiewrap Clamp	
Assembl.	SFCT308S □□□*KM
Unassembl.	SFCT308S □□□*K

** Inner width (C)
*** In-Proc. 1; 2=Proc.2; 3=Proc.3
*** Available on request in stainless steel



Serie Heavy

308SU Nylon Cable Chain with opening frames



Separation System To choose the separators see page 196

How to open the cover.

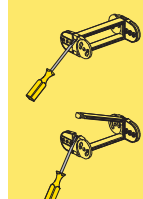

Protection version



Protection version see page 144

For further information please consult Brevetti Stendallo's Technical Office