

Serie Steel

35LC

Stainless steel cable chain with the aluminium covers

Inner height (D) 65 mm

Bright Zinc Plated Steel Cable Chain with aluminium cover and the quote C can be in special size. Available it can be done in Stainless steel.

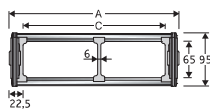

Separator

- Unassembled	Partno	ST3500F
- Assembled	Partno	ST3500FMC

Technical characteristics when self-supported

Speed	0.5 m/s
Acceleration	2 m/s ²

For higher requirements please consult our technical dept.

For sliding applications, characteristics techniques may vary depending on the frequency, added weight and work environment.

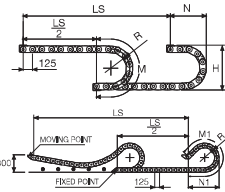

Length of chain (L)

Half travel distance ($\frac{LS}{2}$)

pLs length of curve (M) or (M1)

$$L = \frac{LS}{2} + M \text{ or } M1$$

Aluminium frames with nylon separators

A	B	C	D	R	Weight/m	Chain
mm	mm	mm	mm	mm	kg	Part Number
149	95	104	65	200-250-300-350-400-450-500-600	12,20	35LC104□□□□*
199	95	154	65	200-250-300-350-400-450-500-600	13,23	35LC154□□□□*
249	95	204	65	200-250-300-350-400-450-500-600	14,26	35LC204□□□□*
299	95	254	65	200-250-300-350-400-450-500-600	15,29	35LC254□□□□*
349	95	304	65	200-250-300-350-400-450-500-600	16,32	35LC304□□□□*
399	95	354	65	200-250-300-350-400-450-500-600	17,35	35LC354□□□□*
449	95	404	65	200-250-300-350-400-450-500-600	18,37	35LC404□□□□*
499	95	454	65	200-250-300-350-400-450-500-600	19,40	35LC454□□□□*
549	95	504	65	200-250-300-350-400-450-500-600	20,43	35LC504□□□□*
C+45	95	...	65	200-250-300-350-400-450-500-600		35LC□□□□□□**

*Complete the code by inserting the value of the radius (R): Ex. 35LC154□□□□

**Complete the code by inserting the value of the quote C and the radius (R): Ex. 35LC□□□□□□□□

R	H*	N	M	N1	M1
mm	mm	mm	mm	mm	mm
200	512	375	880	1100	2360
250	612	425	1040	1310	2870
300	712	480	1200	1495	3335
350	812	525	1350	1670	3775
400	912	575	1510	1825	4190
450	1012	625	1670	1975	4595
500	1112	675	1825	2120	4985
600	1312	775	2140	2390	5750

*The height H should be increased by 10 mm approx. because of preload. In case of limitation to the available space, refer to the Technical Dept.

Self-Supporting Capacity Diagram

The maximum length of the self-supporting capacity ($\frac{LS}{2}$) in relationship to the weight of the cables and hoses contained per linear metre.

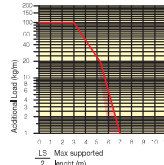

LS: Max supported length (m)

Bright Zinc Plated Steel End Brackets

The end brackets set, containing four steel plates screwed to the links allows the two ends of the chain to be attached to the equipment.

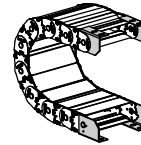
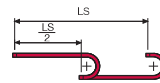

Fig. A Chain fixed outer radius (Fig A)



The red marking in the diagram area considers the difference of weight between various widths of chain.

For applications with $\frac{LS}{7}$ and weights not included in the area of the diagram showing self-supporting capacity, verify the possible use of support rollers (see page 30).

Chain Type	F1 mm	F2 mm
35LC104	76	86
35LC154	126	136
35LC204	176	186
35LC254	226	236
35LC304	276	286
35LC354	326	336
35LC404	376	386
35LC454	426	436
35LC504	476	486

Special widths
F1=A-71,5 F2=A-63,5

Bright Zinc Plated Steel Type Part Numbers

Complete Set Assemble	End Brackets type
35LC...	A35LCKM□□**
Complete Set Unassemble	End Brackets type
35LC...	A35LCK

** 1=Pos.1; 2=Pos.2; 3=Pos.3

Serie Steel

35LC

Stainless steel cable chain with the aluminium covers



Suitable to long travel distance See page 223