

## Serie Protection

# 445PS

## Nylon Protection Cable Chain with opening covers

**Inner height (D) 41 mm**  
 Sideband construction with anti-friction sledge-pin.  
 Covers openable only inner radius.  
 Vertical separator system are available.

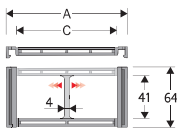

Separator	
- Unassembled	Part.No S445CNF
- Assembled	Part.No S445CNFMC
Pin	
	Part.No PG445

### Technical characteristics when self-supported

Speed	10 m/s
Acceleration	50 m/s <sup>2</sup>

For higher requirements please consult our technical dept.

A	B	C	D	R	Weight/m	Chain
mm	mm	mm	mm	mm	kg	Part Number
83	64	61	41	100-125-150-175-200-250-300	1,87	445PS061 □□□ *
97	64	75	41	100-125-150-175-200-250-300	2,05	445PS075 □□□ *
147	64	125	41	100-125-150-175-200-250-300	2,49	445PS125 □□□ *

\*Complete the code by inserting the value of the radius (R): Ex. 445PS061 □□□□

For sliding applications, characteristics techniques may vary depending on the frequency, added weight and work environment.

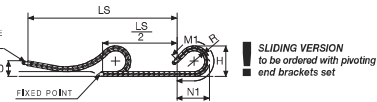
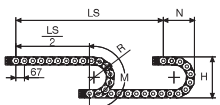

Length of chain (L)  
 Half travel distance ( $\frac{LS}{2}$ )  
 plus length of curve (M) or (M1)

$$L = \frac{LS}{2} + M \text{ or } M1$$

R	H	N	M	N1	M1
mm	mm	mm	mm	mm	mm
100	264	200	450	340	740
125	314	225	530	460	1020
150	364	250	605	580	1300
175	414	275	685	700	1575
200	464	300	765	820	1855
250	564	350	920	1055	2410
300	664	400	1080	1295	2970

### Self-Supporting Capacity Diagram

The maximum length of the self-supporting capacity ( $\frac{LS}{2}$ ) in relationship to the weight of the cables and hoses contained per linear metre.

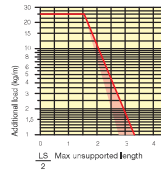

### End Brackets

The end brackets set allows the two ends of the chain to be attached to the equipment. Set complete with tiewrap clamps available on request.

#### Nylon version

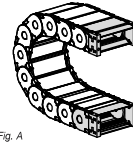

Fig. A The chain can be fixed frontally, inner or outer radius, (Fig A)

#### Nylon version

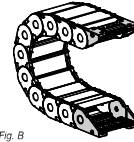
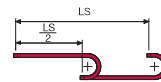
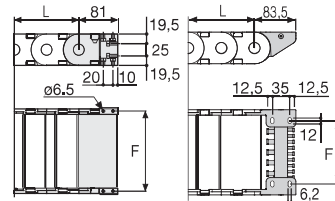

Fig. B Chain fixed outside the radius. (Fig B) See end brackets mounting variations page 31.



The red marking in the diagram area considers the difference of weight between various widths of chain.



Chain type	F mm
445PS 061	75
445PS 075	85
445PS 125	135

Chain type	F mm
445PS 161	95
445PS 175	105
445PS 195	115

For applications with  $\frac{LS}{2}$  and weights not included in the area of the diagram showing self-supporting capacity, verify the possible use of support rollers (see page 30).

### Nylon Type Part Numbers

Complete Set Assembled	AN445PS □□□ *KM
Complete Set Unassembled	AN445PS □□□ *K

### Nylon Type Part Numbers

Complete Set Assembled	AN445PSKM □ ****
Complete Set Unassembled	AN445PSK □ ****

### Tiewrap Clamp Part Number

Complete Set Assembled	SFCT445 □□□ *KM
Complete Set Unassembled	SFCT445 □□□ *K
****1-Pos.1; 2-Pos.2; 3-Pos.3; 5-Pos.5; 6-Pos.6	



## Serie Protection

# 445PS

## Nylon Protection Cable Chain with opening covers



**S445CNF**  
 This separator can be mounted in 2 ways different ensuring the same reliable resistance.

#### MOBILE separator



mounted outside the premises the separator can move

#### FIXED Separator



mounted inside the seats assumes a fixed position.

For further information please consult Brevetti Stendallo's Technical Office