

Serie Protection

H110PC

Nylon chain with opening aluminium covers

Inner height (D) 107 mm

Sideband construction with quickly removable pin. Covers openable from either side on both inner and outer radius. Vertical and horizontal modular separator system are available.

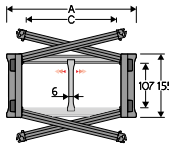

Separator	
- Unassembled	Part.no S110F3
- Assembled*	Part.no S110F3MCI
- Assembled**	Part.no S110F3MCE
Pin	
Part.no PNH110RS	

* for chain opening outer radius
** for chain opening inner radius

Technical characteristics when self-supported

Speed 10 m/s
Acceleration 50 m/s²

For higher requirements please consult our technical dept.

For sliding applications, characteristics techniques may vary depending on the frequency, added weight and work environment.

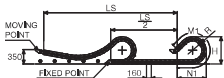
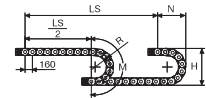

R	H	N	M	N1	M1
mm	mm	mm	mm	mm	mm
250	657	468	1110	1095	2375
300	757	518	1265	1335	2935
400	957	618	1580	1805	4045
500	1157	718	1895	2280	5160
600	1357	818	2205	2750	6270
700	1557	918	2520	3225	7385
750	1657	968	2680	3460	7940

A	B	C	D	R	Weight/m	Chain
mm	mm	mm	mm	mm	kg	Part Number
205	155	150	107	250-300-400-500-600-700-750	11,06	110PC150 □□□*
230	155	175	107	250-300-400-500-600-700-750	11,59	110PC175 □□□*
255	155	200	107	250-300-400-500-600-700-750	12,11	110PC200 □□□*
280	155	225	107	250-300-400-500-600-700-750	12,63	110PC225 □□□*
305	155	250	107	250-300-400-500-600-700-750	13,16	110PC250 □□□*
330	155	275	107	250-300-400-500-600-700-750	13,67	110SC275 □□□*
355	155	300	107	250-300-400-500-600-700-750	14,18	110SC300 □□□*
380	155	325	107	250-300-400-500-600-700-750	14,73	110PC325 □□□*
405	155	350	107	250-300-400-500-600-700-750	15,30	110PC350 □□□*
430	155	375	107	250-300-400-500-600-700-750	15,81	110PC375 □□□*

*Complete the code by inserting the value of the radius (R). Ex. 110PC350 □□□□

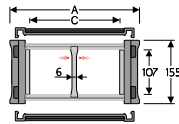

Separator	
- Unassembled	Part.No S110F3/8687
- Assembled*	Part.No S110F3/8687MCI
- Assembled**	Part.No S110F3/8687MCE
Pin	
Part.no PNH110RS	

* for chain opening outer radius
** for chain opening inner radius

H110PA

Version with openable frame by both sides

A	B	C	D	R	Weight/m	Chain
mm	mm	mm	mm	mm	kg	Chain Part Number
484	155	429	107	250-300-400-500-600-700-750	16,90	110PA429 □□□*
563	155	498	107	250-300-400-500-600-700-750	18,27	110PA498 □□□*

*Complete the code by inserting the value of the radius (R). Ex. 110PC429 □□□□

Self-Supporting Capacity Diagram

The maximum length of the self-supporting capacity or in admissible sagging ($\frac{LS}{2}$) in relationship to the weight of the cables and hoses contained per linear metre.

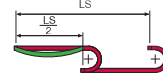
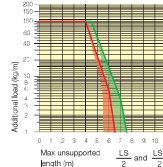

The area in the diagram considers the difference of weight between various widths of chain.

Red for self-supporting chain, green for chain in admissible sagging.

For applications with ($\frac{LS}{2}$) and weights not included in the diagram of self-supporting capacity, verify the possible use of support rollers (see page 30).

Bright Zinc Plated Steel End Brackets

The end brackets set allows the two ends of the chain to be attached to the equipment. Set complete with tiewrap clamps available on request.

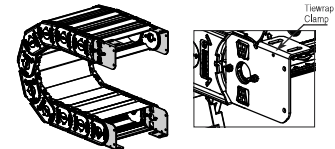
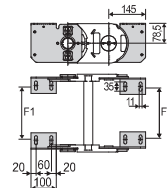

Fig. A Chain fixed outside or inside the radius, (Fig. A)



Chain Type	F1 mm	Chain Type	F2 mm
110PC150	120	110PC150	112
110PC175	145	110PC175	137
110PC200	170	110PC200	162
110PC225	195	110PC225	187
110PC250	220	110PC250	212
110PC275	245	110PC275	237
110PC300	270	110PC300	262
110PC325	295	110PC325	287
110PC350	320	110PC350	312
110PC375	344	110PC375	336
110PA429	369	110PA429	361
110PA498	408	110PA498	400
Special width	F1-C&S	Special width	F2-C&S

Bright Zinc Plated Steel Type Part Number

Complete Set Assembled Chain Type	End Brackets Set	Part Number
110PC A110PC □□□ KM □*	Assembled SFCT110 □□□ *FKM	Assembled SFCT110 □□□ *FKM
110PA A110PA □□□ KM □*	Unassembled SFCT110 □□□ *FKM	*Inner width (C)

Complete Set Unassembled Chain Type	End Brackets Set	Part Number
110PC A110PC □□□ K □*	Assembled SFCT110 □□□ *MKM	Assembled SFCT110 □□□ *MKM
110PA A110PA □□□ K □*	Unassembled SFCT110 □□□ *MKM	Unassembled SFCT110 □□□ *MKM
Available on request in stainless steel.		
** 14-Pos. 1, 24-Pos. 2, 34-Pos. 3		
See mounting variations page 31		



Serie Protection

H110PC

Nylon chain with opening aluminium covers

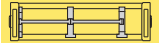

Separation System To choose the separators see page 196



How to open the covers

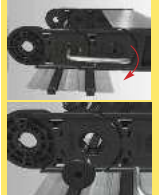

Easy opening of the pin junction.



Allen key for the opening of the pin



Suitable to long travel distance.

For further information please consult Brevetti Stendalto's Technical Office