



BOTECO®

YOUR MECHANICAL COMPONENT

GROUP - B

BRIDGE HANDLES



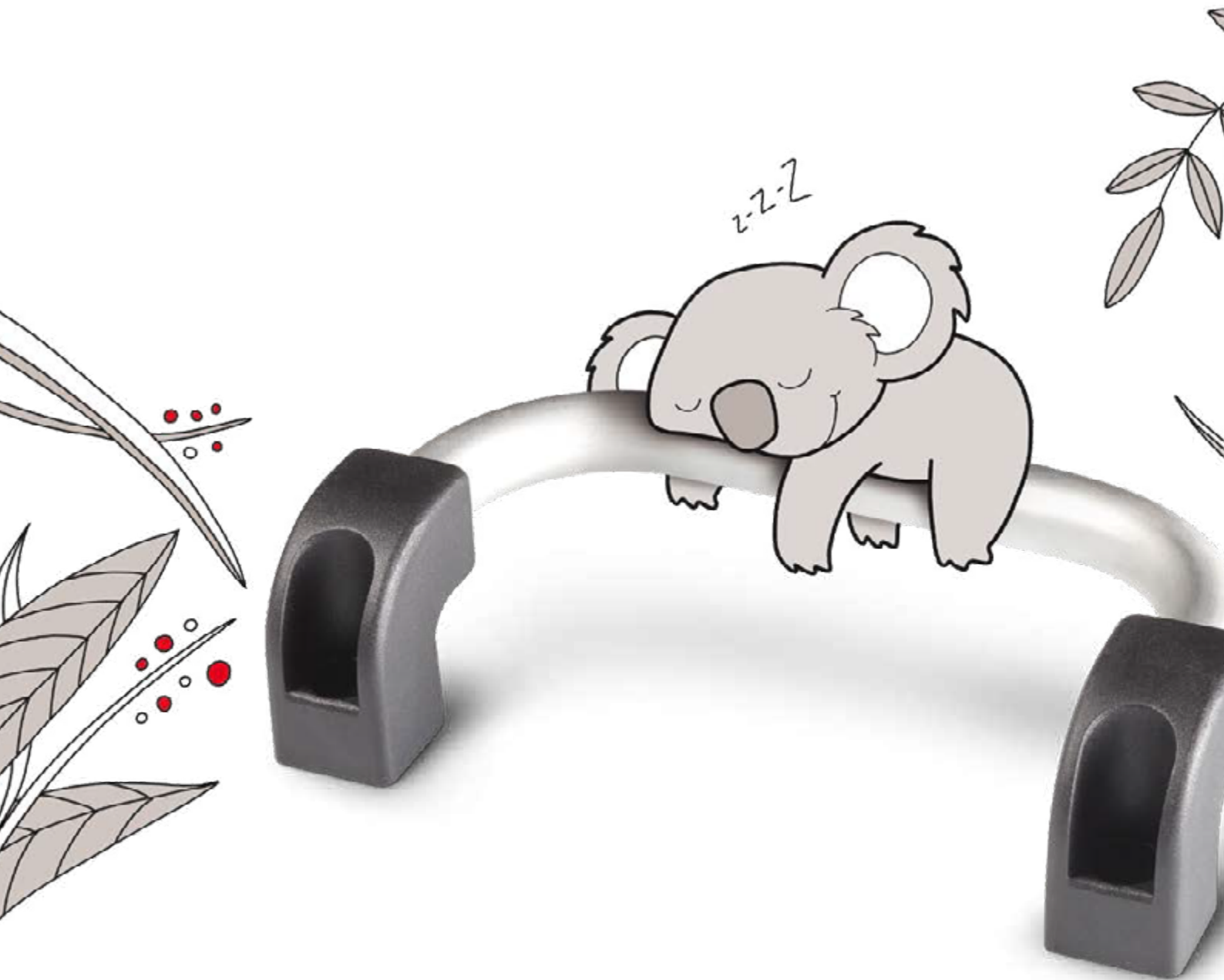

You'll sleep like a baby when
you choose **RELIABILITY.**



BOTECA[®]

B450

NEW



A.B.S.

UL94 HB

RoHS COMPLIANT

RECESSED HANDLE L. 123mm. WITH REAR CASE AND SCREW MOUNT

Materials:

(1-3) A.B.S. front plate and case

Surface finish:

Satin.

Colour:

Black: (RAL 9011 cod. 01).

Inserts:

(4) 2 galvanised steel self-tapping screws 2.9 (length varies according to the thickness of the panel).

Panel:

(2) Figurative panel as example.

Special requests:

- None.

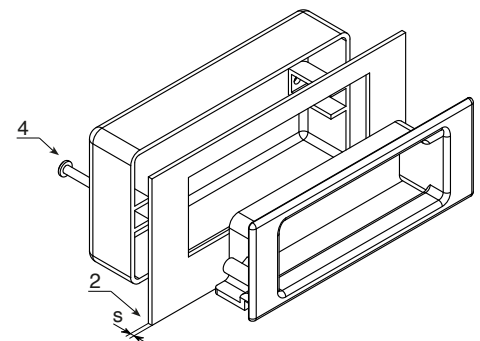
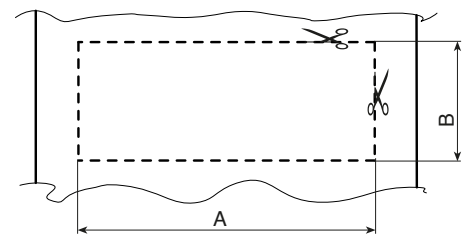
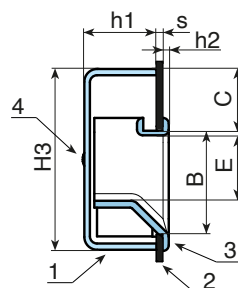
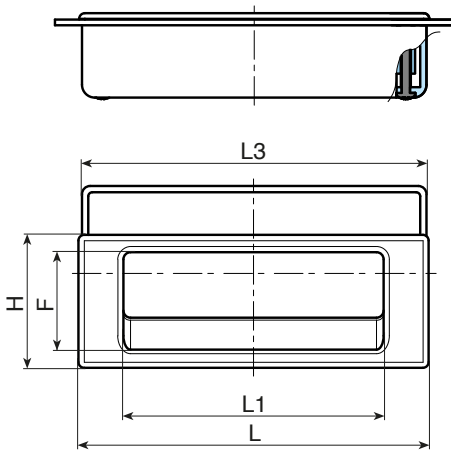

	art.	L	A	B	C	E	F	H	H3	L1	L3	h1	h2	s	g
●	B450123.AV101	123	114,5	38	22,7	22,5	37	47	63,5	93	121	26	2,5	1 - 1,8	58
●	B450123.AV201	123	114,5	38	22,7	22,5	37	47	63,5	93	121	26	2,5	1,9 - 3,3	58
●	B450123.AV301	123	114,5	38	22,7	22,5	37	47	63,5	93	121	26	2,5	3,4 - 4,8	58
●	B450123.AV401	123	114,5	38	22,7	22,5	37	47	63,5	93	121	26	2,5	4,9 - 6,3	58



Stock availability as % (🛒)
90% (●) - 40% (●) - 5% (●)

B240

NEW



SOLID HANDLE WITH SCREW AND NUT

Materials:

Reinforced polyamide.
Resistant to oils and greases.

Surface finish:

Satin.

Colour:

Black: (RAL 9011 cod. 01).

Inserts:

B240:

2 galvanised steel screws DIN 912.
2 galvanised steel nuts DIN 934.
2 galvanised steel perforated washers.

B240CIN:

2 stainless steel screws (Aisi 304) DIN 912.
2 stainless steel nuts (Aisi 304) DIN 934.
2 stainless steel perforated washers (Aisi 304).

Special requests:

- None.

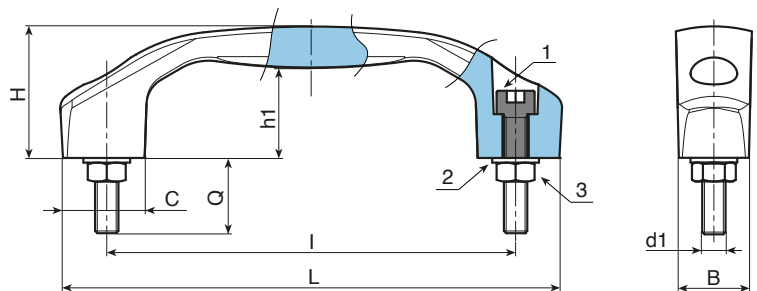

Version B240: with galvanised steel inserts

art.	L	I	B	C	H	h1	d1 _{6g}	Q	g	F1 (N)
B240100.TM05X2001	122	100	17	20	33	23,5	M5	20	53	1000
B240120.TM06X2501	146	120	21	24	39	27,5	M6	25	93	1000
B240140.TM08X3001	170	140	24	28	45	31	M8	30	150	1000

Version B240CIN: with stainless steel inserts (Aisi 304)

art.	L	I	B	C	H	h1	d1 _{6g}	Q	g	F1 (N)
B240100.TM05X2001CIN	122	100	17	20	33	23,5	M5	20	53	1000
B240120.TM06X2501CIN	146	120	21	24	39	27,5	M6	25	93	1000
B240140.TM08X3001CIN	170	140	24	28	45	31	M8	30	150	1000

INOX



Stock availability as % (🛒)
90% (●) - 40% (●) - 5% (●)

B230

NEW

+135°
-30°

PA6
+G.F.

UL94
HB

RoHS
COMPLIANT

"EUROMODEL" SAFETY HANDLE WITH THROUGH HOLES AND CENTRAL CAP

MODELLO
DEPOSITATO

Materials:

Reinforced polyamide.
Resistant to oils and greases.

Surface finish:

Satin.

Colour:

Black (RAL 9011).

Standard cap:

Rectangular cap in orange polyamide (RAL 2004 code 02).

Alternative cap colours:

Grey (RAL 7035 cod. 13).
Blue (RAL 5015 cod. 07).
Yellow (RAL 1021 cod. 10).
Red (RAL 3000 cod. 16).
Green (RAL 6024 cod. 17).
Black (RAL 9011 cod. 01).

Hole:

Smooth through hole obtained by moulding the plastic.

Version TS:

Seat for countersunk screw DIN 7991 / UNI 5933.

Version TC:

Seat for cylindrical head screw DIN 912 / UNI 5931.

Version TE:

Seat for hex head screw DIN 933 / UNI 4017, or for nut DIN 934 / UNI 5588.

Special requests:

- Upon request and for special quantities available in the colours indicated in the chart [page 807].

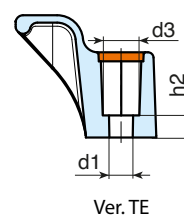
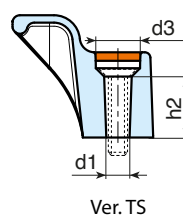
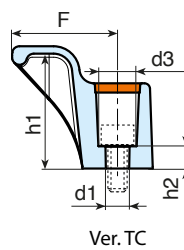
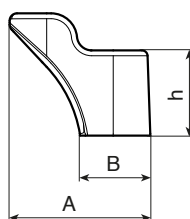
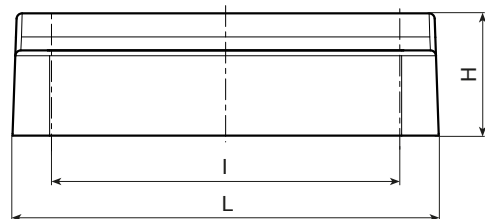

Ver. TC

Ver. TS

Ver. TE

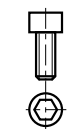

DIN 912

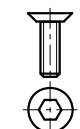

DIN 7991

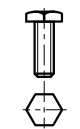

UNI 5727

Version TC: with hole for cylindrical head screws

art.	L	I	H	F	h	h1	h2	A	B	d3	d1	g
B230094.TG06.50102TC	115	94	33	28,5	23	31	6	38	19	10,3	6,5	54

Version TS: with hole for countersunk head screws

art.	L	I	H	F	h	h1	h2	A	B	d3	d1	g
B230094.TG06.50102TS	115	94	33	28,5	23	31	16,3	38	19	11,9	6,5	54

Version TE: with hole for hex head screws

art.	L	I	H	F	h	h1	h2	A	B	d3	d1	g
B230094.TG06.50102TE	115	94	33	28,5	23	31	6	38	19	10	6,5	54

B219



PF

UL94
HB

RoHS
COMPLIANT

DUROPLAST FIXED BRIDGE HANDLE WITH THREADED BORE INSERT

Materials:

Phenolic resin.
Resistant to oils and greases.
Resistant to high temperatures.

Surface finish:

Glossy.

Colour:

Black (RAL 9011).

Inserts:

Brass insert with female threaded hole (thread tolerance 6H).

Special requests:

- None.

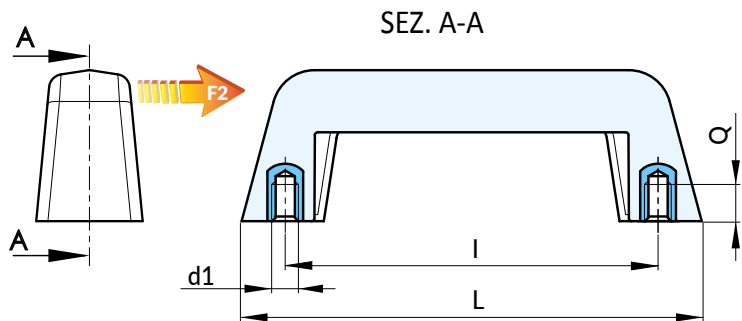
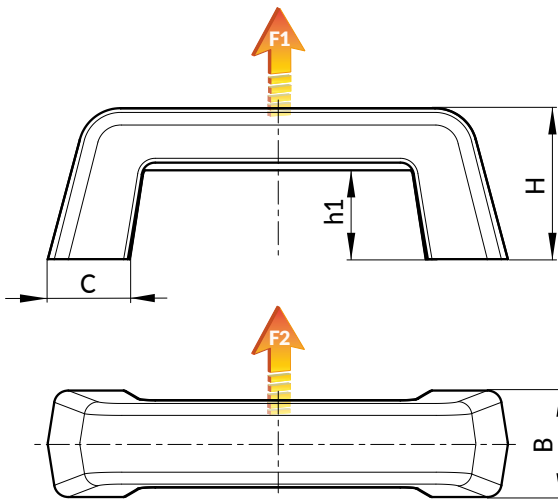

	art.	L	I	B	H	h1	C	d1 ^{6H}	Q	g	F1 (N)	F2 (N)
●	B219110.BM0501	130	110	30	45	27	20	M5	10	89	800	500
●	B219110.BM0601	130	110	30	45	27	20	M6	10	90	800	500
●	B219132.BM0801	164	132	38	55	34	30	M8	13	170	1500	850
●	B219132.BM1001	164	132	38	55	34	30	M10	18	172	1500	850
●	B219150.BM0801	188	150	40	60	43	35	M8	18	204	2000	1000
●	B219150.BM1001	188	150	40	60	43	35	M10	18	206	2000	1000

B221

FIXED HANDLE WITH NUT



Materials:

Reinforced polyamide.
Resistant to oils and greases.

Surface finish:

Satin.

Colour:

Black (RAL 9011).

Inserts:

Black oxide treated steel nuts DIN 934 - UNI 5588.

Special requests:

- Upon request and for special quantities inserts can be supplied in different materials.
- Upon request and for special quantities available in the colours indicated in the chart [page 807].

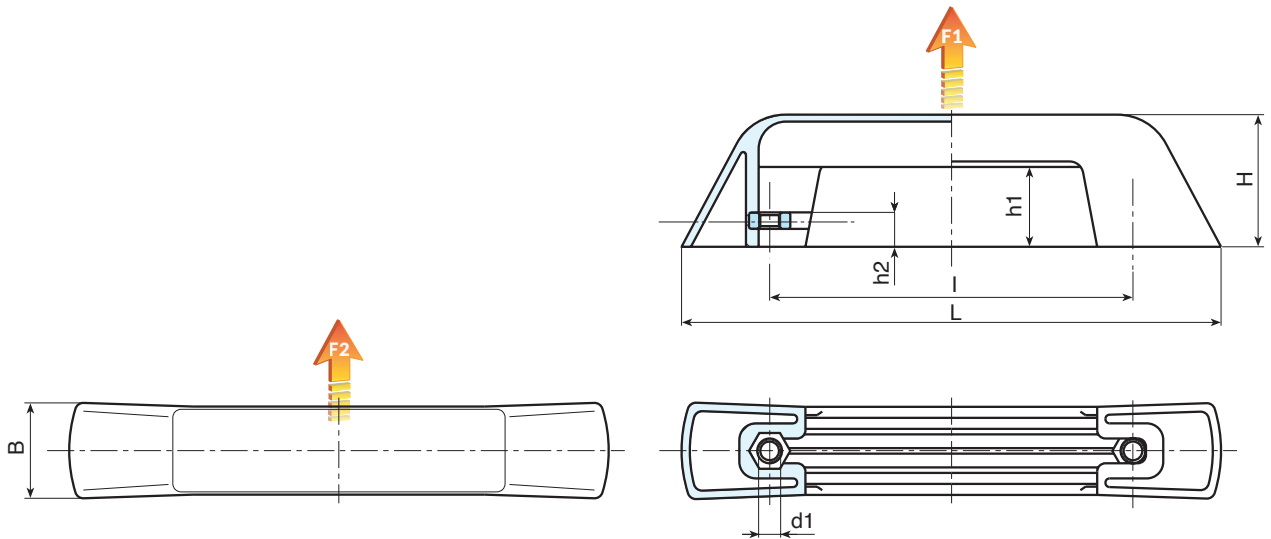

art.	L	I	B	H	h1	h2	d1	F1 (N)	F2 (N)
B221132.TM0801	198	132	34	48	29	12.5	M8	6785	3400

B222

FIXED BRIDGE HANDLE WITH THREADED HOLE



Materials:

Phenolic resin.
Resistant to oils and greases.
Resistant to high temperatures.

Surface finish:

Glossy.

Colour:

Black (RAL 9011).

Hole:

Female threaded hole obtained by moulding the plastic.

Special requests:

- None.

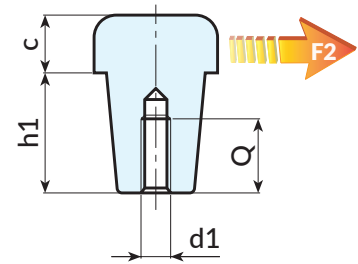
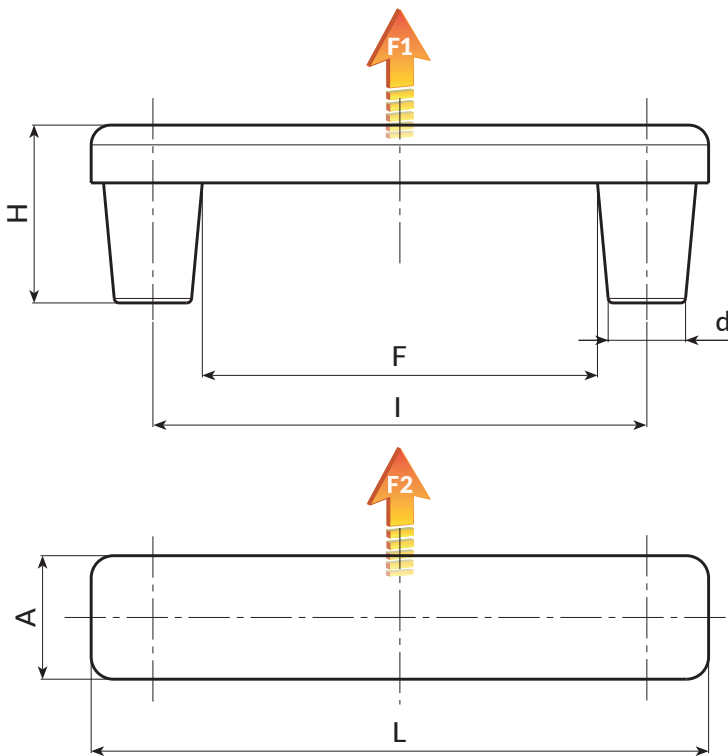

art.	L	l	F	A	H	h1	c	d	d1	Q	F1 (N)	F2 (N)
B222100.BM0601	125	100	80	25	35.5	23.5	12	15.5	M6	15	2000	1400



B223



FIXED BRIDGE HANDLE WITH SMOOTH THROUGH HOLE

Materials:

Phenolic resin.
Resistant to oils and greases.
Resistant to high temperatures.

Surface finish:

Glossy.

Colour:

Black (RAL 9011).

Hole:

Smooth through hole obtained by moulding the plastic.

Special requests:

- None.

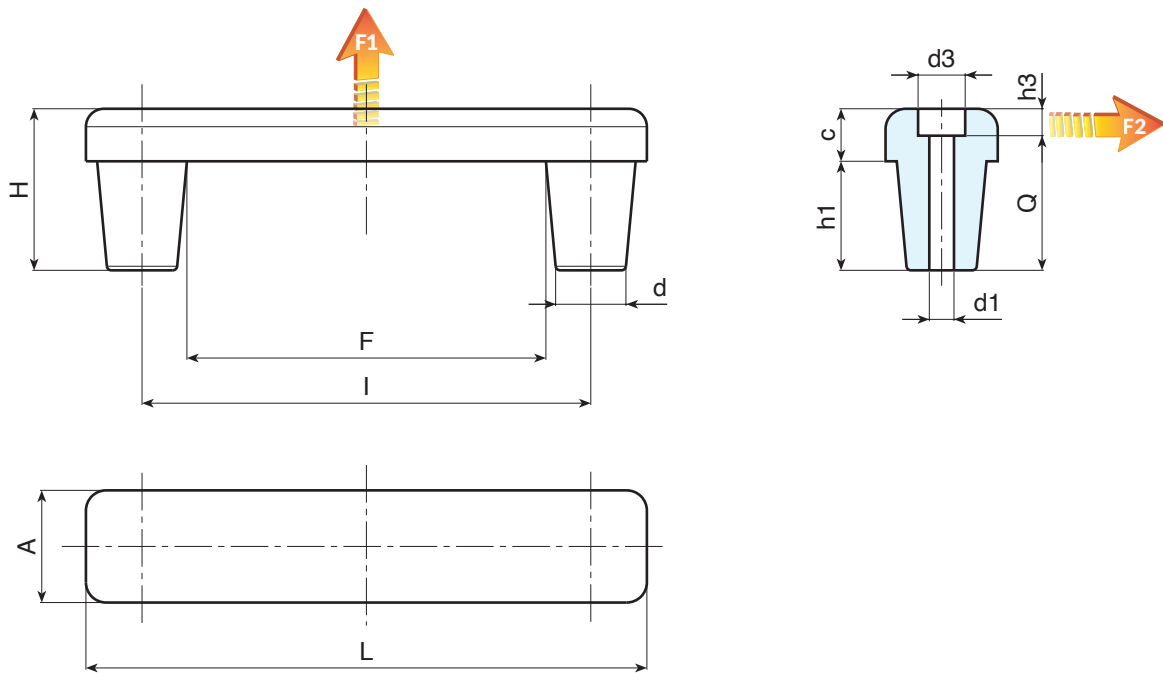

	art.	L	I	F	A	H	h1	h3	c	d	d3	d1	Q	g	F1 (N)	F2 (N)
●	B223100.BG5.501PP	125	100	80	25	34	23.5	6	10.5	15.5	10.5	5.5	30	55	2000	1400

B225

FIXED HANDLE FOR CURVED SURFACES

+135°
-30°

PA6
+G.F.

UL94
HB

RoHS
COMPLIANT

Materials:

Reinforced polyamide.
Resistant to oils and greases.

Surface finish:

Satin.

Colour:

Black (RAL 9011).

Hole:

Smooth through hole obtained by moulding the plastic for self-tapping screw.

Special requests:

- Upon request and for special quantities available in the colours indicated in the chart [page 807].

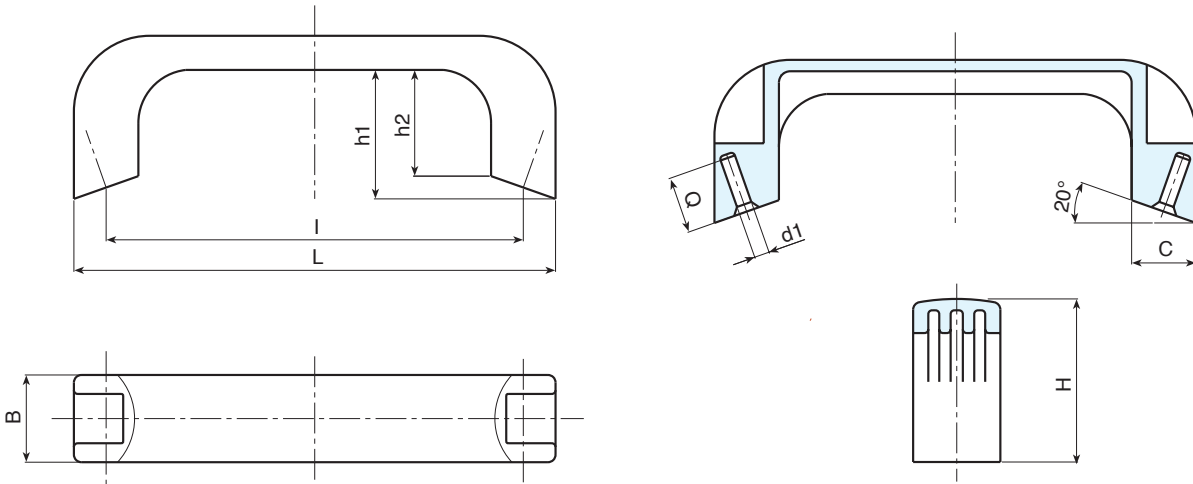

art.	L	l	B	H	h1	C	d1	Q	g
B225110.TG0401CP	127	110	24	43	34	16	4	16	35



Stock availability as % (🛒)
90% (●) - 40% (●) - 5% (●)

B229



FIXED HANDLE FOR CURVED SURFACES WITH INSERT

Materials:

Reinforced polyamide.
Resistant to oils and greases.

Surface finish:

Satin.

Colour:

Black (RAL 9011).

Insert:

Brass insert with female threaded hole (thread tolerance 6H).

Special requests:

- Upon request and for special quantities available in the colours indicated in the chart [page 807].

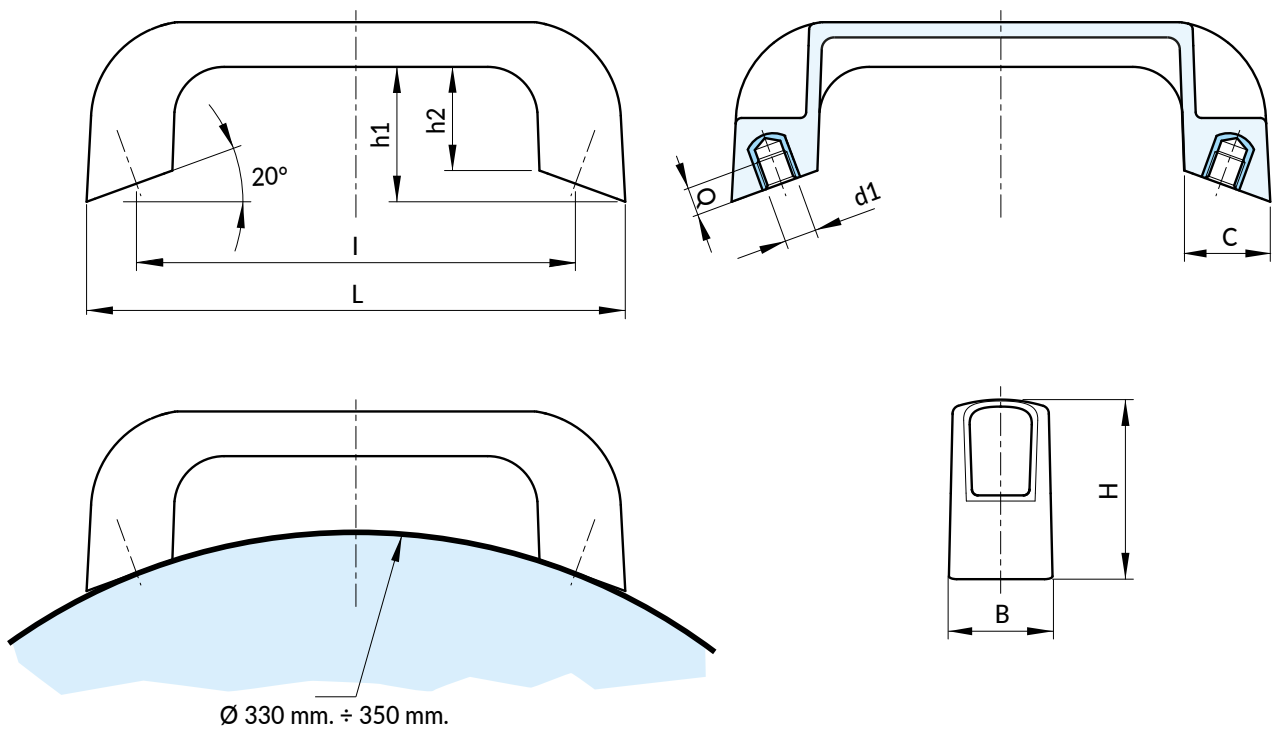

	art.	L	I	B	H	h1	h2	C	d16H	Q	g
●	B229110.TM0601	135	110	26	45	34	26	21.5	M6	8	55
●	B229110.TM0801	135	110	26	45	34	26	21.5	M8	7	54

B227

INCLINED HANDLE



Materials:
Reinforced polypropylene.

Surface finish:
Satin.

Colour:
Black (RAL 9011).

Hole:
Smooth through hole obtained by moulding the plastic.

Special requests:
• None.

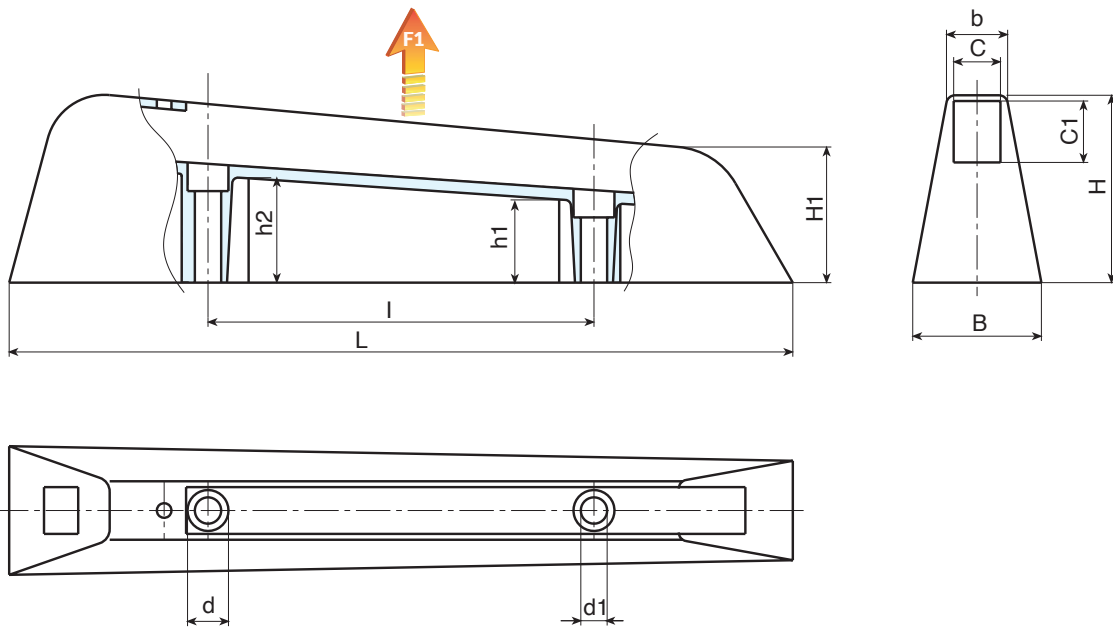

art.	L	I	B	b	H	H1	h1	h2	C	C1	d	d1	F1 (N)
● B227132.TG08.501PP	268	132	44	20	65	46	26	34	15.5	20.5	14	8.5	106 1540



Stock availability as % (🛒)
90% (●) - 40% (●) - 5% (●)

B228

FIXED HANDLE WITH THREADED STUD



Materials:

Reinforced polyamide.
Resistant to oils and greases.

Surface finish:

Satin.

Colour:

Black (RAL 9011).

Inserts:

Galvanised steel threaded stud (thread tolerance 6g).

Special requests:

- Upon request and for special quantities inserts can be supplied in different materials.
- Upon request and for special quantities available in the colours indicated in the chart [page 807].



B

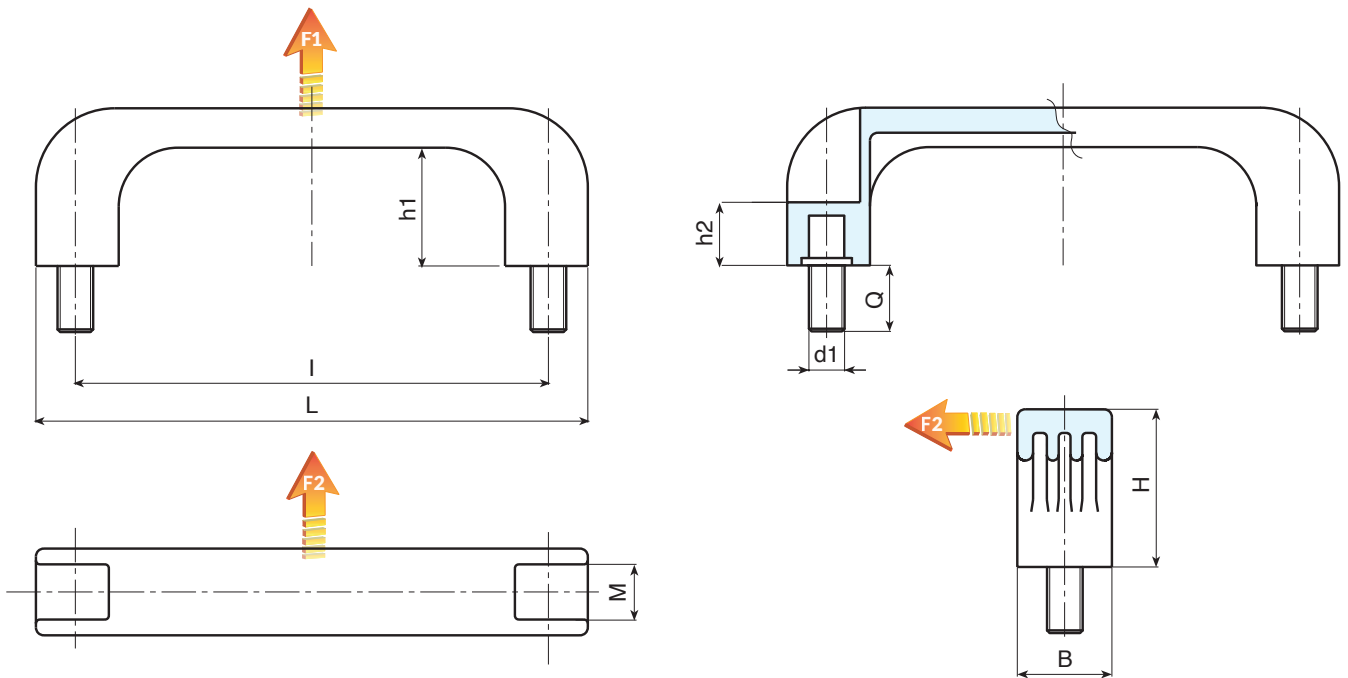

art.	L	I	B	M	H	h1	h2	Q	d1 _{6g}	g	F1 (N)	F2 (N)
● B228132.TM06X1601	151	132	26	14	43	31	16	16	M6	85	3000	2200

B226

FIXED HANDLE WITH THREADED INSERT



Materials:

Reinforced polyamide.
Resistant to oils and greases.

Surface finish:

Satin.

Colour:

Black (RAL 9011).

Inserts:

Brass insert with female threaded hole (thread tolerance 6H).

Special requests:

- Upon request and for special quantities inserts can be supplied in different materials.
- Upon request and for special quantities available in the colours indicated in the chart [page 807].

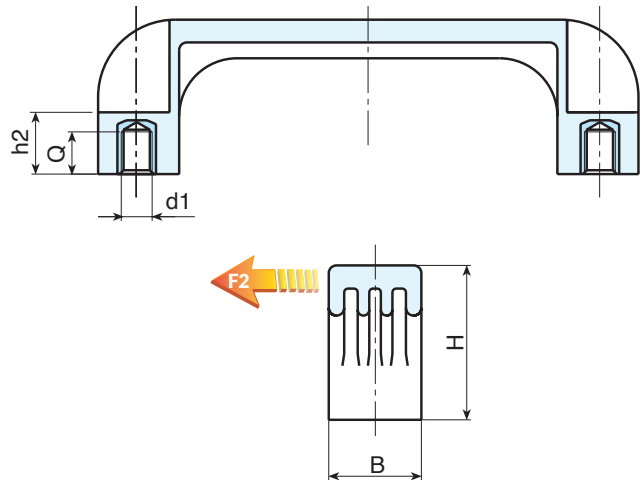
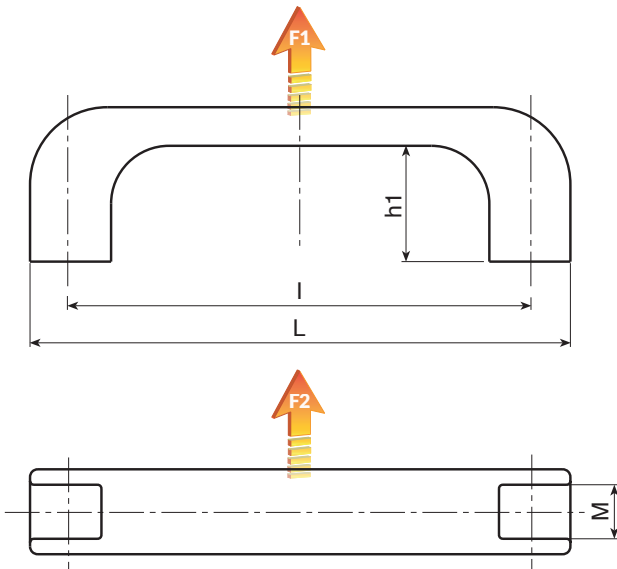

art.	L	I	B	M	H	h1	h2	Q	d1 _{6H}	g	F1 (N)	F2 (N)
B226094.TM0501	110	94	21	13	37	29	13	7	M5	23	4300	1300
B226094.TM0601	110	94	21	13	37	29	13	7	M6	23	4300	1300
B226117.TM0501	140	117	24	13	40	29	15	10	M5	43	4100	2800
B226117.TM0601	140	117	24	13	40	29	15	9	M6	43	4100	2800
B226117.TM0801	140	117	24	13	40	29	15	9	M8	43	4100	2800
B226120.TM0501	140	120	24	14	40	29	15	10	M5	43	6100	2800
B226120.TM0601	140	120	24	14	40	29	15	9	M6	43	6100	2800
B226120.TM0801	140	120	24	14	40	29	15	9	M8	43	6100	2800
B226132.TM0501	151	132	26	14	43	31	16	10	M5	70	7300	3500
B226132.TM0601	151	132	26	14	43	31	16	9	M6	70	7300	3500
B226132.TM0801	151	132	26	14	43	31	16	9	M8	70	3700	2800
B226180.TM0601	200	180	28	17	51	39	21	14	M6	87	3700	2800
B226180.TM0801	200	180	28	17	51	39	21	14	M8	88	3700	2800
B226235.TM0801	262	235	32	20	53	40	21	14	M8	123	4300	3200
B226235.TM1001	262	235	32	20	53	40	21	14	M10	123	4300	3200



Stock availability as % (🛒)
90% (●) - 40% (●) - 5% (●)

B224

FIXED HANDLE WITH THROUGH HOLE



Materials:

Reinforced polyamide.
Resistant to oils and greases.

Surface finish:

Satin.

Colour:

Black: (RAL 9011 cod. 01).
Orange: (RAL 2004 cod. 02).
Red: (RAL 3000 cod. 16).

Hole:

Smooth through hole obtained by moulding the plastic.

Special requests:

- Upon request and for special quantities available in the colours indicated in the chart [page 807].

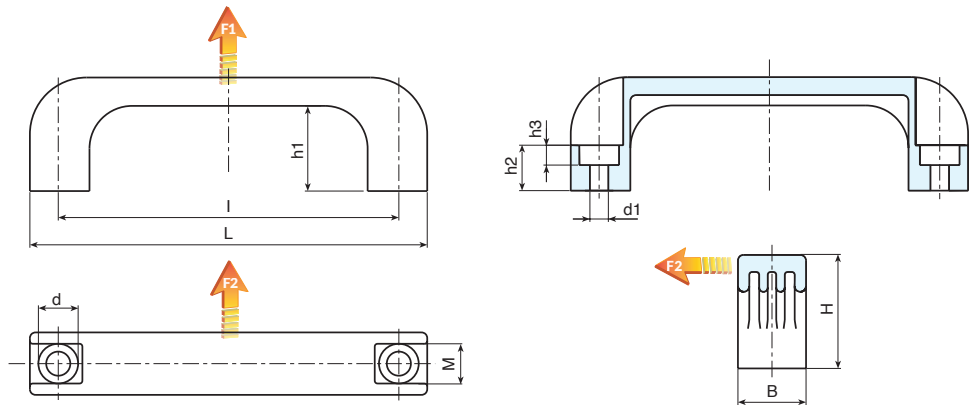

B224 - Black handle (RAL 9001 code 01)

art.	L	I	B	M	H	h1	h2	h3	d	d1	g	F1 (N)	F2 (N)
B224094.TG6.501PP	110	94	21	13	37	29	13	7	11	6.5	22	2500	1250
B224117.TG6.501PP	140	117	24	13	40	29	15	7	14	6.5	43	4400	3000
B224117.TG8.501PP	140	117	24	13	40	29	15	9	14	8.5	39	4400	3000
B224120.TG6.501PP	140	120	24	14	40	29	15	7	14	6.5	42	4800	3200
B224120.TG8.501PP	140	120	24	14	40	29	15	9	14	8.5	39	4800	3200
B224132.TG8.501PP	151	132	26	14	43	31	16	9	14	8.5	63	3400	3200
B224180.TG8.501PP	200	180	28	17	51	39	21	9	14	8.5	74	4000	3000
B224235.TG10.501PP	262	235	32	20	53	40	21	11	17	10.5	123	3800	3000

B224 - Orange handle (RAL 2004 code 04)

art.	L	I	B	M	H	h1	h2	h3	d	d1	g	F1 (N)	F2 (N)
B224094.TG6.502PP	110	94	21	13	37	29	13	7	11	6.5	22	2500	1250
B224117.TG6.502PP	140	117	24	13	40	29	15	7	14	6.5	43	4400	3000
B224117.TG8.502PP	140	117	24	13	40	29	15	9	14	8.5	39	4400	3000
B224120.TG6.502PP	140	120	24	14	40	29	15	7	14	6.5	42	4800	3200
B224120.TG8.502PP	140	120	24	14	40	29	15	9	14	8.5	39	4800	3200
B224132.TG8.502PP	151	132	26	14	43	31	16	9	14	8.5	63	3400	3200
B224180.TG8.502PP	200	180	28	17	51	39	21	9	14	8.5	74	4000	3000
B224235.TG10.502PP	262	235	32	20	53	40	21	11	17	10.5	123	3800	3000

B224 - Red handle (RAL 3000 code 16)

art.	L	I	B	M	H	h1	h2	h3	d	d1	g	F1 (N)	F2 (N)
B224094.TG6.516PP	110	94	21	13	37	29	13	7	11	6.5	22	2500	1250
B224117.TG6.516PP	140	117	24	13	40	29	15	7	14	6.5	43	4400	3000
B224117.TG8.516PP	140	117	24	13	40	29	15	9	14	8.5	39	4400	3000
B224120.TG6.516PP	140	120	24	14	40	29	15	7	14	6.5	42	4800	3200
B224132.TG8.516PP	151	132	26	14	43	31	16	9	14	8.5	63	3400	3200
B224180.TG8.516PP	200	180	28	17	51	39	21	9	14	8.5	74	4000	3000
B224235.TG10.516PP	262	235	32	20	53	40	21	11	17	10.5	123	3800	3000



Stock availability as % (🛒)
90% (●) - 40% (●) - 5% (●)

B224AE

SELF-EXTINGUISHING FIXED HANDLE WITH THROUGH HOLE

+135°
-30°

PA6
+G.F.

UL94
V0

RoHS
COMPLIANT

UL94 - V0

Materials:

Self-extinguishing reinforced polyamide UL94 V0 with yellow card.
Resistant to oils and greases.

Surface finish:

Satin.

Colour:

Black (RAL 9011).

Hole:

Smooth through hole obtained by moulding the plastic.

Special requests:

- None.

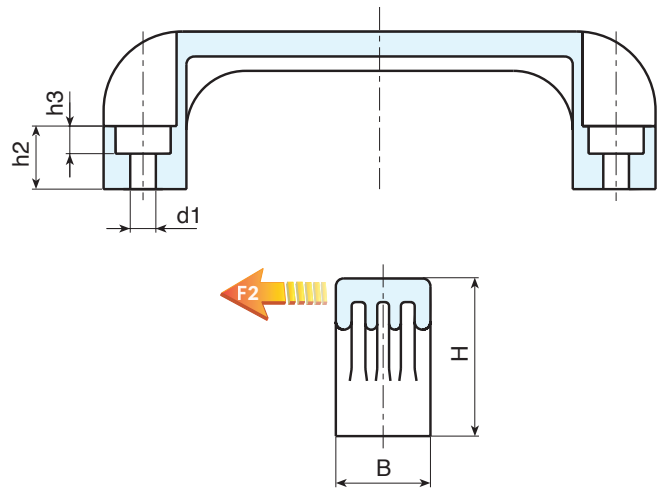
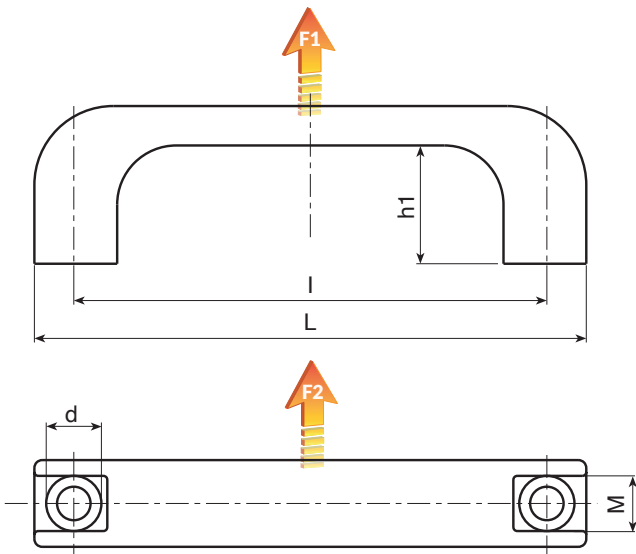

UL94 V0

art.	L	I	B	M	H	h1	h2	h3	d	d1	g	F1 (N)	F2 (N)
B224094.TG6.501AE	110	94	21	13	37	29	13	7	11	6.5	22	2500	1250
B224117.TG6.501AE	140	117	24	13	40	29	15	7	14	6.5	43	4400	3000
B224117.TG8.501AE	140	117	24	13	40	29	15	9	14	8.5	39	4400	3000
B224120.TG6.501AE	140	120	24	14	40	29	15	7	14	6.5	42	4800	3200
B224120.TG8.501AE	140	120	24	14	40	29	15	9	14	8.5	39	4800	3200
B224132.TG8.501AE	151	132	26	14	43	31	16	9	14	8.5	63	3400	3200
B224180.TG8.501AE	200	180	28	17	51	39	21	9	14	8.5	74	4000	3000
B224235.TG10.501AE	262	235	32	20	53	40	21	11	17	10.5	123	3800	3000



Stock availability as % (🛒)
90% (●) - 40% (●) - 5% (●)

B226AE



PA6
+G.F.

UL94
V0



SELF-EXTINGUISHING FIXED HANDLE WITH THREADED INSERT

UL94 - V0

Materials:

Self-extinguishing reinforced polyamide UL94 V0 with yellow card.
Resistant to oils and greases.

Surface finish:

Satin.

Colour:

Black (RAL 9011).

Inserts:

Brass insert with female threaded hole (thread tolerance 6H).

Special requests:

- Upon request and for special quantities inserts can be supplied in different materials.



B

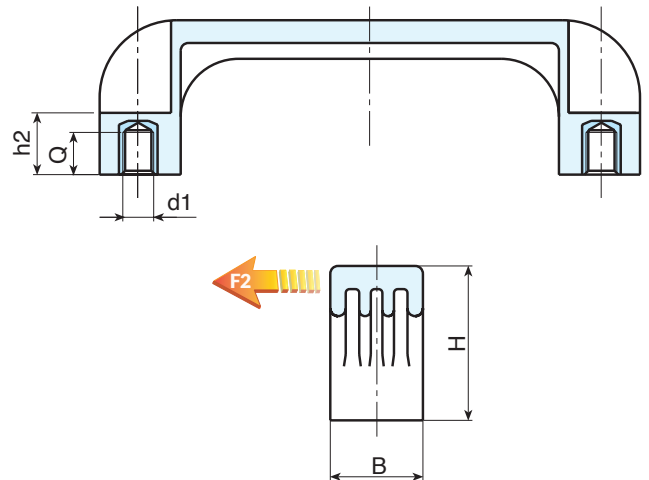
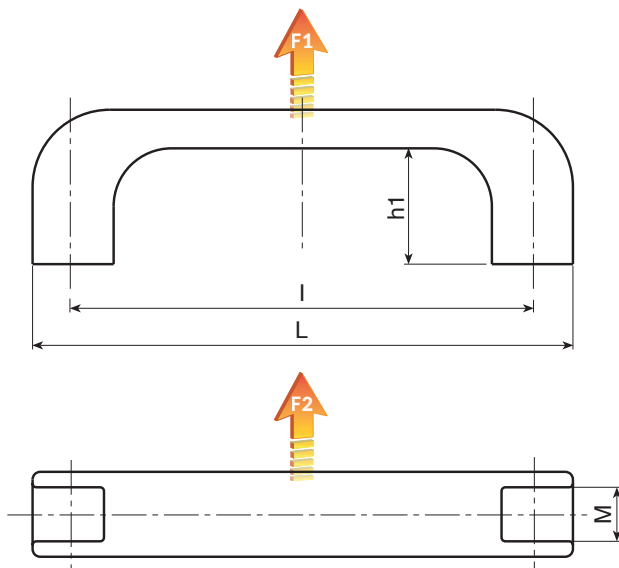

UL94 V0

🛒	art.	L	I	B	M	H	h1	h2	Q	d1 _{6H}	g	F1 (N)	F2 (N)
●	B226094.TM0501AE	110	94	21	13	37	29	13	7	M5	23	4300	1300
●	B226094.TM0601AE	110	94	21	13	37	29	13	7	M6	23	4300	1300
●	B226117.TM0501AE	140	117	24	13	40	29	15	10	M5	43	4100	2800
●	B226117.TM0601AE	140	117	24	13	40	29	15	9	M6	43	4100	2800
●	B226117.TM0801AE	140	117	24	13	40	29	15	9	M8	43	4100	2800
●	B226120.TM0501AE	140	120	24	14	40	29	15	10	M5	43	6100	2800
●	B226120.TM0601AE	140	120	24	14	40	29	15	9	M6	43	6100	2800
●	B226120.TM0801AE	140	120	24	14	40	29	15	9	M8	43	6100	2800
●	B226132.TM0501AE	151	132	26	14	43	31	16	10	M5	70	7300	3500
●	B226132.TM0601AE	151	132	26	14	43	31	16	9	M6	70	7300	3500
●	B226132.TM0801AE	151	132	26	14	43	31	16	9	M8	70	3700	2800
●	B226180.TM0801AE	200	180	28	17	51	39	21	14	M8	88	3700	2800
●	B226235.TM0801AE	262	235	32	20	53	40	21	14	M8	123	4300	3200
●	B226235.TM1001AE	262	235	32	20	53	40	21	14	M10	123	4300	3200



B236

SOLID HANDLE WITH THREADED INSERT



Materials:

Reinforced polyamide. Resistant to oils and greases.

Surface finish:

Satin.

Colour:

Black (RAL 9011).

Inserts:

Brass insert with female threaded hole (thread tolerance 6H).

Special requests:

- Upon request and for special quantities inserts can be supplied in different materials.
- Upon request and for special quantities available in the colours indicated in the chart [page 807].

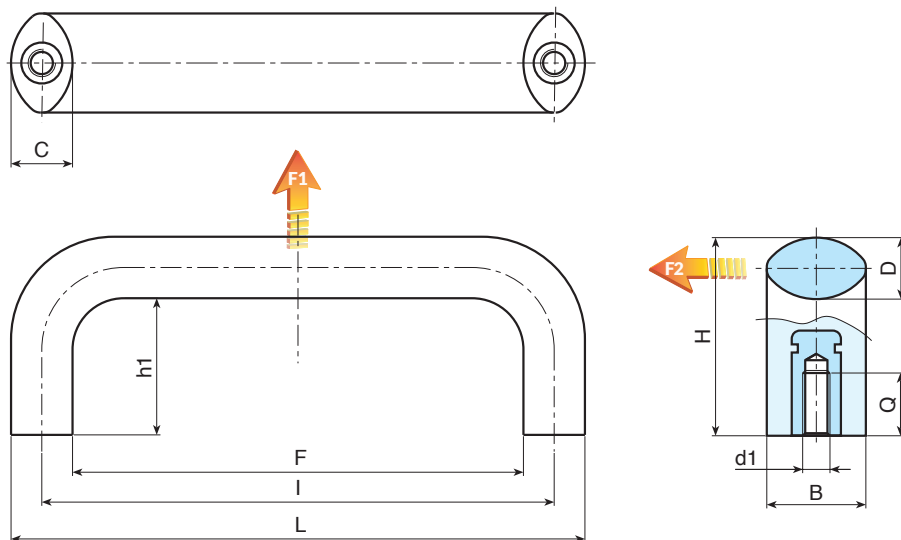

art.	L	I	F	B	C	D	H	h1	Q	d1 _{6H}	g	F1 (N)	F2 (N)
B236086.TM0501	98.5	86	73.5	20	12.5	12.5	40	28	10	M05	40	4000	1500
B236086.TM0601	98.5	86	73.5	20	12.5	12.5	40	28	9	M06	40	4000	1500
B236094.TM0501	106.5	94	81.5	20	12.5	12.5	40	28	10	M05	40	3300	1600
B236094.TM0601	106.5	94	81.5	20	12.5	12.5	40	28	9	M06	40	3300	1600
B236117.TM0501	134	117	102	25	16	16	50	34	10	M05	84	4400	1800
B236117.TM0601	134	117	102	25	16	16	50	34	9	M06	81	4400	1800
B236117.TM0801	134	117	102	25	16	16	50	34	14	M08	80	4400	1800
B236120.TM0501	134	120	102	25	16	16	50	34	10	M05	84	5200	2400
B236120.TM0601	134	120	102	25	16	16	50	34	9	M06	81	5200	2400
B236120.TM0801	134	120	102	25	16	16	50	34	14	M08	80	5200	2400
B236132.TM0501	148	132	116	25	16	16	50	34	10	M05	90	3700	2600
B236132.TM0601	148	132	116	25	16	16	50	34	9	M06	88	3700	2600
B236132.TM0801	148	132	116	25	16	16	50	34	14	M08	85	3700	2600
B236150.TM0601	168	150	132	29	18	18	58	40	15	M06	123	5900	1900
B236150.TM0801	168	150	132	29	18	18	58	40	14	M08	121	5900	1900
B236150.TM1001	168	150	132	29	18	18	58	40	14	M10	119	5900	1900
B236179.TM0801	197	179	161	29	18	18	58	40	14	M08	135	3800	3200
B236179.TM1001	197	179	161	29	18	18	58	40	14	M10	133	3800	3200



Stock availability as % (🛒)
90% (●) - 40% (●) - 5% (●)

B236CIN



SOLID HANDLE WITH STAINLESS STEEL THREADED INSERT

INOX

Materials:

Reinforced polyamide. Resistant to oils and greases.

Surface finish:

Satin.

Colour:

Black (RAL 9011).

Inserts:

Stainless steel insert with female threaded hole (Aisi 303) (thread tolerance 6H).

Special requests:

- Upon request and for special quantities available in the colours indicated in the chart [on page 807].

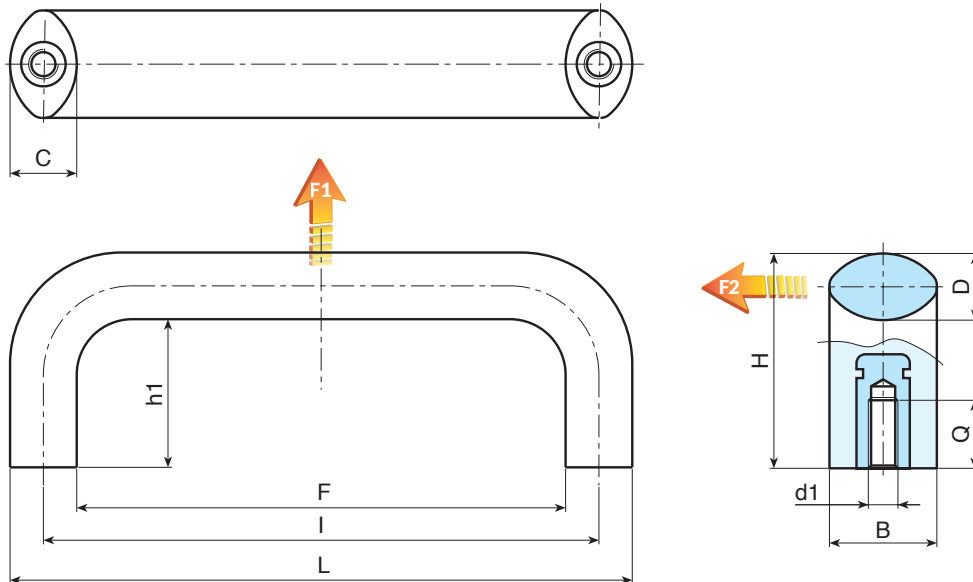

INOX

	art.	L	I	F	B	C	D	H	h1	Q	d16H	g	F1 (N)	F2 (N)
●	B236086.TM0501CIN	98.5	86	73.5	20	12.5	12.5	40	28	8	M5	40	4000	1500
●	B236086.TM0601CIN	98.5	86	73.5	20	12.5	12.5	40	28	9	M6	40	4000	1500
●	B236094.TM0501CIN	106.5	94	81.5	20	12.5	12.5	40	28	8	M5	40	3300	1600
●	B236094.TM0601CIN	106.5	94	81.5	20	12.5	12.5	40	28	9	M6	40	3300	1600
●	B236117.TM0501CIN	134	117	102	25	16	16	50	34	8	M5	84	4400	1800
●	B236117.TM0601CIN	134	117	102	25	16	16	50	34	9	M6	81	4400	1800
●	B236117.TM0801CIN	134	117	102	25	16	16	50	34	13	M8	80	4400	1800
●	B236120.TM0501CIN	134	120	102	25	16	16	50	34	8	M5	84	5200	2400
●	B236120.TM0601CIN	134	120	102	25	16	16	50	34	9	M6	81	5200	2400
●	B236120.TM0801CIN	134	120	102	25	16	16	50	34	13	M8	80	5200	2400
●	B236132.TM0501CIN	148	132	116	25	16	16	50	34	8	M5	90	3700	2600
●	B236132.TM0601CIN	148	132	116	25	16	16	50	34	9	M6	88	3700	2600
●	B236132.TM0801CIN	148	132	116	25	16	16	50	34	13	M8	85	3700	2600
●	B236150.TM0601CIN	168	150	132	29	18	18	58	40	9	M6	123	5900	1900
●	B236150.TM0801CIN	168	150	132	29	18	18	58	40	13	M8	121	5900	1900
●	B236150.TM1001CIN	168	150	132	29	18	18	58	40	16	M10	119	5900	1900
●	B236179.TM0801CIN	197	179	161	29	18	18	58	40	13	M8	135	3800	3200
●	B236179.TM1001CIN	197	179	161	29	18	18	58	40	16	M10	133	3800	3200



B236AE

SELF-EXTINGUISHING SOLID HANDLE WITH INSERT

+135°
-30°

PA6
+G.F.

UL94
V0

RoHS
COMPLIANT

UL94 - V0

Materials:

Self-extinguishing reinforced polyamide UL94 V0 with yellow card.
Resistant to oils and greases.

Surface finish:

Satin.

Colour:

Black (RAL 9011).

Inserts:

Brass insert with female threaded hole (thread tolerance 6H).

Special requests:

- Upon request and for special quantities inserts can be supplied in different materials.

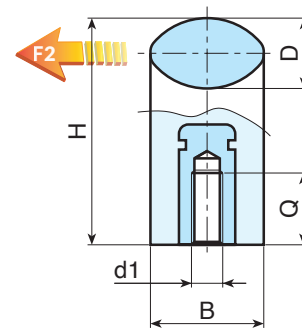
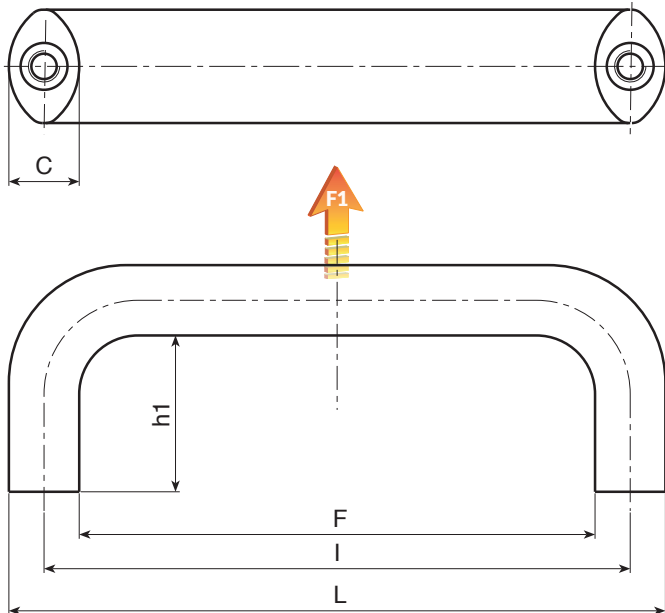

UL94 V0

art.	L	I	F	B	C	D	H	h1	Q	d1 _{6H}	g	F1 (N)	F2 (N)
● B236086.TM0501AE	98.5	86	73.5	20	12.5	12.5	40	28	10	M5	40	4000	1500
● B236086.TM0601AE	98.5	86	73.5	20	12.5	12.5	40	28	9	M6	40	4000	1500
● B236094.TM0501AE	106.5	94	81.5	20	12.5	12.5	40	28	10	M5	40	3300	1600
● B236094.TM0601AE	106.5	94	81.5	20	12.5	12.5	40	28	9	M6	40	3300	1600
● B236117.TM0501AE	134	117	102	25	16	16	50	34	10	M5	84	4400	1800
● B236117.TM0601AE	134	117	102	25	16	16	50	34	9	M6	81	4400	1800
● B236117.TM0801AE	134	117	102	25	16	16	50	34	14	M8	80	4400	1800
● B236120.TM0501AE	134	120	102	25	16	16	50	34	10	M5	84	5200	2400
● B236120.TM0601AE	134	120	102	25	16	16	50	34	9	M6	81	5200	2400
● B236120.TM0801AE	134	120	102	25	16	16	50	34	14	M8	80	5200	2400
● B236132.TM0501AE	148	132	116	25	16	16	50	34	10	M5	90	3700	2600
● B236132.TM0601AE	148	132	116	25	16	16	50	34	9	M6	88	3700	2600
● B236132.TM0801AE	148	132	116	25	16	16	50	34	14	M8	85	3700	2600
● B236150.TM0601AE	168	150	132	29	18	18	58	40	15	M6	123	5900	1900
● B236150.TM0801AE	168	150	132	29	18	18	58	40	14	M8	121	5900	1900
● B236150.TM1001AE	168	150	132	29	18	18	58	40	14	M10	119	5900	1900
● B236179.TM0801AE	197	179	161	29	18	18	58	40	14	M8	135	3800	3200
● B236179.TM1001AE	197	179	161	29	18	18	58	40	14	M10	133	3800	3200



Stock availability as % (🛒)
90% (●) - 40% (●) - 5% (●)

B328

+135°
-30°

PA6
+G.F.

UL94
HB

RoHS
COMPLIANT

CURVED SURFACE ADAPTOR FOR B324 "EUROMODEL" HANDLE WITH THROUGH HOLE

Materials:

Reinforced polyamide.
Resistant to oils and greases.

Surface finish:

Satin.

Colour:

Black (RAL 9011).

Hole:

Smooth through hole obtained by moulding the plastic.

Special requests:

- Upon request and for special quantities available in the colours indicated in the chart [page 807].

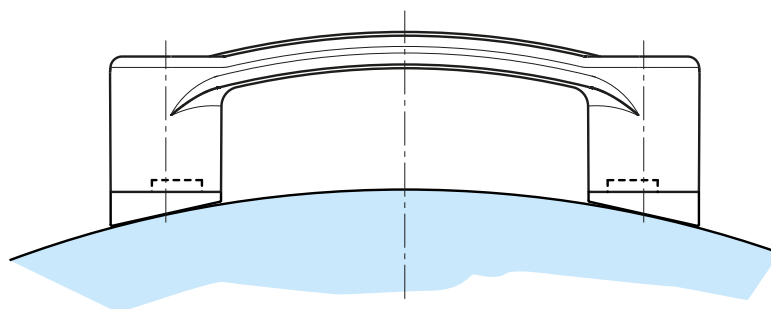
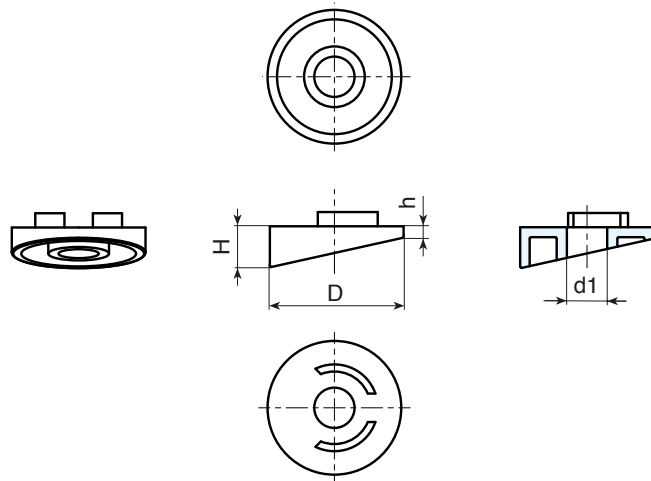

	art.	D	H	h	d1	g
●	B328120.TG08.501	28	9	3	6.5	3

B324

"EUROMODEL" HANDLE WITH THROUGH HOLE AND CAP



MODELLO DEPOSITATO

Materials:

Reinforced polyamide.
Resistant to oils and greases.

Surface finish:

Satin.

Colour:

Black (RAL 9011).

Standard cap:

Grey polyamide cap (RAL 7035 code 13).

Alternative cap colours:

Orange (RAL 2004 cod. 02).
Blue (RAL 5015 cod. 07).
Yellow (RAL 1021 cod. 10).
Red (RAL 3000 cod. 16).
Green (RAL 6024 cod. 17).
Black (RAL 9011 cod. 01).

Hole:

Smooth through hole obtained by moulding the plastic.

Special requests:

- Upon request and for special quantities available in the colours indicated in the chart [page 807].

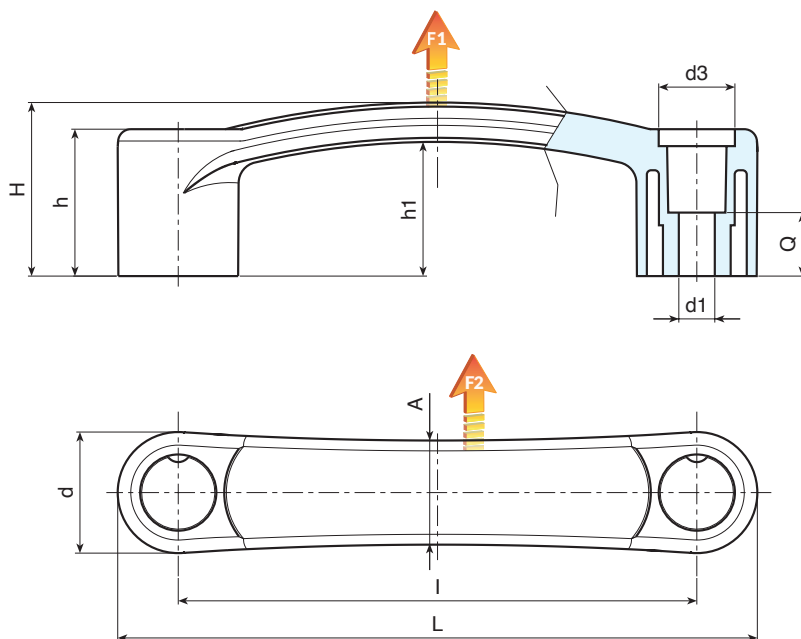

art.	L	l	H	h	h1	A	d	d3	Q	d1	g	F1 (N)	F2 (N)
● B324094.TG06.50113	118	94	37	33	30	21	24	16	14	6.5	37	2500	2000
● B324117.TG06.50113	145	117	40.5	34	31.5	24	28	18	15	6.5	58	3700	3500
● B324117.TG08.50113	145	117	40.5	34	31.5	24	28	18	15	8.5	57	3700	3500
● B324120.TG06.50113	148	120	40.5	34	31.5	24	28	18	15	6.5	60	2900	3500
● B324120.TG08.50113	148	120	40.5	34	31.5	24	28	18	15	8.5	59	2900	3500
● B324132.TG08.50113	160	132	43	36.5	34	24	28	18	15	8.5	91	3200	3200

B326



“EUROMODEL” HANDLE WITH THREADED INSERT AND CAP

MODELLO DEPOSITATO

Materials:

Reinforced polyamide.
Resistant to oils and greases.

Surface finish:

Satin.

Colour:

Black (RAL 9011).

Standard cap:

Grey polyamide cap (RAL 7035 code 13).

Alternative cap colours:

Orange (RAL 2004 cod. 02).
Blue (RAL 5015 cod. 07).
Yellow (RAL 1021 cod. 10).
Red (RAL 3000 cod. 16).
Green (RAL 6024 cod. 17).
Black (RAL 9011 cod. 01).

Inserts:

Brass insert with female threaded hole (thread tolerance 6H).

Special requests:

- Upon request and for special quantities available in the colours indicated in the chart [page 807].

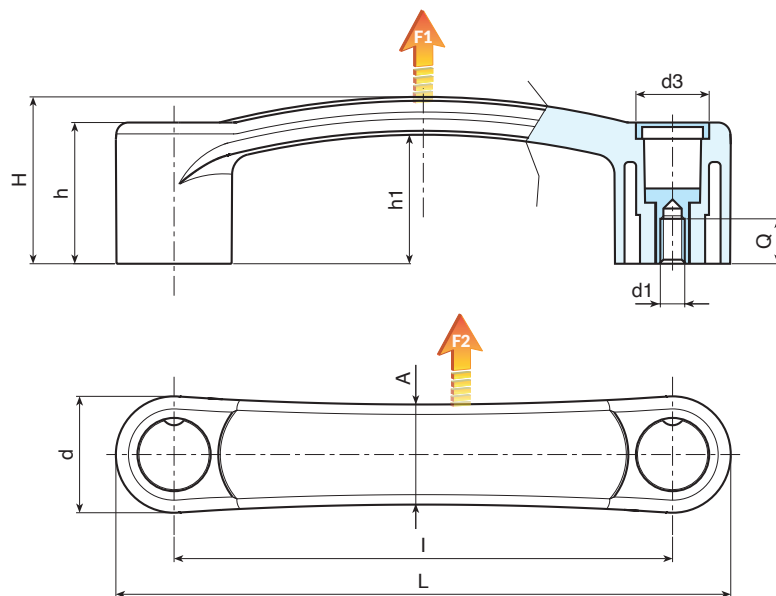

art.	L	l	H	h	h1	A	d	d3	Q	d16H	g	F1 (N)	F2 (N)
B326094.TM050113	118	94	37	33	30	21	24	16	12	M5	42	2000	2000
B326094.TM060113	118	94	37	33	30	21	24	16	12	M6	43	2000	2000
B326117.TM050113	145	117	40.5	34	31.5	24	28	18	12	M5	68	3400	2900
B326117.TM060113	145	117	40.5	34	31.5	24	28	18	12	M6	67	3400	2900
B326117.TM080113	145	117	40.5	34	31.5	24	28	18	12	M8	65	3400	2900
B326120.TM050113	148	120	40.5	34	31.5	24	28	18	12	M5	70	3500	1700
B326120.TM060113	148	120	40.5	34	31.5	24	28	18	12	M6	69	3500	1700
B326120.TM080113	148	120	40.5	34	31.5	24	28	18	12	M8	67	3500	1700
B326132.TM080113	160	132	43	36.5	34	24	28	18	12	M8	77	3500	2900

B321-B331

BRACKET FOR HANDLE WITH TUBE



Materials:

Reinforced polyamide.
Resistant to oils and greases.

Surface finish:

Satin.

Colour:

Black (RAL 9011).

Hole:

Smooth through hole obtained by moulding the plastic.

Special Requests:

- Upon request screw/hole caps are available.
- Upon request and for special quantities available in the colours indicated in the chart [on page 807].

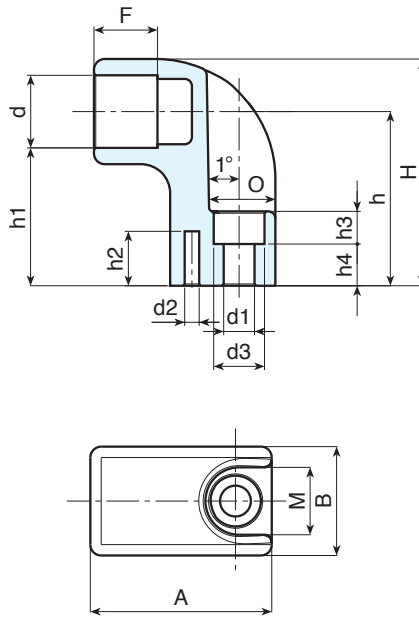

B321 - Bracket for handle with tube D. 20

art.	d	d1	d3	d2	A	B	H	h	h1	h4	h3	h2	M	O	F	g
B321.TG2001	20	8.5	14.5	4	50	30	57	43	33	7	12.5	15	18.5	18	17	47

B331 - Bracket for handle with tube D. 30

art.	d	d1	d3	d2	A	B	H	h	h1	h4	h3	h2	M	O	F	g
B331.TG3001	30	10.5	16	4	60	40	77	58	43	12	15	19	23	22	21	92



B320

HANDLE WITH TUBE D.20



Materials:

Plastic end:

Reinforced polyamide. Resistant to oils and greases.

Tube:

Aluminum alloy 6060.

Surface finish:

Plastic end: Satin.

Tube: Smooth.

Colour:

Plastic end:

Black (Ral 9011).

Tube:

Version B320-99: Anodised silver.

Version B320-98: Marbled black epoxy powder coating.

Hole:

Smooth through hole obtained by moulding the plastic.

Special requests:

- Upon request and for special quantities the handle can be supplied with custom length.
- Upon request screw caps are available.
- Upon request and for special quantities available in the colours indicated in the chart [page 807].

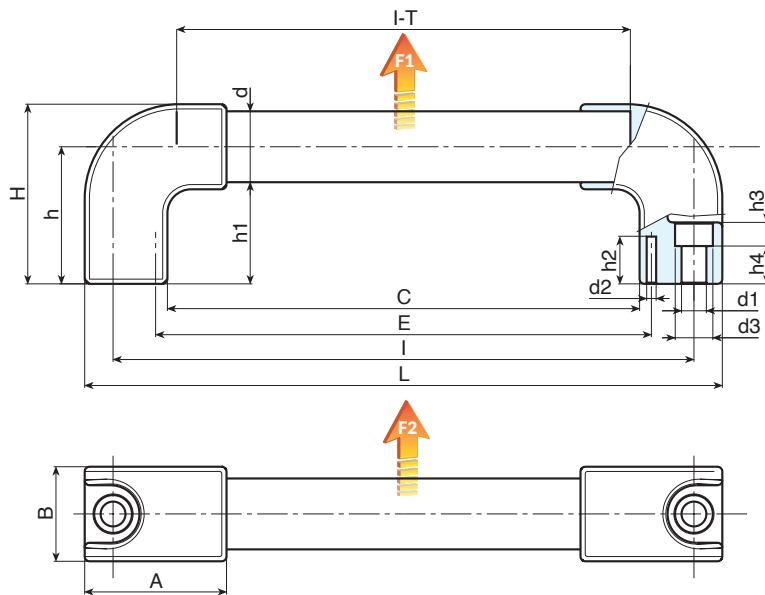

Version B320-99: tube colour anodised silver

art.	L	I	C	E	A	B	T	H	h	h1	h4	h3	h2	d	d3	d2	d1	g	F1 (kN)	F2 (kN)
B320200.TG2099	220	200	162	174	50	30	45	57	43	33	7	12.5	15	20	14.5	4	8.5	130	2,4	1,85
B320250.TG2099	270	250	212	224	50	30	45	57	43	33	7	12.5	15	20	14.5	4	8.5	145	1,8	1,45
B320300.TG2099	320	300	262	274	50	30	45	57	43	33	7	12.5	15	20	14.5	4	8.5	155	1,5	1,5
B320350.TG2099	370	350	312	324	50	30	45	57	43	33	7	12.5	15	20	14.5	4	8.5	165	1,5	1,25
B320400.TG2099	420	400	362	374	50	30	45	57	43	33	7	12.5	15	20	14.5	4	8.5	176	1,4	0,85
B320500.TG2099	520	500	462	474	50	30	45	57	43	33	7	12.5	15	20	14.5	4	8.5	200	1	0,8
B320600.TG2099	620	600	562	574	50	30	45	57	43	33	7	12.5	15	20	14.5	4	8.5	225	0,9	0,75
B320700.TG2099	720	700	662	674	50	30	45	57	43	33	7	12.5	15	20	14.5	4	8.5	250	0,6	0,6

Version B320-98: tube colour marbled black.

art.	L	I	C	E	A	B	T	H	h	h1	h4	h3	h2	d	d3	d2	d1	g	F1 (kN)	F2 (kN)
B320200.TG2098	220	200	162	174	50	30	45	57	43	33	7	12.5	15	20	14.5	4	8.5	130	2,4	1,85
B320250.TG2098	270	250	212	224	50	30	45	57	43	33	7	12.5	15	20	14.5	4	8.5	145	1,8	1,45
B320300.TG2098	320	300	262	274	50	30	45	57	43	33	7	12.5	15	20	14.5	4	8.5	155	1,5	1,5
B320350.TG2098	370	350	312	324	50	30	45	57	43	33	7	12.5	15	20	14.5	4	8.5	165	1,5	1,25
B320400.TG2098	420	400	362	374	50	30	45	57	43	33	7	12.5	15	20	14.5	4	8.5	176	1,4	0,85
B320500.TG2098	520	500	462	474	50	30	45	57	43	33	7	12.5	15	20	14.5	4	8.5	200	1	0,8
B320600.TG2098	620	600	562	574	50	30	45	57	43	33	7	12.5	15	20	14.5	4	8.5	225	0,9	0,75
B320700.TG2098	720	700	662	674	50	30	45	57	43	33	7	12.5	15	20	14.5	4	8.5	250	0,6	0,6



Stock availability as % (🛒)
90% (●) - 40% (●) - 5% (●)

B330

HANDLE WITH TUBE D.30



Materials:

Plastic end:

Reinforced polyamide. Resistant to oils and greases.

Tube:

Aluminum alloy 6060.

Surface finish:

Plastic end: Satin.

Tube: Smooth.

Colour:

Plastic end:

Black (Ral 9011).

Tube:

Version B330-99: Anodised silver.

Version B330-98: Marbled black epoxy powder coating.

Hole:

Smooth through hole obtained by moulding the plastic.

Special requests:

- Upon request and for special quantities the handle can be supplied with custom length.
- Upon request screw caps are available.
- Upon request and for special quantities available in the colours indicated in the chart [page 807].

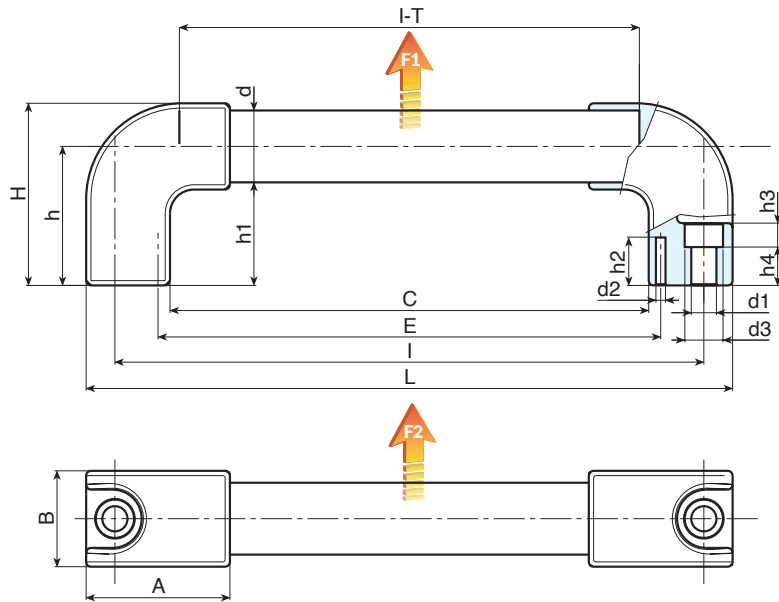
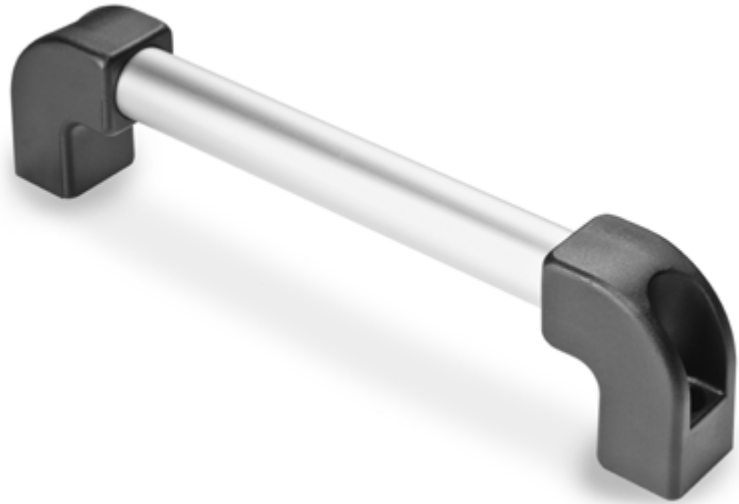

Version B330-99: with tube colour anodised silver

art.	L	I	C	E	A	B	T	H	h	h1	h4	h3	h2	d	d3	d2	d1	g	F1 (kN)	F2 (kN)
B330200.TG3099	224	200	154	164	60	40	54	77	58	43	12	15	19	30	16	4	10.5	235	3,4	2,9
B330250.TG3099	274	250	204	214	60	40	54	77	58	43	12	15	19	30	16	4	10.5	250	3,8	3,2
B330300.TG3099	324	300	254	264	60	40	54	77	58	43	12	15	19	30	16	4	10.5	270	3,2	2,9
B330350.TG3099	374	350	304	314	60	40	54	77	58	43	12	15	19	30	16	4	10.5	285	2,7	2,4
B330400.TG3099	424	400	354	364	60	40	54	77	58	43	12	15	19	30	16	4	10.5	305	2,4	2,2
B330500.TG3099	524	500	454	464	60	40	54	77	58	43	12	15	19	30	16	4	10.5	340	1,9	1,7
B330600.TG3099	624	600	554	564	60	40	54	77	58	43	12	15	19	30	16	4	10.5	370	1,6	1,4
B330700.TG3099	724	700	654	664	60	40	54	77	58	43	12	15	19	30	16	4	10.5	405	1,4	1,25

Version B330-98: with tube colour marbled black.

art.	L	I	C	E	A	B	T	H	h	h1	h4	h3	h2	d	d3	d2	d1	g	F1 (kN)	F2 (kN)
B330200.TG3098	224	200	154	164	60	40	54	77	58	43	12	15	19	30	16	4	10.5	235	3,4	2,9
B330250.TG3098	274	250	204	214	60	40	54	77	58	43	12	15	19	30	16	4	10.5	250	3,8	3,2
B330300.TG3098	324	300	254	264	60	40	54	77	58	43	12	15	19	30	16	4	10.5	270	3,2	2,9
B330350.TG3098	374	350	304	314	60	40	54	77	58	43	12	15	19	30	16	4	10.5	285	2,7	2,4
B330400.TG3098	424	400	354	364	60	40	54	77	58	43	12	15	19	30	16	4	10.5	305	2,4	2,2
B330500.TG3098	524	500	454	464	60	40	54	77	58	43	12	15	19	30	16	4	10.5	340	1,9	1,7
B330600.TG3098	624	600	554	564	60	40	54	77	58	43	12	15	19	30	16	4	10.5	370	1,6	1,4
B330700.TG3098	724	700	654	664	60	40	54	77	58	43	12	15	19	30	16	4	10.5	405	1,4	1,25



Stock availability as % (🛒)
90% (●) - 40% (●) - 5% (●)

B330CIN

HANDLE WITH STAINLESS STEEL TUBE D. 30



INOX

Materials:

Plastic end:

Reinforced polyamide. Resistant to oils and greases.

Tube:

Stainless steel (Aisi 304).

Surface finish:

Plastic end:

Satin.

Tube:

Natural Smooth.

Colour:

Plastic end:

Black (Ral 9011).

Tube:

Natural.

Hole:

Smooth through hole obtained by moulding the plastic.

Special requests:

- Upon request and for special quantities the handle can be supplied with custom length.
- Upon request screw caps are available.
- Upon request and for special quantities available in the colours indicated in the chart [page 807].

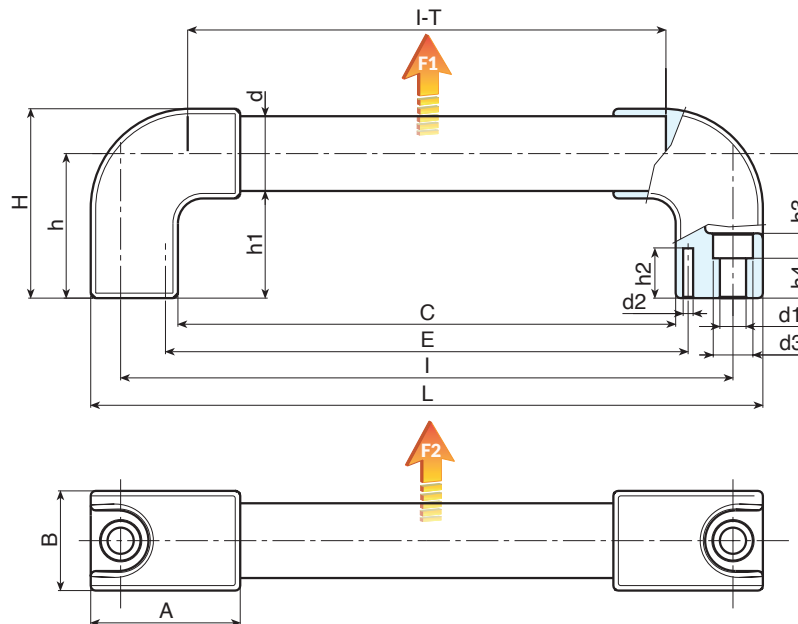

INOX

art.	L	I	C	E	A	B	T	H	h	h1	h4	h3	h2	d	d3	d2	d1	F1 (kN)	F2 (kN)	
B330200.TG3001CIN	224	200	154	164	60	40	54	77	58	43	16	11	19	30	16	4	10.5	235	3,4	2,9
B330250.TG3001CIN	274	250	204	214	60	40	54	77	58	43	16	11	19	30	16	4	10.5	250	3,8	3,2
B330300.TG3001CIN	324	300	254	264	60	40	54	77	58	43	16	11	19	30	16	4	10.5	270	3,2	2,9
B330350.TG3001CIN	374	350	304	314	60	40	54	77	58	43	16	11	19	30	16	4	10.5	285	2,7	2,4
B330400.TG3001CIN	424	400	354	364	60	40	54	77	58	43	16	11	19	30	16	4	10.5	305	2,4	2,2
B330500.TG3001CIN	524	500	454	464	60	40	54	77	58	43	16	11	19	30	16	4	10.5	340	1,9	1,7
B330600.TG3001CIN	624	600	554	564	60	40	54	77	58	43	16	11	19	30	16	4	10.5	370	1,6	1,4
B330700.TG3001CIN	724	700	654	664	60	40	54	77	58	43	16	11	19	30	16	4	10.5	405	1,4	1,25



Stock availability as % (🛒)
 90% (●) - 40% (●) - 5% (●)

B350CIN

+135°
-30°

PA6
+G.F.

UL94
HB

RoHS
COMPLIANT

HANDLE WITH STAINLESS STEEL TUBE D. 30 AND VERTICAL ENDS

INOX

Materials:

- (1) Reinforced polyamide bracket for tube. Resistant to oils and greases.
- (2) Stainless steel tube (Aisi 304).
- (3) Turned round aluminium insert with threaded hole M08 for fastening hexagonal socket head cap screws.
- (4) Stainless steel hexagonal socket head cap screw Aisi 304 M08x70 (DIN 912).
- (5) Winged snap-fit LDPE cap for tubes.

Surface finish:

- (1-5) Satin.
- (2) Glossy natural.

Colour:

- (1-5) Black (RAL 9011).
- (2) Natural steel.

ATTENTION:

The handle is supplied disassembled, in single packs.

Special requests:

- None.

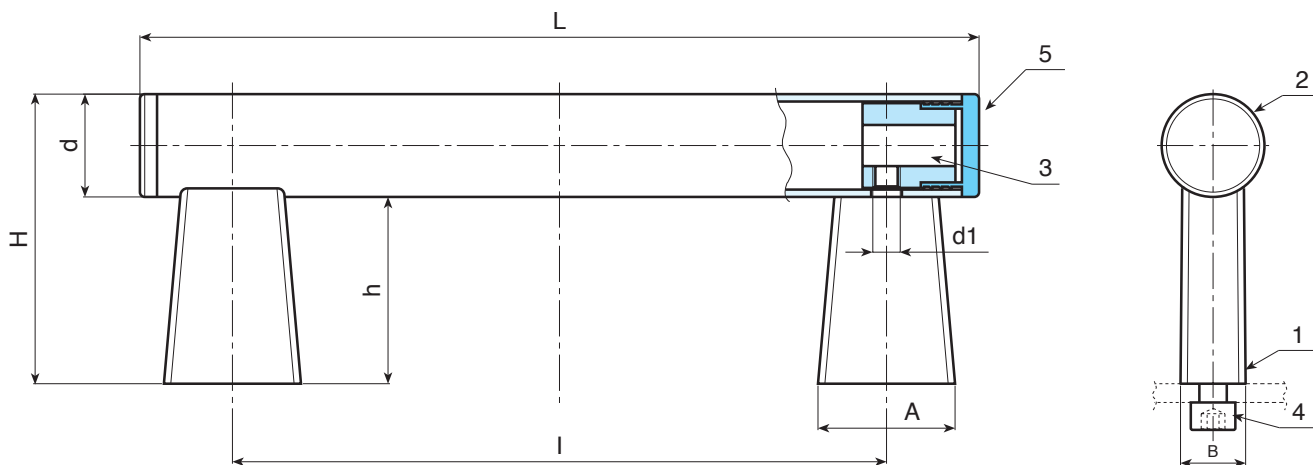

INOX

art.	L	I	D	H	h	A	B	d1	g
● B350150.TG3001CIN	206	150	30	85	55	40	19	M8	395
● B350200.TG3001CIN	256	200	30	85	55	40	19	M8	447
● B350250.TG3001CIN	306	250	30	85	55	40	19	M8	500
● B350300.TG3001CIN	356	300	30	85	55	40	19	M8	550
● B350350.TG3001CIN	406	350	30	85	55	40	19	M8	602
● B350400.TG3001CIN	456	400	30	85	55	40	19	M8	654
● B350500.TG3001CIN	556	500	30	85	55	40	19	M8	756
● B350600.TG3001CIN	656	600	30	85	55	40	19	M8	862
● B350700.TG3001CIN	756	700	30	85	55	40	19	M8	966

B350



PA6
+G.F.

UL94
HB

RoHS
COMPLIANT

HANDLE WITH TUBE D. 30 AND VERTICAL ENDS

Materials:

- (1) Reinforced polyamide bracket for tube. Resistant to oils and greases.
- (2) Anodised aluminium alloy 6060 tube.
- (3) Turned round aluminium insert with threaded hole M08 for fastening hexagonal socket head cap screws.
- (4) Black oxide treated hexagonal socket head cap screw M08x70 (DIN 912).
- (5) Winged snap-fit LDPE cap for tubes.

Surface finish:

- (1-5) Satin.
- (2) Glossy anodised.

Colour:

- (1-5) Black (RAL 9011).

Tube:

- Version B350-99: (2) Silver anodised.
Version B350-98: (2) Marbled black epoxy powder coating.

ATTENTION:

The handle is supplied disassembled, in single packs.

Special requests:

- None.

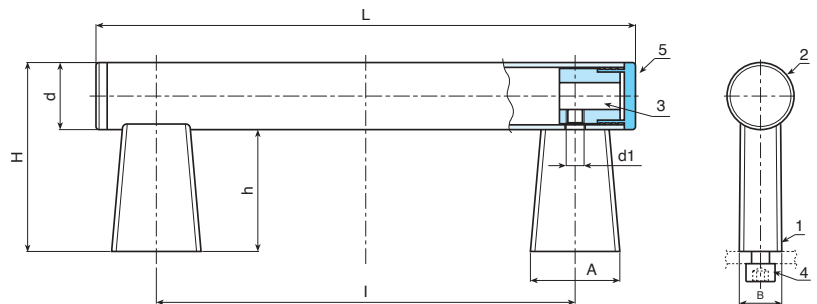

Version B350-99: with tube colour anodised silver

art.	L	l	D	H	h	A	B	d1	g
B350150.TG300199	206	150	30	85	55	40	19	M8	270
B350200.TG300199	256	200	30	85	55	40	19	M8	290
B350250.TG300199	306	250	30	85	55	40	19	M8	309
B350300.TG300199	356	300	30	85	55	40	19	M8	327
B350350.TG300199	406	350	30	85	55	40	19	M8	345
B350400.TG300199	456	400	30	85	55	40	19	M8	363
B350500.TG300199	556	500	30	85	55	40	19	M8	400
B350600.TG300199	656	600	30	85	55	40	19	M8	436
B350700.TG300199	756	700	30	85	55	40	19	M8	473

Version B350-98: with tube colour marbled black

art.	L	l	D	H	h	A	B	d1	g
B350150.TG300198	206	150	30	85	55	40	19	M8	270
B350200.TG300198	256	200	30	85	55	40	19	M8	290
B350250.TG300198	306	250	30	85	55	40	19	M8	309
B350300.TG300198	356	300	30	85	55	40	19	M8	327
B350350.TG300198	406	350	30	85	55	40	19	M8	345
B350400.TG300198	456	400	30	85	55	40	19	M8	363
B350500.TG300198	556	500	30	85	55	40	19	M8	400
B350600.TG300198	656	600	30	85	55	40	19	M8	436
B350700.TG300198	756	700	30	85	55	40	19	M8	473

B340

HANDLE WITH CURVED LATERAL TUBE D. 20



Materials:

Plastic end:

Reinforced polyamide. Resistant to oils and greases.

Tube:

Aluminum alloy 6060.

Surface finishes:

Plastic end:

Satin.

Tube:

Smooth.

Colour:

Plastic end:

Black (Ral 9011).

Tube:

Epoxy powder coating.

Version B340-97: Silver (Ral 9007 code 97).

Version B340-98: Marbled black (code 98).

Hole:

Smooth through hole obtained by moulding the plastic.

Fixing method:

The tube is fixed to the plastic ends by means of a spring pin (3) in harmonic steel d.6x27, inserted in the lower part of the end.

Special requests:

- Upon request and for special quantities the handle can be supplied with custom length.
- Upon request screw caps are available.
- Upon request and for special quantities available in the colours indicated in the chart [page 807].

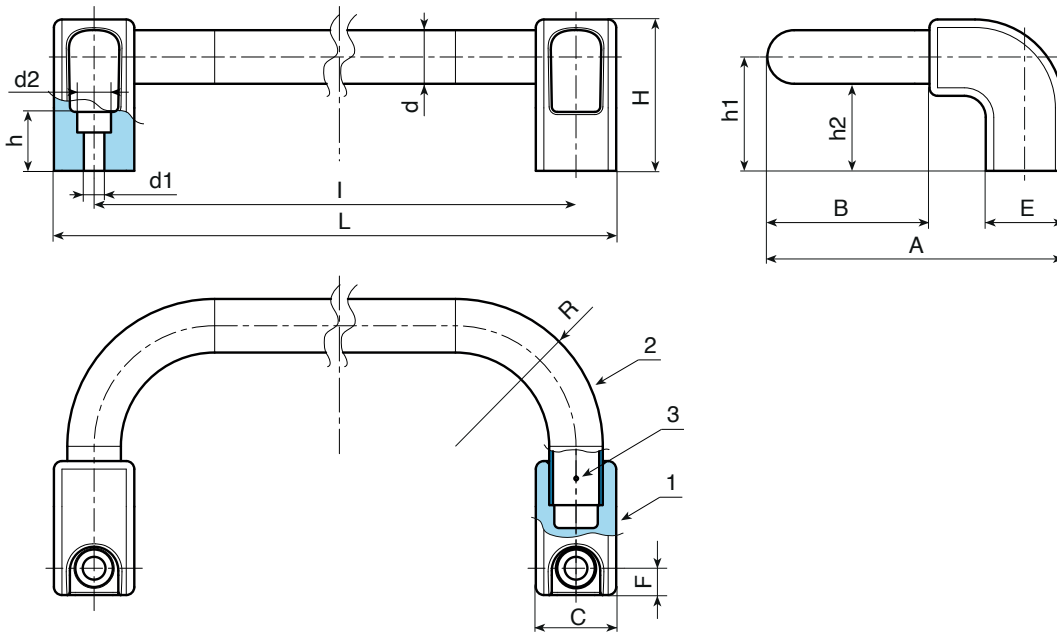

B340 - Silver painted version code 97

art.	l	L	d	d2	A	B	C	E	F	H	h	h1	h2	R	d1	g
B340200.TG200197	200	230	20	14.5	110.5	60.5	30	29	10	57	19.5	42.5	32.5	55	8.5	158
B340300.TG200197	300	330	20	14.5	110.5	60.5	30	29	10	57	19.5	42.5	32.5	55	8.5	183
B340500.TG200197	500	530	20	14.5	110.5	60.5	30	29	10	57	19.5	42.5	32.5	55	8.5	226

B340 - Black marbled painted version code 98

art.	L	l	d	d2	A	B	C	E	F	H	h	h1	h2	R	d1	g
B340200.TG200198	230	200	20	14.5	110.5	60.5	30	29	10	57	19.5	42.5	32.5	55	8.5	158
B340300.TG200198	330	300	20	14.5	110.5	60.5	30	29	10	57	19.5	42.5	32.5	55	8.5	183
B340500.TG200198	530	500	20	14.5	110.5	60.5	30	29	10	57	19.5	42.5	32.5	55	8.5	226



Stock availability as % (🛒)
90% (●) - 40% (●) - 5% (●)

B400

ALUMINUM OVAL HANDLE



Materials:

Handle in aluminium alloy 6060.

Surface finish:

Sandblasted satin finish.

Colour:

Version B400-01:

Black epoxy powder coating.

Version B400-99:

Natural anodised silver.

Special requests:

- None.

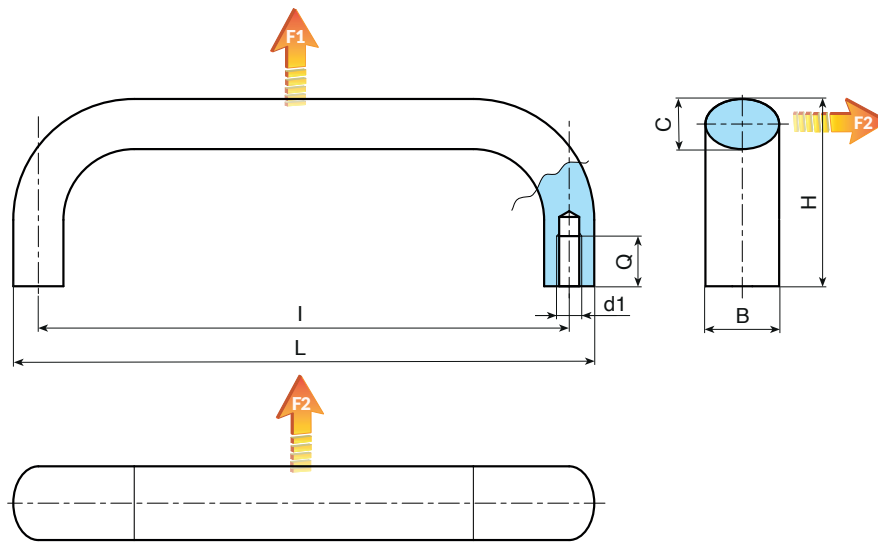

B400 - Black coated version - code 01

art.	L	I	H	B	C	Q	d1	g	F1	F2
B400100.A20M0601	113	100	50	20	13	12	M6	89	1000	1000
B400120.A20M0601	133	120	50	20	13	12	M6	98	1000	1000
B400128.A20M0601	141	128	50	20	13	12	M6	105	1000	1000
B400160.A20M0601	173	160	50	20	13	12	M6	122	1000	1000
B400112.A26M0801	129	112	55	26	17	14	M8	167	1000	1000
B400120.A26M0801	137	120	55	26	17	14	M8	174	1000	1000
B400128.A26M0801	145	128	55	26	17	14	M8	182	1000	1000
B400160.A26M0801	177	160	55	26	17	14	M8	208	1000	1000
B400180.A26M0801	197	180	55	26	17	14	M8	232	1000	1000
B400192.A26M0801	209	192	55	26	17	14	M8	243	1000	1000

B400 - Natural silver version - code 99

art.	L	I	H	B	C	Q	d1	g	F1	F2
B400100.A20M0699	113	100	50	20	13	12	M6	89	1000	1000
B400120.A20M0699	133	120	50	20	13	12	M6	98	1000	1000
B400128.A20M0699	141	128	50	20	13	12	M6	105	1000	1000
B400160.A20M0699	173	160	50	20	13	12	M6	122	1000	1000
B400112.A26M0899	129	112	55	26	17	14	M8	167	1000	1000
B400120.A26M0899	137	120	55	26	17	14	M8	174	1000	1000
B400128.A26M0899	145	128	55	26	17	14	M8	182	1000	1000
B400160.A26M0899	177	160	55	26	17	14	M8	208	1000	1000
B400180.A26M0899	197	180	55	26	17	14	M8	232	1000	1000
B400192.A26M0899	209	192	55	26	17	14	M8	243	1000	1000

B405

ALUMINUM FLAT LARGE OVAL HANDLE



Materials:

Handle in aluminium alloy 6060.

Surface finish:

Sandblasted satin finish.

Colour:

Version B405-01:

Black epoxy powder coating.

Version B405-99:

Natural anodised silver.

Special requests:

- None.

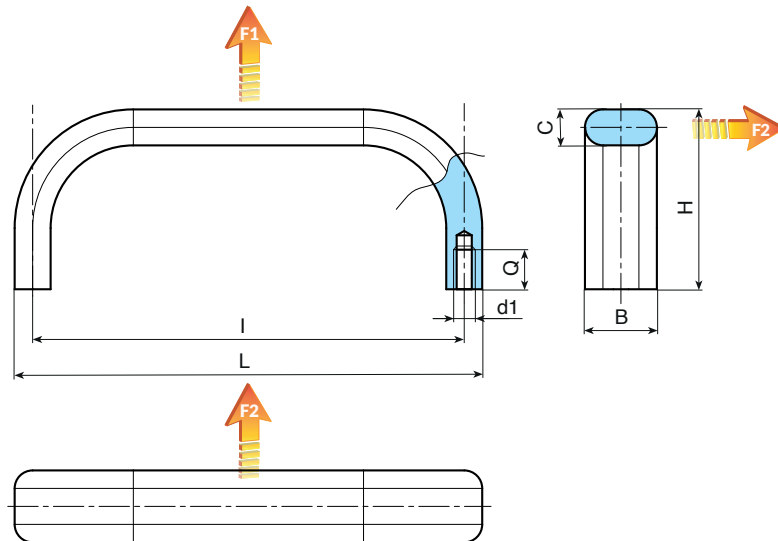

B405 - Black anodised version - code 01

art.	L	I	H	B	C	Q	d1	g	F1 (N)	F2 (N)
B405120.A20M0501	130	120	45	20	10	10	M5	85	500	500
B405180.A20M0501	190	180	45	20	10	10	M5	100	500	500
B405200.A20M0501	210	200	45	20	10	10	M5	120	500	500
B405350.A20M0601	360	350	45	20	10	12	M6	190	500	500

B405 - Natural silver version - code 99

art.	L	I	H	B	C	Q	d1	g	F1 (N)	F2 (N)
B405120.A20M0599	130	120	45	20	10	10	M5	85	500	500
B405180.A20M0599	190	180	45	20	10	10	M5	100	500	500
B405200.A20M0599	210	200	45	20	10	10	M5	120	500	500
B405350.A20M0699	360	350	45	20	10	12	M6	190	500	500

B408

ALUMINUM NARROW FLAT OVAL HANDLE



Materials:

Handle in aluminium alloy 6060.

Surface finish:

Sandblasted satin finish.

Colour:

Black epoxy powder coating.

Natural anodised silver.

Special requests:

- None.

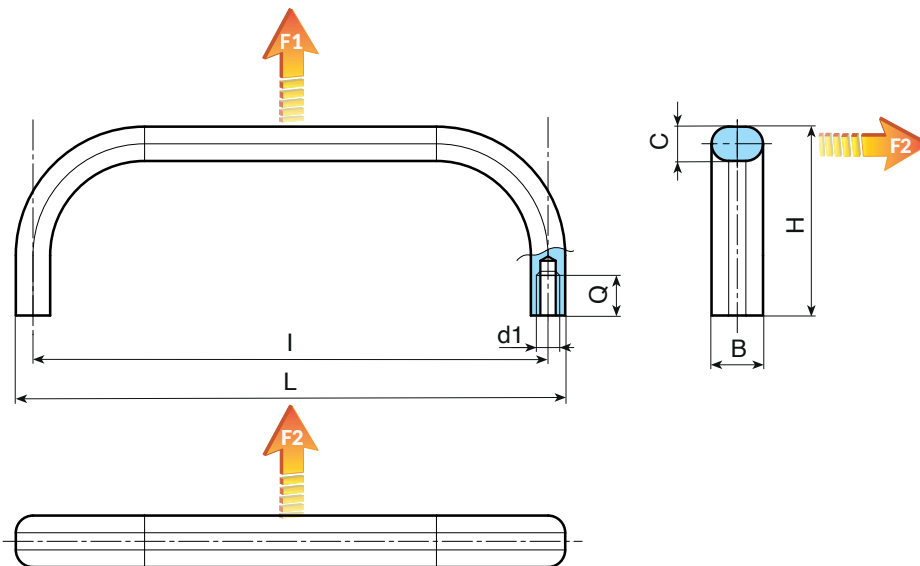

B408 - Black anodised version - code 01

art.	L	I	H	B	C	Q	d1	g	F1 (N)	F2 (N)
B408055.A12M0501	63	55	40	12	8	10	M5	24	500	500
B408088.A12M0501	96	88	40	12	8	10	M5	30	500	500
B408100.A12M0501	108	100	40	12	8	10	M5	32	500	500
B408120.A12M0501	128	120	40	12	8	10	M5	37	500	500
B408180.A12M0501	188	180	40	12	8	10	M5	50	500	500
B408200.A12M0501	208	200	40	12	8	10	M5	55	500	500
B408235.A12M0501	243	235	40	12	8	10	M5	64	500	500
B408250.A12M0501	258	250	40	12	8	10	M5	68	500	500

B408 - Natural silver anodised version - code 99

art.	L	I	H	B	C	Q	d1	g	F1 (N)	F2 (N)
B408055.A12M0599	63	55	40	12	8	10	M5	24	500	500
B408088.A12M0599	96	88	40	12	8	10	M5	30	500	500
B408100.A12M0599	108	100	40	12	8	10	M5	32	500	500
B408120.A12M0599	128	120	40	12	8	10	M5	37	500	500
B408180.A12M0599	188	180	40	12	8	10	M5	50	500	500
B408200.A12M0599	208	200	40	12	8	10	M5	55	500	500
B408235.A12M0599	243	235	40	12	8	10	M5	64	500	500
B408250.A12M0599	258	250	40	12	8	10	M5	68	500	500

B410

ALUMINUM ROUND HANDLE



Materials:

Handle in aluminium alloy 6060.

Surface finish:

Sandblasted satin finish.

Colour:

B410-01
Black epoxy powder coating.

B410-99
Natural anodised silver.

Special requests:

- Cylindrical aluminum base on request. Supplied disassembled.
- B411.A1601 colour black.
- B411.A1699 colour silver.

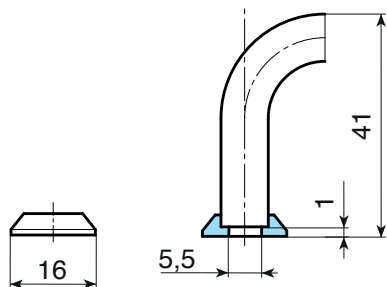

B411

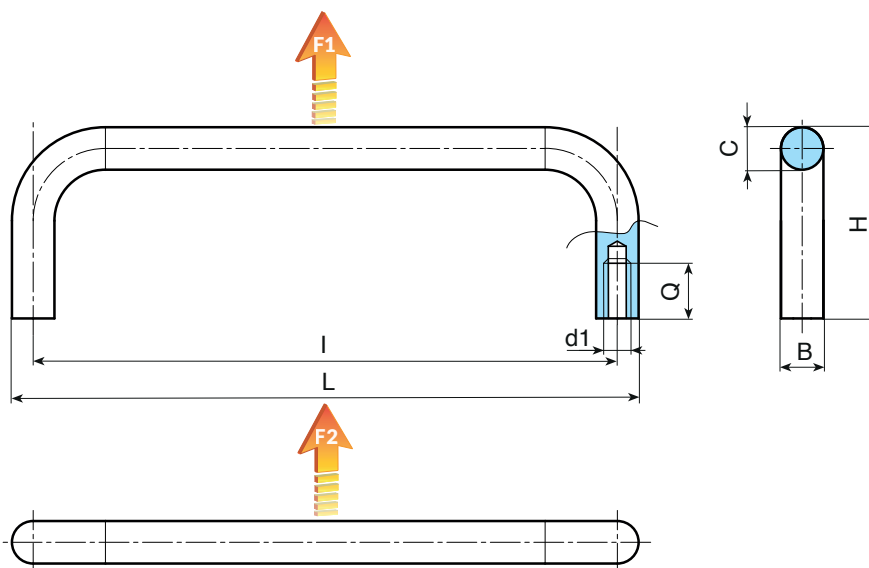

B410 - Black anodised version - code 01

art.	L	I	H	B/C	Q	d1	g	F1 (N)	F2 (N)
B410055.A10M0501	65	55	40	10	9	M5	22	500	500
B410088.A10M0501	98	88	40	10	9	M5	28	500	500
B410100.A10M0501	110	100	40	10	9	M5	31	500	500
B410120.A10M0501	130	120	40	10	9	M5	36	500	500
B410180.A10M0501	190	180	40	10	9	M5	48	500	500
B410200.A10M0501	210	200	40	10	9	M5	52	500	500
B410235.A10M0501	245	235	40	10	9	M5	62	500	500
B410250.A10M0501	260	250	40	10	9	M5	66	500	500

B410 - Silver anodised version - code 99

art.	L	I	H	B/C	Q	d1	g	F1 (N)	F2 (N)
B410055.A10M0599	65	55	40	10	9	M5	22	500	500
B410088.A10M0599	98	88	40	10	9	M5	28	500	500
B410100.A10M0599	110	100	40	10	9	M5	31	500	500
B410120.A10M0599	130	120	40	10	9	M5	36	500	500
B410180.A10M0599	190	180	40	10	9	M5	48	500	500
B410200.A10M0599	210	200	40	10	9	M5	52	500	500
B410235.A10M0599	245	235	40	10	9	M5	62	500	500
B410250.A10M0599	260	250	40	10	9	M5	66	500	500

B412

CHROME-PLATED STEEL ROUND HANDLE



Materials:

Free-cutting steel handle.

Surface finish:

Fine mirror polishing.

Colour:

Glossy chrome plating.

Special requests:

- None.

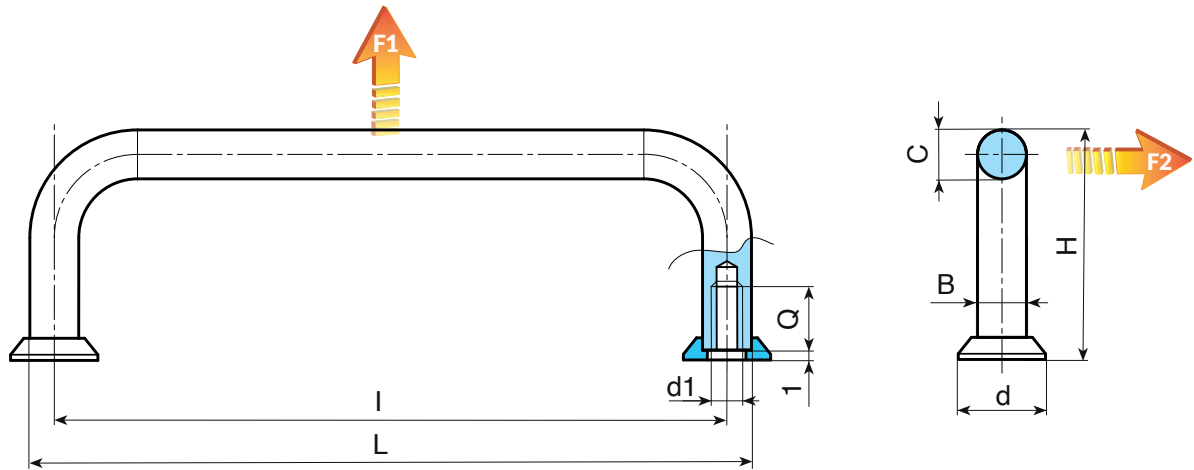

art.	L	I	H	B/C	d	Q	d1	g	F1 (N)	F2 (N)
B412032.R05M03	37	32	21	5	8	6	M3	8	1000	1000
B412042.R05M03	47	42	25	5	8	6	M3	10	1000	1000
B412055.R05M03	60	55	25	5	8	6	M3	13	1000	1000
B412076.R05M03	81	76	25	5	8	6	M3	15	1000	1000
B412088.R05M03	93	88	25	5	8	6	M3	18	1000	1000
B412032.R08M04	40	32	33	8	12.5	8	M4	28	1000	1000
B412055.R08M04	63	55	33	8	12.5	8	M4	38	1000	1000
B412064.R08M04	72	64	33	8	12.5	8	M4	41	1000	1000
B412088.R08M04	96	88	33	8	12.5	8	M4	50	1000	1000
B412096.R08M04	104	96	33	8	12.5	8	M4	56	1000	1000
B412098.R08M04	106	98	33	8	12.5	8	M4	57	1000	1000
B412102.R08M04	110	102	33	8	12.5	8	M4	58	1000	1000
B412120.R08M04	128	120	33	8	12.5	8	M4	65	1000	1000
B412128.R08M04	136	128	33	8	12.5	8	M4	68	1000	1000
B412136.R08M04	144	136	33	8	12.5	8	M4	71	1000	1000
B412055.R10M05	65	55	41	10	15	10	M5	67	1000	1000
B412088.R10M05	98	88	41	10	15	10	M5	87	1000	1000
B412100.R10M05	110	100	41	10	15	10	M5	94	1000	1000
B412102.R10M05	112	102	41	10	15	10	M5	95	1000	1000
B412115.R10M05	125	115	41	10	15	10	M5	103	1000	1000
B412120.R10M05	130	120	41	10	15	10	M5	105	1000	1000
B412136.R10M05	146	136	41	10	15	10	M5	112	1000	1000
B412180.R10M05	190	180	41	10	15	10	M5	142	1000	1000
B412200.R10M05	210	200	41	10	15	10	M5	154	1000	1000
B412235.R10M05	245	235	41	10	15	10	M5	175	1000	1000
B412250.R10M05	260	250	41	10	15	10	M5	184	1000	1000



THE **QUALITY**
IN YOUR HAND

www.boteco.com



BOTECO[®]
YOUR MECHANICAL COMPONENT