



BOTECO[®]

YOUR MECHANICAL COMPONENT

GROUP - I

**BALL, CONICAL AND MUSHROOM
KNOBS**



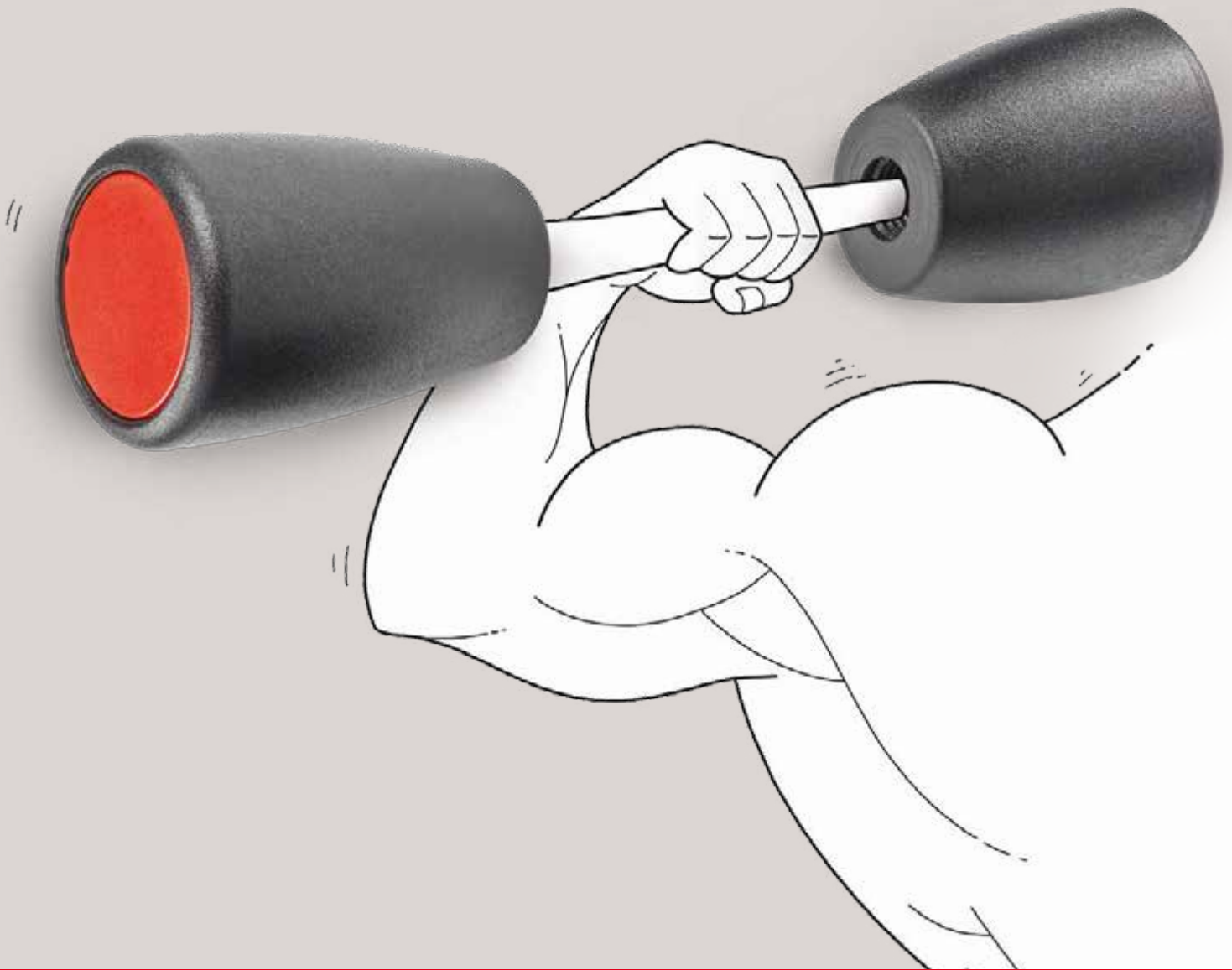

Strengthen *your image* by making
the **RIGHT CHOICES** every day.



BOTECO[®]

I101



BAKELITE BALL KNOB WITH THREADED HOLE INSERT

Materials:

Phenolic resin.
Resistant to oils and greases.
Resistant to high temperatures.

Surface finish:

Glossy.

Colour:

Black (RAL 9011).

Inserts:

Brass insert with female threaded hole (thread tolerance 6H).

Special requests:

- None.

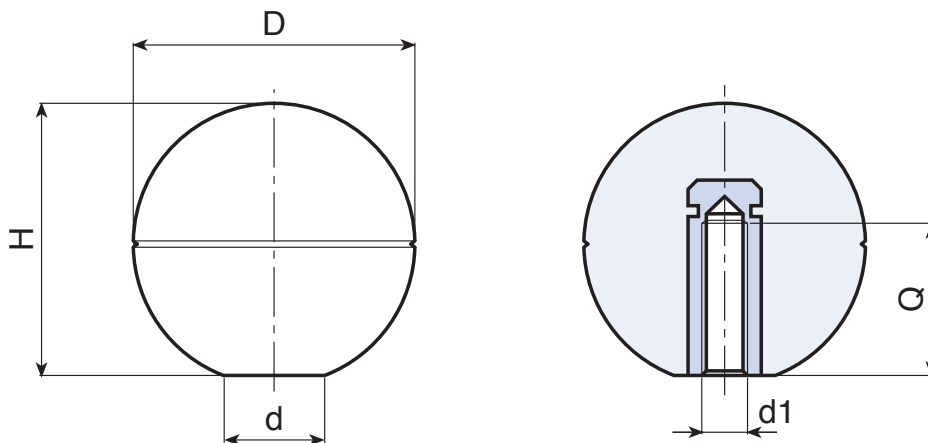

🛒	art.	D	H	d	d1 _{6H}	Q	📦
●	I10118.BM0401	18	17	8,5	M4	8	6
●	I10118.BM0501	18	17	8,5	M5	8	6
●	I10118.BM0601	18	17	8,5	M6	9	5
●	I10126.BM0601	26	24	12	M6	13	15
●	I10126.BM0801	26	24	12	M8	13,5	14
●	I10130.BM1001	30	28	15	M10	15	25
●	I10135.BM0801	35	32	14	M8	13,5	34
●	I10135.BM1001	35	32	14	M10	15	33
●	I10140.BM1001	40	37	21	M10	15	61
●	I10140.BM1201	40	37	21	M12	18	62

I103

BALL KNOB WITH PLASTIC THREADED HOLE



Materials:

Reinforced polyamide.
Resistant to oils and greases.

Surface finish:

Satin.

Colour:

Black (RAL 9011).

Hole:

Female threaded hole obtained by moulding the plastic (thread tolerance not applicable).

Special requests:

- Upon request and for special quantities available in the colours indicated in the chart (ATTENTION: reduced range for measures marked (*)) [page 807].

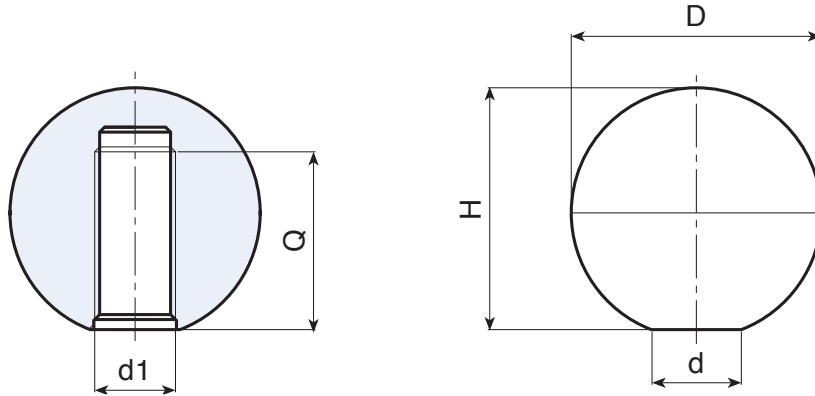

🛒	art.	D	H	d	d1	Q	📦
●	I10315.TM0401	15	14	9	M4	10	2
●	I10315.TM0501	15	14	9	M5	10	2
●	I10320.TM0401	20	19	10	M4	14	6
●	I10320.TM0501	20	19	10	M5	14	6
●	I10320.TM0601	20	19	10	M6	14	6
●	I10320.TM0801	20	19	10	M8	14	6
●	I10325.TM0501	25	23	14	M5	18	10
●	I10325.TM0601	25	23	14	M6	18	10
●	I10325.TM0801	25	23	14	M8	18	10
●	I10325.TM1001	25	23	14	M10	18	8
●	I10330.TM0501	30	29	14	M5	22	18
●	I10330.TM0601	30	29	14	M6	22	18
●	I10330.TM0801	30	29	14	M8	22	16
●	I10330.TM1001	30	29	14	M10	22	16
●	I10330.TM1201	30	29	14	M12	22	14
●	I10335.TM0601	35	33	16	(*)M6	25	28
●	I10335.TM0801	35	33	16	(*)M8	25	26
●	I10335.TM1001	35	33	16	(*)M10	25	26
●	I10335.TM1201	35	33	16	-	18	32
●	I10340.TM0801	40	39	16	(*)M8	25	42
●	I10340.TM1001	40	39	16	(*)M10	25	36
●	I10340.TM1201	40	39	16	(*)M12	25	36
●	I10340.TM1401	40	39	16	(*)M14	25	34
●	I10345.TM0801	45	44	18	(*)M8	25	60
●	I10345.TM1001	45	44	18	(*)M10	25	58
●	I10345.TM1201	45	44	18	(*)M12	25	58
●	I10345.TM1401	45	44	18	(*)M14	25	56
●	I10350.TM1001	50	49	18	(*)M10	25	80
●	I10350.TM1201	50	49	18	(*)M12	25	78
●	I10350.TM1401	50	49	18	(*)M14	25	76
●	I10350.TM1601	50	49	18	(*)M16	25	73

I104

PUSH-FIT BALL KNOB WITH HOLE



Materials:

Reinforced polyamide.
Resistant to oils and greases.

Surface finish:

Satin.

Colour:

Black (RAL 9011).

Hole:

Blind smooth bore, with deformable fixing ribs, obtained by moulding the plastic.

Fixing method:

Push-fit.

Special requests:

- Upon request and for special quantities available in the colours indicated in the chart (ATTENTION: reduced range for measures marked (*)) [page 807].

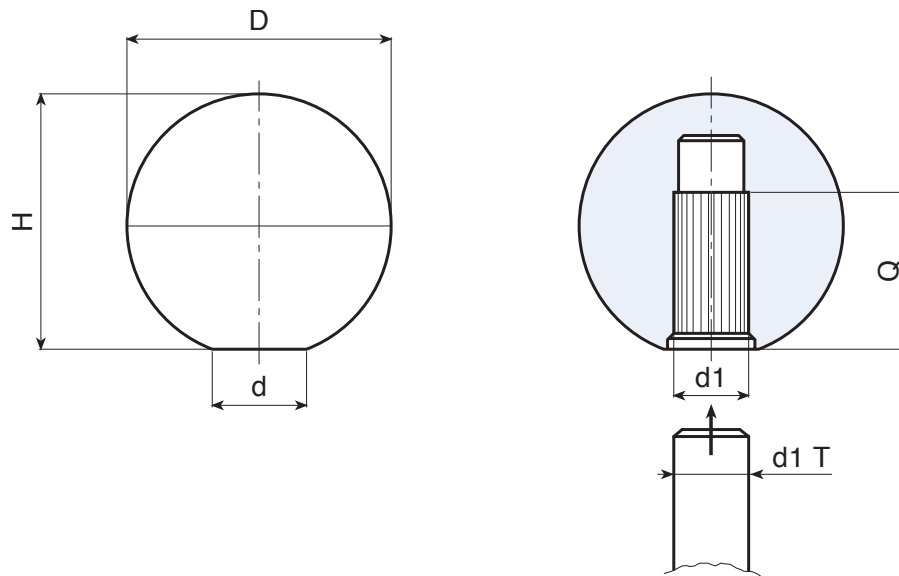

art.	D	H	d	d1 T	d1	Q	g
I10420.TG0501	20	19	10	+0 -0,048	5	12	4
I10420.TG0601	20	19	10	+0 -0,048	6	12	4
I10425.TG0601	25	23	14	+0 -0,048	6	16	10
I10425.TG0801	25	23	14	+0 -0,058	8	16	10
I10430.TG0801	30	29	14	+0 -0,058	8	17	16
I10430.TG1001	30	29	14	+0 -0,058	10	17	16
I10435.TG0801	35	33	16	+0 -0,058	(*) 08	20	26
I10435.TG1001	35	33	16	+0 -0,058	(*) 10	20	26
I10440.TG1001	40	39	16	+0 -0,058	(*) 10	25	42
I10440.TG1201	40	39	16	+0 -0,070	(*) 12	25	38
I10445.TG1001	45	44	18	+0 -0,058	(*) 10	25	58
I10445.TG1201	45	44	18	+0 -0,070	(*) 12	25	58
I10445.TG1401	45	44	18	+0 -0,070	(*) 14	25	56
I10450.TG1001	50	49	18	+0 -0,058	(*) 10	25	80
I10450.TG1201	50	49	18	+0 -0,070	(*) 12	25	78
I10450.TG1401	50	49	18	+0 -0,070	(*) 14	25	76

I105

BALL KNOB WITH THREADED HOLE INSERT



Materials:

Reinforced polyamide.
Resistant to oils and greases.

Surface finish:

Satin.

Colour:

Black (RAL 9011).

Inserts:

Brass insert with female threaded hole (thread tolerance 6H).

Special requests:

- Upon request and for special quantities inserts can be supplied in different materials.
- Upon request and for special quantities available in the colours indicated in the chart (ATTENTION: reduced range for measures marked (*)) [page 807].

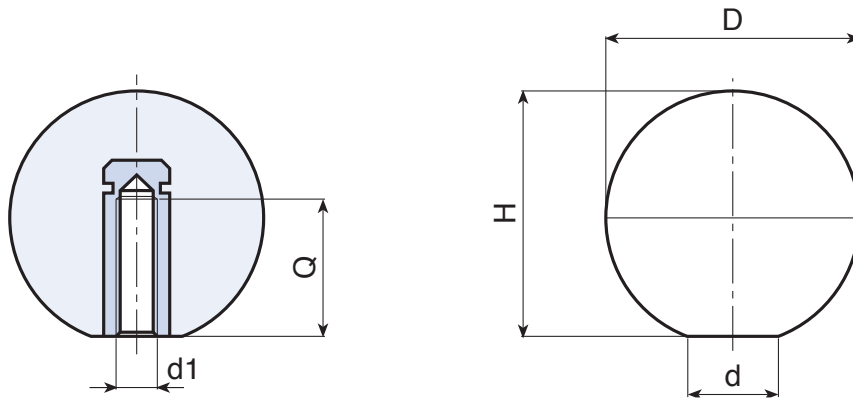

art.	D	H	d	d1 _{6H}	Q	g
I10515.TM0401	15	14	8	M4	8	4
I10515.TM0501	15	14	8	M5	7	4
I10520.TM0401	20	19	10	M4	8	8
I10520.TM0501	20	19	10	M5	7	8
I10520.TM0601	20	19	10	M6	7	8
I10520.TM0801	20	19	10	M8	7	8
I10525.TM0501	25	23	14	M5	10	12
I10525.TM0601	25	23	14	M6	10	12
I10525.TM0801	25	23	14	M8	11	14
I10525.TM1001	25	23	14	M10	14	12
I10530.TM0501	30	29	14	M5	15	22
I10530.TM0601	30	29	14	M6	16	22
I10530.TM0801	30	29	14	M8	14	22
I10530.TM1001	30	29	14	M10	14	22
I10530.TM1201	30	29	14	M12	18	26
I10535.TM0601	35	33	16	(*)M6	16	34
I10535.TM0801	35	33	16	(*)M8	14	34
I10535.TM1001	35	33	16	(*)M10	14	34
I10335.TM1201	35	33	16	(*)M12	18	32
I10540.TM0801	40	39	16	(*)M8	14	52
I10540.TM1001	40	39	16	(*)M10	14	52
I10540.TM1201	40	39	16	(*)M12	18	52
I10540.TM1401	40	39	16	(*)M14	19	50
I10545.TM0801	45	44	18	(*)M8	14	60
I10545.TM1001	45	44	18	(*)M10	18	60
I10545.TM1201	45	44	18	(*)M12	18	58
I10545.TM1401	45	44	18	(*)M14	19	56
I10550.TM1001	50	49	18	(*)M10	18	94
I10550.TM1201	50	49	18	(*)M12	18	92
I10550.TM1401	50	49	18	(*)M14	19	90

I107



PA6
+G.F.

UL94
HB



CONICAL KNOB WITH THREADED HOLE INSERT

Materials:

Reinforced polyamide.
Resistant to oils and greases.

Surface finish:

Satin.

Colour:

Black (RAL 9011).

Inserts:

I107:

Brass insert with female threaded hole (thread tolerance 6H).

I107CIN:

Stainless steel insert with female threaded hole (Aisi 303) (thread tolerance 6H).

Special requests:

- Upon request and for special quantities available in the colours indicated in the chart (ATTENTION: reduced range for measures marked (*)) [page 807].

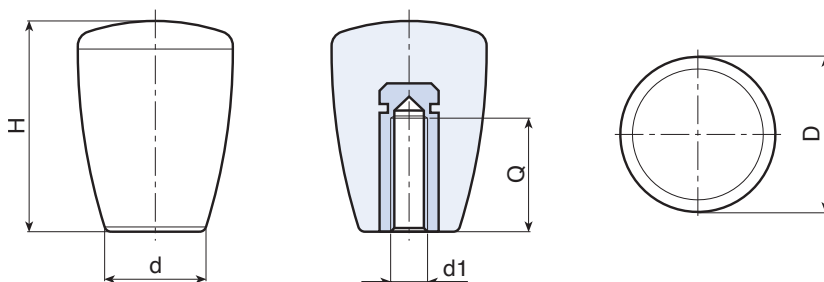

Version I107: with brass insert.

art.	D	H	d	d1 _{6H}	Q	g
I10721.TM0401	21	28	13	M4	10	14
I10721.TM0501	21	28	13	M5	10	13
I10721.TM0601	21	28	13	M6	10	13
I10725.TM0601	25	34	17	M6	10	18
I10725.TM0801	25	34	17	M8	13	20
I10725.TM1001	25	34	17	M10	14	22
I10732.TM0801	32	43	21	M8	14	40
I10732.TM1001	32	43	21	M10	14	40
I10732.TM1201	32	43	21	M12	18	44
I10743.TM1001	43	58	27	(*) M10	18	90
I10743.TM1201	43	58	27	(*) M12	18	90
I10743.TM1401	43	58	27	(*) M14	19	92

Version I107CIN: with stainless steel insert (Aisi 303).

art.	D	H	d	d1 _{6H}	Q	g
I10721.TM0501CIN	21	28	13	M5	15	16
I10725.TM0601CIN	25	34	17	M6	16	20
I10725.TM0801CIN	25	34	17	M8	16	22
I10725.TM1001CIN	25	34	17	M10	16	25
I10732.TM0801CIN	32	43	21	M8	16	43
I10732.TM1001CIN	32	43	21	M10	16	43
I10732.TM1201CIN	32	43	21	M12	20	48
I10743.TM1001CIN	43	58	27	(*) M10	16	92
I10743.TM1201CIN	43	58	27	(*) M12	20	92

INOX

I108

CONICAL KNOB WITH PLASTIC THREADED HOLE

+135°
-30°

PA6
+G.F.

UL94
HB

RoHS
COMPLIANT

Materials:

Reinforced polyamide.
Resistant to oils and greases.

Surface finish:

Satin.

Colour:

Black (RAL 9011).

Hole:

Female threaded hole obtained by moulding the plastic (thread tolerance not applicable).

Special requests:

- Upon request and for special quantities available in the colours indicated in the chart (ATTENTION: reduced range for measures marked (*)) [page 807].

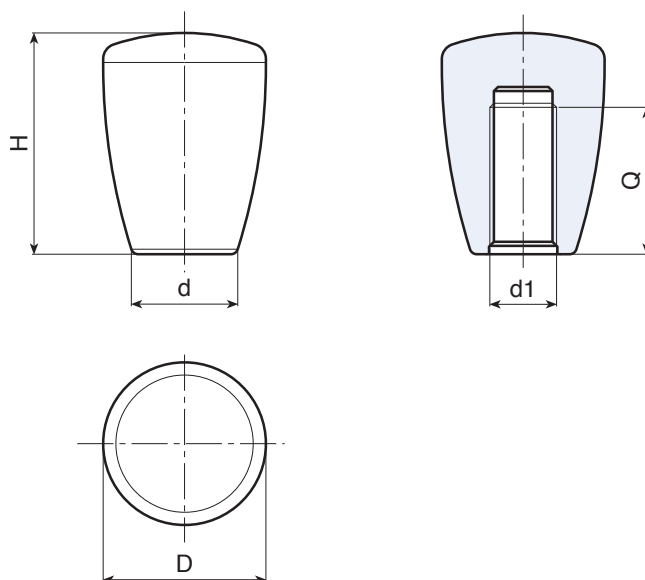

art.	D	H	d	d1	Q	g
I10821.TM0401	21	28	13	M4	16	13
I10821.TM0501	21	28	13	M5	16	12
I10821.TM0601	21	28	13	M6	16	11
I10825.TM0501	25	34	17	M5	24	16
I10825.TM0601	25	34	17	M6	24	16
I10825.TM0801	25	34	17	M8	24	14
I10825.TM1001	25	34	17	M10	24	14
I10832.TM0801	32	43	21	M8	30	32
I10832.TM1001	32	43	21	M10	30	32
I10832.TM1201	32	43	21	M12	30	32
I10843.TM1001	43	58	27	(*) M10	36	80
I10843.TM1201	43	58	27	(*) M12	36	78
I10843.TM1401	43	58	27	(*) M14	36	76
I10843.TM1601	43	58	27	(*) M16	36	74

I109

PUSH-FIT CONICAL KNOB WITH HOLE



Materials:

Reinforced polyamide.
Resistant to oils and greases.

Surface finish:

Satin.

Colour:

Black (RAL 9011).

Hole:

Blind smooth bore, with deformable fixing ribs, obtained by moulding the plastic.

Fixing method:

Push-fit.

Special requests:

- Upon request and for special quantities available in the colours indicated in the chart (ATTENTION: reduced range for measures marked (*)) [page 807].

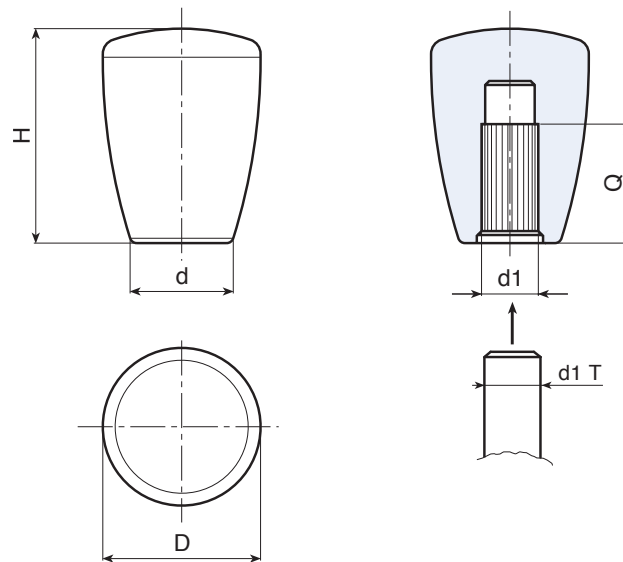

🛒	art.	D	H	d	d1 T	d1	Q	📦
●	I10921.TG0501	21	28	13	+0 -0,048	5	16	13
●	I10925.TG0601	25	34	17	+0 -0,048	6	24	16
●	I10925.TG0801	25	34	17	+0 -0,058	8	24	16
●	I10925.TG1001	25	34	17	+0 -0,058	10	24	14
●	I10932.TG0801	32	43	21	+0 -0,058	8	30	36
●	I10932.TG1001	32	43	21	+0 -0,058	10	30	34
●	I10932.TG1201	32	43	21	+0 -0,070	12	30	30
●	I10943.TG1001	43	58	27	+0 -0,058	(*) 10	36	80
●	I10943.TG1201	43	58	27	+0 -0,070	(*) 12	36	78
●	I10943.TG1401	43	58	27	+0 -0,070	(*) 14	36	76
●	I10943.TG1501	43	58	27	+0 -0,070	(*) 15	36	74

I112

CONICAL KNOB WITH THREADED STUD



Materials:

Reinforced polyamide.
Resistant to oils and greases.

Surface finish:

Satin.

Colour:

Black (RAL 9011).

Inserts:

Galvanised steel threaded stud (thread tolerance 6g).

Special requests:

- Upon request and for special quantities inserts can be supplied with customised lengths.
- Upon request and for special quantities inserts can be supplied in different materials.
- Upon request and for special quantities available in the colours indicated in the chart (ATTENTION: reduced range for measures marked (*)) [page 807].

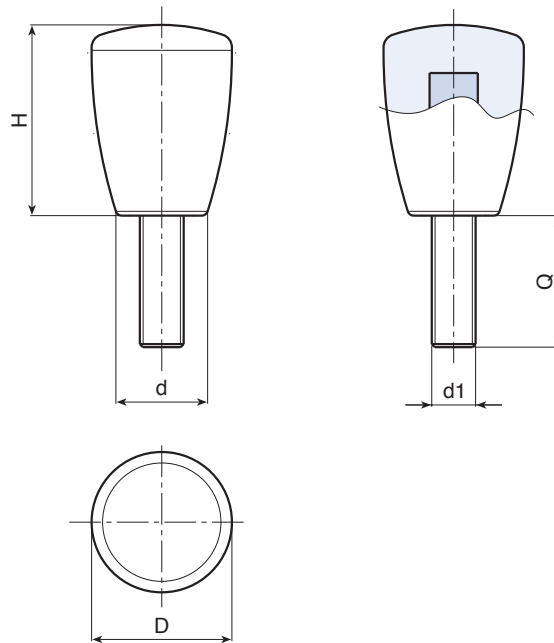

art.	D	H	d	LM	d1 _{6g}	Q	g
I11221.TM04X1601	21	28	13	65	M04	16	16
I11221.TM05X..01	21	28	13	65	M05	A.R.	-
I11221.TM06X1601	21	28	13	65	M06	16	18
I11225.TM06X..01	25	34	17	70	M06	A.R.	-
I11225.TM08X1601	25	34	17	70	M08	16	20
I11225.TM10X2001	25	34	17	70	M10	20	24
I11232.TM08X3001	32	43	21	60	M08	30	48
I11232.TM10X..01	32	43	21	60	M10	A.R.	-
I11232.TM12X..01	32	43	21	60	M12	A.R.	-
I11243.TM10X..01	43	58	27	80	(*) M10	A.R.	-
I11243.TM12X..01	43	58	27	80	(*) M12	A.R.	-
I11243.TM14X..01	43	58	27	80	(*) M14	A.R.	-

Enter the selected stud length in place of the two dots . . in the item code.

A.R. = Customised stud length available for a minimum of 250 pieces.

LM = maximum mouldable length.



Stock availability as % (🛒)
90% (●) - 40% (●) - 5% (●)

I113

CONICAL KNOB WITH LEVER ARM



Materials:

Reinforced polyamide.
Resistant to oils and greases.

Surface finish:

Satin.

Colour:

Black (RAL 9011).

Inserts:

Galvanised steel partially threaded stud (thread tolerance 6g).

Special requests:

- Upon request and for special quantities inserts can be supplied to customer's drawing.
- Upon request and for special quantities inserts can be supplied in different materials/with different coatings.
- Upon request and for special quantities available in the colours indicated in the chart (ATTENTION: reduced range for measures marked (*)) [page 807].

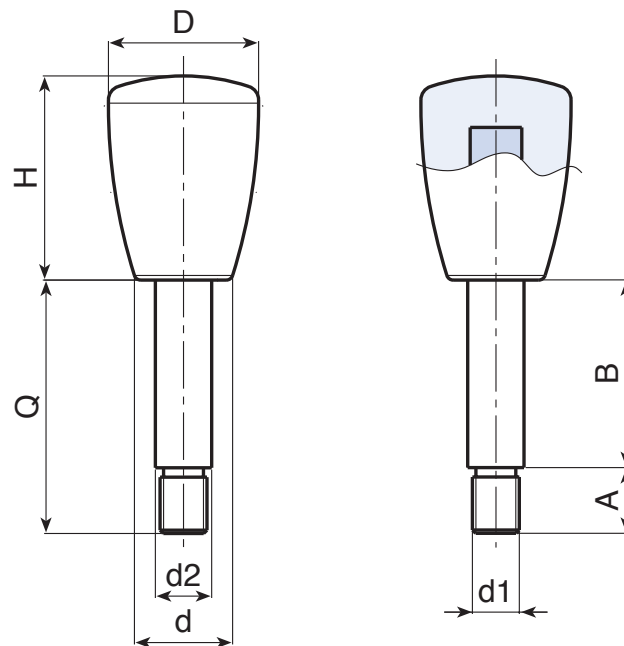

🛒	art.	D	H	d	A	B	d2	d1 _{6g}	Q	📦
●	I11325.TI10X4001	25	34	17	10	30	10	M8	40	42
●	I11325.TI10X5501	25	34	17	10	45	10	M8	55	48
●	I11325.TI10X8001	25	34	17	10	70	10	M8	80	75
●	I11332.TI12X5501	32	43	21	15	40	12	M10	55	86
●	I11332.TI12X6501	32	43	21	15	50	12	M10	65	97
●	I11332.TI14X6501	32	43	21	15	50	14	M12	65	114

Customised stud length available for a minimum of 250 pieces.
LM = Maximum mouldable length.



Stock availability as % (🛒)
90% (●) - 40% (●) - 5% (●)

I500

PUSH-FIT CONICAL KNOB WITH HOLE



Materials:

Reinforced polyamide.
Resistant to oils and greases.

Surface finish:

Satin.

Colour:

Black (RAL 9011).

Hole:

Blind smooth bore, with deformable fixing ribs, obtained by moulding the plastic.

Fixing method:

Push-fit.

Special requests:

- Upon request and for special quantities available in the colours indicated in the chart [page 807].

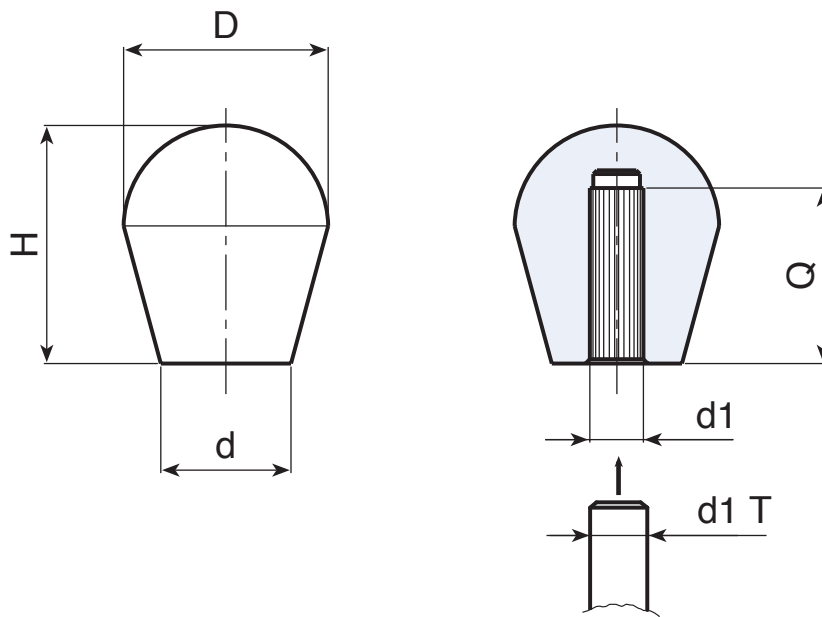

🛒	art.	D	H	d	d1 T	d1	Q	📦
●	I50022.TG0501	22	26	12	+0 -0,048	5	18	9
●	I50022.TG0601	22	26	12	+0 -0,048	6	18	8.5
●	I50022.TG0801	22	26	12	+0 -0,058	8	18	8
●	I50030.TG1001	27	32	18	+0 -0,058	10	23	11
●	I50030.TG1201	27	32	18	+0 -0,070	12	22	11
●	I50030.TG1401	27	32	18	+0 -0,070	14	20	10
●	I50032.TG0601	32	37	19.5	+0 -0,048	6	25	23
●	I50032.TG0801	32	37	19.5	+0 -0,058	8	25	23
●	I50032.TG1001	32	37	19.5	+0 -0,058	10	25	22
●	I50032.TG1201	32	37	19.5	+0 -0,070	12	25	21
●	I50032.TG1401	32	37	19.5	+0 -0,070	14	25	20
●	I50037.TG1201	37	43	24	+0 -0,070	12	30	35
●	I50037.TG1601	37	43	24	+0 -0,070	16	30	33
●	I50037.TG1801	37	43	24	+0 -0,070	18	30	31

I123



CONICAL KNOB "EUROMODEL" WITH CAP AND THREADED HOLE INSERT

Materials:

Reinforced polyamide.
Resistant to oils and greases.

Surface finish:

Satin.

Colour:

Black (RAL 9011).

Central cap:

Grey polyamide (RAL 7035 code 13).

Alternative cap colours:

Orange (RAL 2004 cod. 02).
Blue (RAL 5015 cod. 07).
Yellow (RAL 1021 cod. 10).
Red (RAL 3000 cod. 16).
Green (RAL 6024 cod. 17).
Black (RAL 9011 cod. 01).

Inserts:

Brass insert with female threaded hole (thread tolerance 6H).

Special requests:

- Upon request and for special quantities inserts can be supplied in different materials.
- Upon request and for special quantities available in the colours indicated in the chart [page 807].

PAD PRINTING SERVICE

Upon request and for special quantities caps can be supplied with custom pad printing.

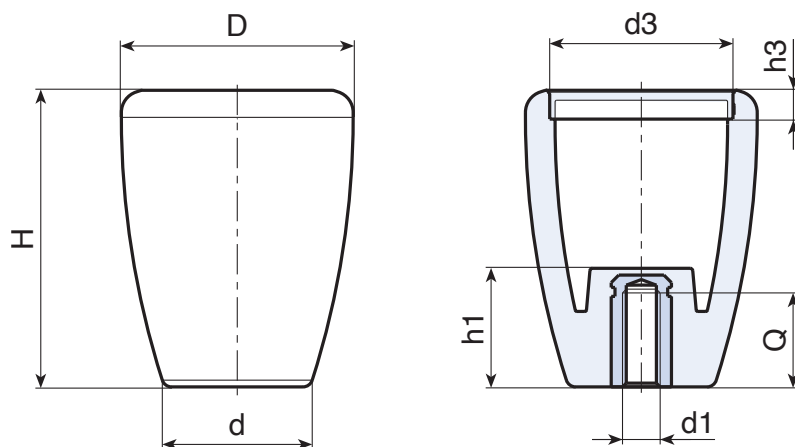

🛒	art.	D	H	d	h1	d3	h3	d1 _{6H}	Q	📦
●	I12343.TM0801	43	55	27	30	34	5.5	M8	16	37
●	I12343.TM1001	43	55	27	30	34	5.5	M10	15	38
●	I12343.TM1201	43	55	27	30	34	5.5	M12	15	40

I124



CONICAL KNOB "EUROMODEL" WITH CAP AND PLASTIC THREADED HOLE

Materials:

Reinforced polyamide.
Resistant to oils and greases.

Surface finish:

Satin.

Colour:

Black (RAL 9011).

Central cap:

Grey polyamide (RAL 7035 code 13).

Alternative cap colours:

Orange (RAL 2004 cod. 02).
Blue (RAL 5015 cod. 07).
Yellow (RAL 1021 cod. 10).
Red (RAL 3000 cod. 16).
Green (RAL 6024 cod. 17).
Black (RAL 9011 cod. 01).

Hole:

Female threaded hole obtained by moulding the plastic (thread tolerance not applicable).

Special requests:

- Upon request and for special quantities available in the colours indicated in the chart [page 807].

PAD PRINTING SERVICE

Upon request and for special quantities caps can be supplied with custom pad printing.

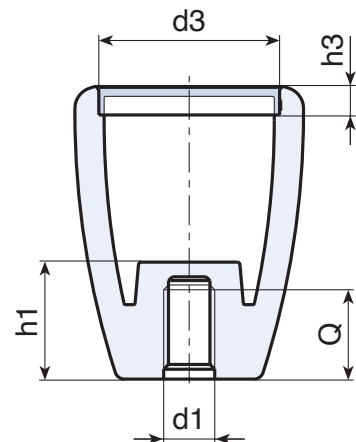
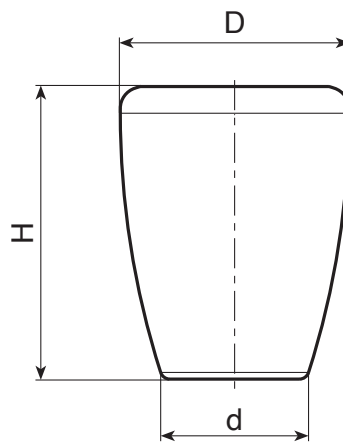

🛒	art.	D	H	d	h1	d3	h3	d1 _{6H}	Q	📦
●	I12443.TM0801	43	55	27	30	34	5.5	M8	24	34
●	I12443.TM1001	43	55	27	30	34	5.5	M10	24	32
●	I12443.TM1201	43	55	27	30	34	5.5	M12	24	30

I125



PUSH-FIT CONICAL KNOB "EUROMODEL" WITH CAP AND HOLE

Materials:

Reinforced polyamide.
Resistant to oils and greases.

Surface finish:

Satin.

Colour:

Black (RAL 9011).

Central cap:

Grey polyamide (RAL 7035 code 13).

Alternative cap colours:

Orange (RAL 2004 cod. 02).
Blue (RAL 5015 cod. 07).
Yellow (RAL 1021 cod. 10).
Red (RAL 3000 cod. 16).
Green (RAL 6024 cod. 17).
Black (RAL 9011 cod. 01).

Hole:

Blind smooth bore, with deformable fixing ribs, obtained by moulding the plastic.

Fixing method:

Push-fit.

Special requests:

- Upon request and for special quantities available in the colours indicated in the chart [page 807].

PAD PRINTING SERVICE

Upon request and for special quantities caps can be supplied with custom pad printing.

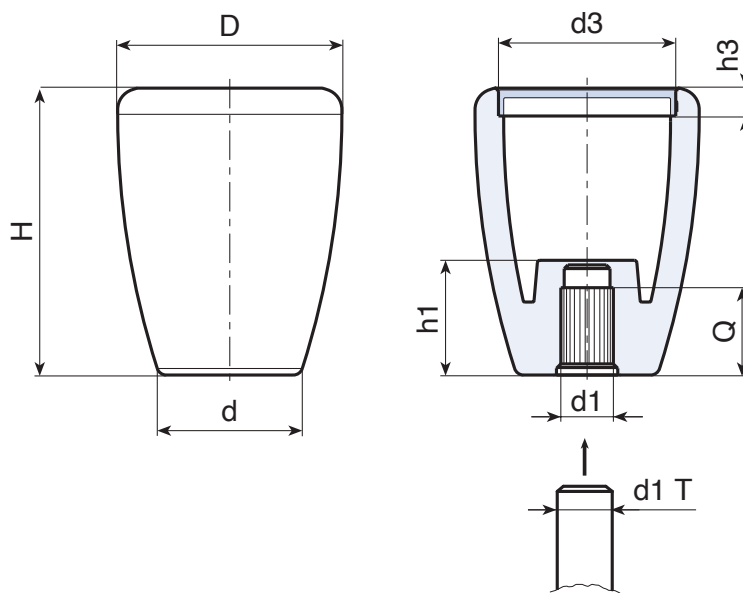

🛒	art.	D	H	d	h1	d3	h3	d1 T	d1	Q	📦
●	I12543.TG0801	43	55	27	30	34	5.5	+0 -0,058	8	24	34
●	I12543.TG1001	43	55	27	30	34	5.5	+0 -0,058	10	24	32
●	I12543.TG1201	43	55	27	30	34	5.5	+0 -0,070	12	24	30

I126



CONICAL KNOB "EUROMODEL" WITH CAP AND THREADED STUD

Materials:

Reinforced polyamide.
Resistant to oils and greases.

Surface finish:

Satin.

Colour:

Black (RAL 9011).

Central cap:

Grey polyamide (RAL 7035 code 13).

Alternative cap colours:

Orange (RAL 2004 cod. 02).
Blue (RAL 5015 cod. 07).
Yellow (RAL 1021 cod. 10).
Red (RAL 3000 cod. 16).
Green (RAL 6024 cod. 17).
Black (RAL 9011 cod. 01).

Inserts:

Galvanised steel threaded stud (thread tolerance 6g).

Special requests:

- Upon request and for special quantities inserts can be supplied with customised lengths.
- Upon request and for special quantities inserts can be supplied in different materials.
- Upon request and for special quantities available in the colours indicated in the chart [page 807].

PAD PRINTING SERVICE

Upon request and for special quantities caps can be supplied with custom pad printing.

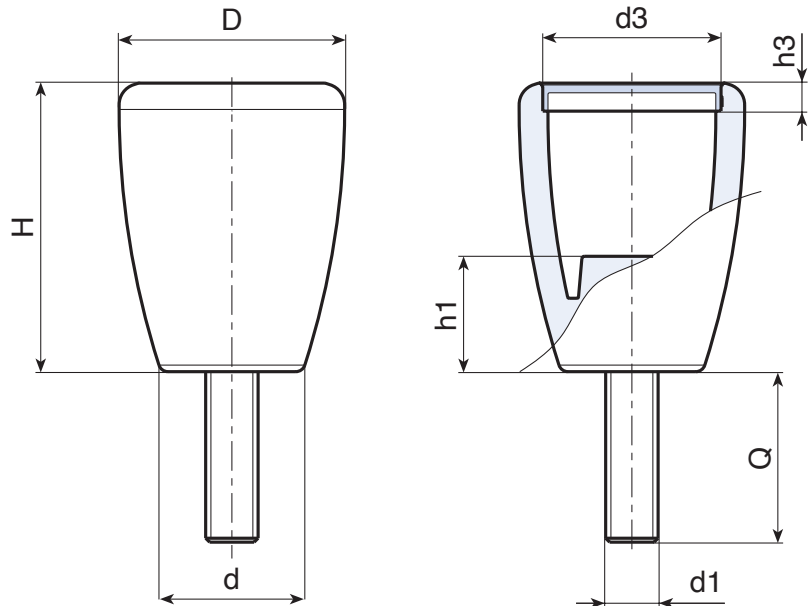

art.	D	H	d	h1	d3	h3	LM	d1 _{6g}	Q	g
● I12643.TM08X..01	43	55	27	30	34	5.5	80	M8	A.R.	-
● I12643.TM10X..01	43	55	27	30	34	5.5	80	M10	A.R.	-
● I12643.TM12X..01	43	55	27	30	34	5.5	80	M12	A.R.	-

Enter the selected stud length in place of the two dots .. in the item code.

LM = Maximum mouldable length.

A.R. = Customised stud lengths only available for a minimum of 250 pieces.



I117



MUSHROOM KNOB WITH THREADED INSERT

Materials:

Reinforced polyamide.
Resistant to oils and greases.

Surface finish:

Satin.

Colour:

Black (RAL 9011).

Inserts:

I117:

Brass insert with female threaded hole (thread tolerance 6H).

I117CIN:

Stainless steel insert with female threaded hole (Aisi 303) (thread tolerance 6H).

Special requests:

- Upon request and for special quantities inserts can be supplied in different materials.
- Upon request and for special quantities available in the colours indicated in the chart [page 807].

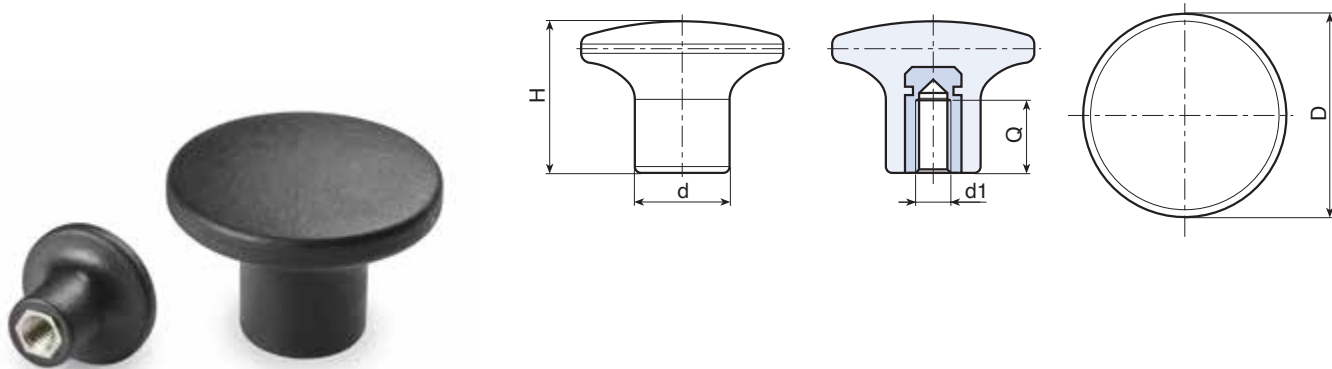

Version I117: with brass insert.

art.	D	H	d	d1 _{6H}	Q	g
I11722.TM0401	22	17	11	M04	9.5	6
I11722.TM0501	22	17	11	M05	8	6
I11722.TM0601	22	17	11	M06	8	6
I11726.TM0501	26	20.5	13	M05	15.5	9
I11726.TM0601	26	20.5	13	M06	13	9
I11726.TM0801	26	20.5	13	M08	13	10
I11732.TM0501	32	24	15	M05	8	12
I11732.TM0601	32	24	15	M06	8	12
I11732.TM0801	32	24	15	M08	13	14
I11745.TM0801	45	32	21	M08	13	32
I11745.TM1001	45	32	21	M10	13	33
I11745.TM1201	45	32	21	M12	17	34

Version I117CIN: with stainless steel insert (Aisi 303).

INOX

art.	D	H	d	d1 _{6H}	Q	g
I11722.TM0501CIN	22	17	11	M05	9	8
I11722.TM0601CIN	22	17	11	M06	9	9
I11726.TM0501CIN	26	20.5	13	M05	9	10
I11726.TM0601CIN	26	20.5	13	M06	9	11
I11726.TM0801CIN	26	20.5	13	M08	13	12
I11732.TM0601CIN	32	24	15	M06	14	16
I11732.TM0801CIN	32	24	15	M08	13	18
I11745.TM1001CIN	45	32	21	M10	16	35
I11745.TM1201CIN	45	32	21	M12	15	39



I118

MUSHROOM KNOB WITH PLASTIC THREADED HOLE



Materials:

Reinforced polyamide.
Resistant to oils and greases.

Surface finish:

Satin.

Colour:

Black (RAL 9011).

Hole:

Female threaded hole obtained by moulding the plastic (thread tolerance not applicable).

Special requests:

- Upon request and for special quantities available in the colours indicated in the chart [page 807].

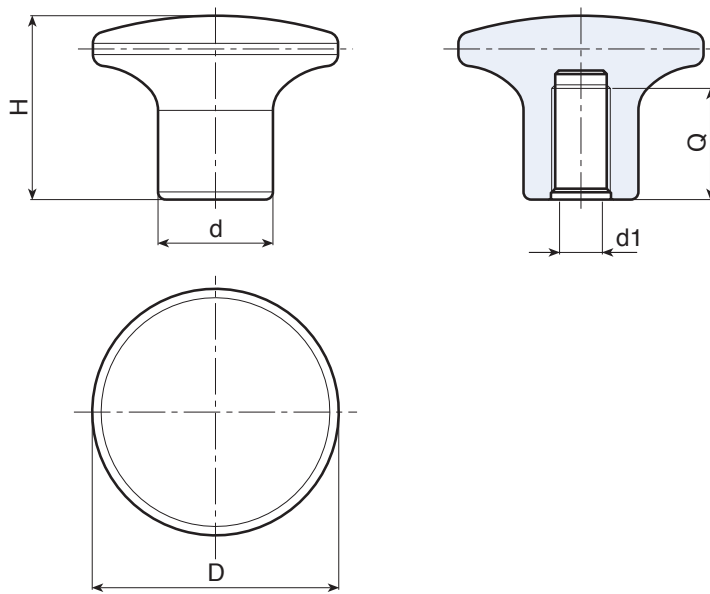

art.	D	H	d	d1	Q	g
I11822.TM0401	22	17	11	M4	12	4
I11822.TM0501	22	17	11	M5	12	4
I11822.TM0601	22	17	11	M6	12	4
I11826.TM0501	26	20.5	13	M5	13	6
I11826.TM0601	26	20.5	13	M6	13	6
I11826.TM0801	26	20.5	13	M8	13	6
I11832.TM0501	32	24	15	M5	15	10
I11832.TM0601	32	24	15	M6	15	10
I11832.TM0801	32	24	15	M8	15	10
I11845.TM0801	45	32	21	M8	21	26
I11845.TM1001	45	32	21	M10	21	25
I11845.TM1201	45	32	21	M12	21	25
I11845.TM1401	45	32	21	M14	21	23

I119



MUSHROOM KNOB WITH THREADED STUD

Materials:

Reinforced polyamide.
Resistant to oils and greases.

Surface finish:

Satin.

Colour:

Black (RAL 9011).

Inserts:

Galvanised steel threaded stud (thread tolerance 6g).

Special requests:

- Upon request and for special quantities inserts can be supplied with customised lengths.
- Upon request and for special quantities inserts can be supplied in different materials.
- Upon request and for special quantities available in the colours indicated in the chart [page 807].

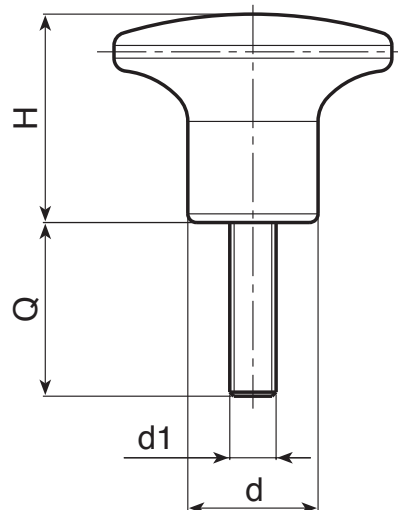
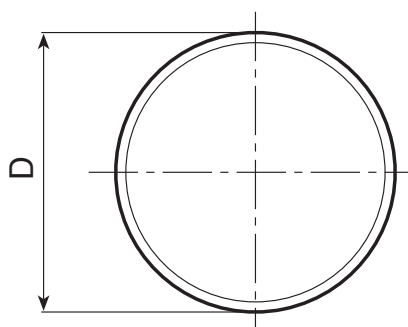

🛒	art.	D	H	d	LM	d1 _{6g}	Q	📦
●	I11922.TM04X2001	22	17	11	65	M4	20	6
●	I11922.TM05X3001	22	17	11	56	M5	30	9
●	I11922.TM06X3001	22	17	11	65	M6	30	12
●	I11926.TM05X..01	26	20.5	13	70	M5	A.R.	11
●	I11926.TM06X3001	26	20.5	13	70	M6	30	14
●	I11926.TM08X3001	26	20.5	13	70	M8	30	30
●	I11932.TM05X..01	32	24	15	70	M5	A.R.	16
●	I11932.TM06X3001	32	24	15	70	M6	30	18
●	I11932.TM08X4001	32	24	15	70	M8	40	28
●	I11945.TM08X..01	45	32	21	100	M8	A.R.	42
●	I11945.TM10X3001	45	32	21	100	M10	30	48
●	I11945.TM12X4001	45	32	21	100	M12	40	72

Enter the selected stud length in place of the two dots .. in the item code.

LM = maximum mouldable length.

A.R. = Customised stud length only available for a minimum of 250 pieces.

I130



"EUROMODEL" MUSHROOM KNOB WITH CAP AND THREADED STUD

Materials:

Reinforced polyamide.
Resistant to oils and greases.

Surface finish:

Satin.

Colour:

Black (RAL 9011).

Central cap:

Grey polyamide (RAL 7035 code 13).

Alternative cap colours:

Orange (RAL 2004 cod. 02).
Blue (RAL 5015 cod. 07).
Yellow (RAL 1021 cod. 10).
Red (RAL 3000 cod. 16).
Green (RAL 6024 cod. 17).
Black (RAL 9011 cod. 01).

Inserts:

Galvanised steel threaded stud (thread tolerance 6g).

Special requests:

- Upon request and for special quantities inserts can be supplied with customised lengths.
- Upon request and for special quantities inserts can be supplied in different materials.
- Upon request and for special quantities available in the colours indicated in the chart [page 807].

PAD PRINTING SERVICE

Upon request and for special quantities caps can be supplied with custom pad printing.

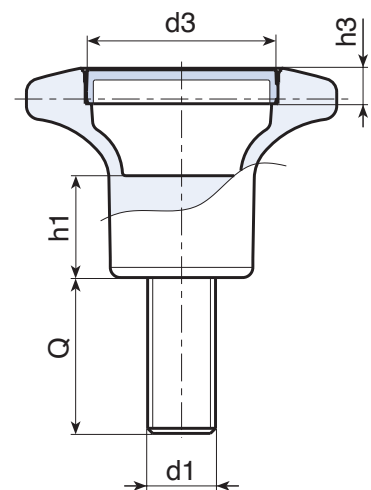
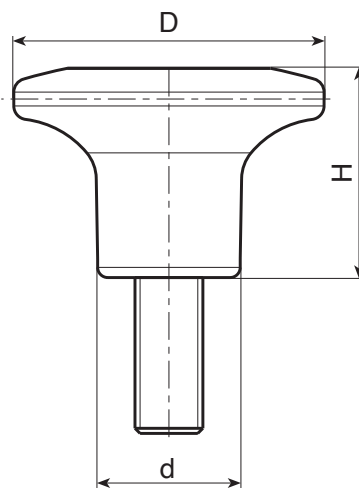

art.	D	H	d	h1	d3	h3	LM	d1 _{6g}	Q	g
I13045.TM08X3001	45	31	21	15	28	5	100	M8	30	36
I13045.TM10X..01	45	31	21	15	28	5	100	M10	A.R.	-
I13045.TM12X..01	45	31	21	15	28	5	100	M12	A.R.	-

Enter the selected stud length in place of the two dots .. in the item code.

LM = Maximum mouldable length.

A.R. = Customised stud lengths only available for a minimum of 250 pieces.



I131



"EUROMODEL" MUSHROOM KNOB WITH CAP AND THREADED HOLE INSERT

Materials:

Reinforced polyamide.
Resistant to oils and greases.

Surface finish:

Satin.

Colour:

Black (RAL 9011).

Central cap:

Grey polyamide (RAL 7035 code 13).

Alternative cap colours:

Orange (RAL 2004 cod. 02).
Blue (RAL 5015 cod. 07).
Yellow (RAL 1021 cod. 10).
Red (RAL 3000 cod. 16).
Green (RAL 6024 cod. 17).
Black (RAL 9011 cod. 01).

Inserts:

Brass insert with female threaded hole (thread tolerance 6H).

Special requests:

- Upon request and for special quantities inserts can be supplied in different materials.
- Upon request and for special quantities available in the colours indicated in the chart [page 807].

PAD PRINTING SERVICE

Upon request and for special quantities caps can be supplied with custom pad printing.

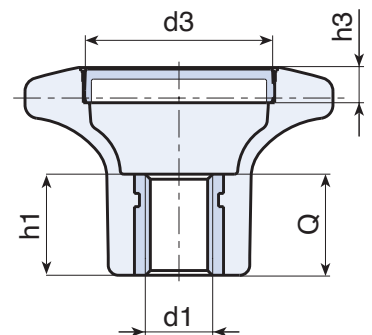
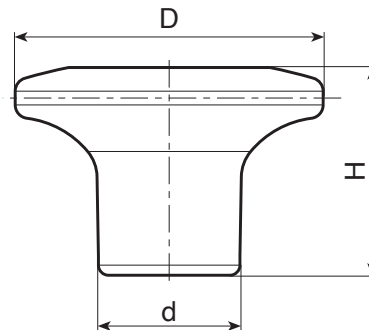

	art.	D	H	d	h1	d3	h3	d1 _{6H}	Q	g
●	I13145.TM0801	45	31	21	15	28	5	M8	15	18
●	I13145.TM1001	45	31	21	15	28	5	M10	15	17
●	I13145.TM1201	45	31	21	15	28	5	M12	15	15
●	I13145.TM1401	45	31	21	15	28	5	M14	15	14

I132



"EUROMODEL" MUSHROOM KNOB WITH CAP AND PLASTIC THREADED HOLE

Materials:

Reinforced polyamide.
Resistant to oils and greases.

Surface finish:

Satin.

Colour:

Black (RAL 9011).

Central cap:

Grey polyamide (RAL 7035 code 13).

Alternative cap colours:

Orange (RAL 2004 cod. 02).
Blue (RAL 5015 cod. 07).
Yellow (RAL 1021 cod. 10).
Red (RAL 3000 cod. 16).
Green (RAL 6024 cod. 17).
Black (RAL 9011 cod. 01).

Hole:

Female threaded hole obtained by moulding the plastic (thread tolerance not applicable).

Special requests:

- Upon request and for special quantities available in the colours indicated in the chart [page 807].

PAD PRINTING SERVICE

Upon request and for special quantities caps can be supplied with custom pad printing.

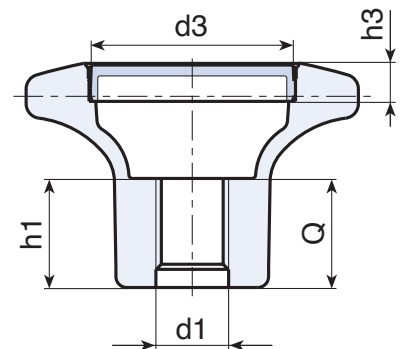
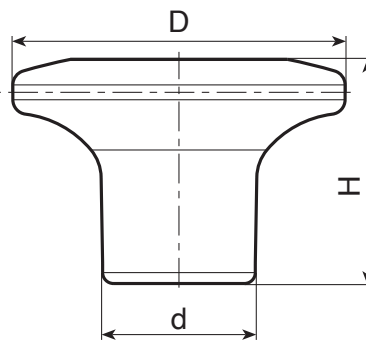

art.	D	H	d	h1	d3	h3	d1	Q	g
● I13245.TM0801	45	31	21	15	28	5	M8	15	16
● I13245.TM1001	45	31	21	15	28	5	M10	15	15
● I13245.TM1201	45	31	21	15	28	5	M12	15	14