



LOVE
HANDLE



BOTELO[®]
YOUR MECHANICAL COMPONENT

W837-W838



THREADED PLASTIC SPRING PLUNGER WITH SLOTTED END AND PLASTIC OR STEEL BALL

Materials:

Plunger body in plastic (Delrin - POM).

Surface finish:

Smooth.

Colour:

Black (RAL 9011).

Ball:

W837:

Hardened stainless steel ball (Aisi 420).

W838:

White plastic ball (Delrin - POM).

Spring:

Stainless steel spring (Aisi 301).

Type of spring thrust:

Normal.

Special requests:

- None.

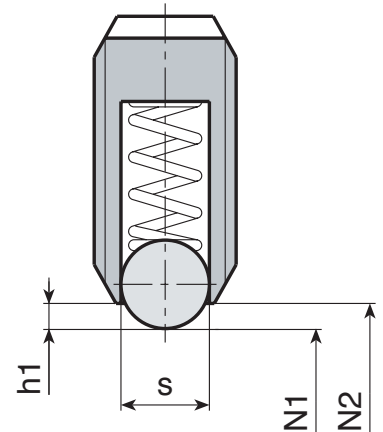
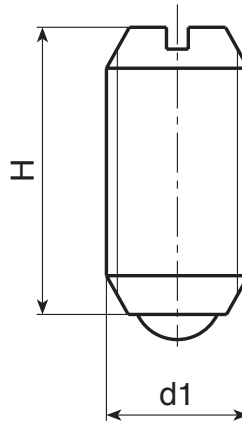

Version W837: with stainless steel ball

art.	s	H	h1	N1 (N)	N2 (N)	d1 _{6H}	g
W837.TM06	3.5	14	1	9	13	M6	0.4
W837.TM08	5	16	1.5	15	30	M8	1
W837.TM10	6	19	2	20	40	M10	2

Version W838: with plastic ball (DELIRIN)

art.	s	H	h1	N1 (N)	N2 (N)	d1 _{6H}	g
W838.TM06	3.5	14	1	9	13	M6	0.4
W838.TM08	5	16	1.5	15	30	M8	1
W838.TM10	6	19	2	20	40	M10	2

W830

THREADED STEEL SPRING PLUNGER WITH SLOTTED END



C40

Aisi 303



Materials:

W830:

Steel plunger body with property class 5.8.

W830CIN:

Stainless steel plunger body (Aisi 303).

Surface finish:

Smooth.

Colour:

W830:

Black-oxide treated.

W830CIN:

Natural.

Ball:

Hardened stainless steel ball (bearing type) (Aisi 420).

Spring:

W830:

Harmonic steel spring.

W830CIN:

Stainless steel spring (Aisi 301).

Type of spring thrust:

Normal.

Special requests:

- None.

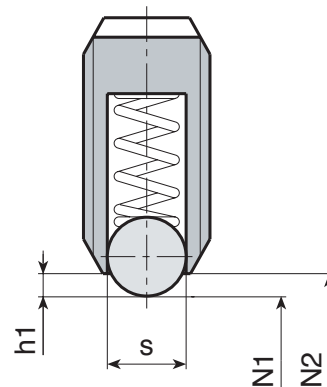
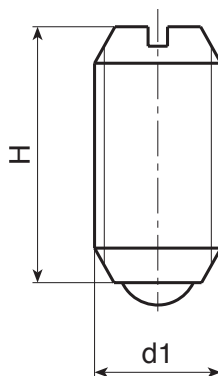

Version W830: black-oxide treated steel

art.	s	H	h1	N1 (N)	N2 (N)	d1 _{6H}	g
W830.VBM03	1.5	7	0.5	1.5	3	M3	0.2
W830.VBM04	2.5	9	0.8	4	10	M4	0.4
W830.VBM05	3	12	0.9	6	11	M5	0.9
W830.VBM06	3.5	14	1	9	13	M6	1.5
W830.VBM08	5	16	1.5	15	30	M8	3.5
W830.VBM10	6	19	2	20	35	M10	7
W830.VBM12	8	22	2.5	30	55	M12	10
W830.VBM16	10	24	3.5	65	125	M16	24
W830.VBM20	12	30	4.5	80	160	M20	44

Version W830 CIN - stainless steel (Aisi 303).

INOX

art.	s	H	h1	N1 (N)	N2 (N)	d1 _{6H}	g
W830.INM03CIN	1.5	7	0.5	1.5	3	M3	0.2
W830.INM04CIN	2.5	9	0.8	4	10	M4	0.4
W830.INM05CIN	3	12	0.9	6	11	M5	0.9
W830.INM06CIN	3.5	14	1	9	13	M6	1.5
W830.INM08CIN	5	16	1.5	15	30	M8	3.5
W830.INM10CIN	6	19	2	20	35	M10	7
W830.INM12CIN	8	22	2.5	30	55	M12	10
W830.INM16CIN	10	24	3.5	65	125	M16	24
W830.INM20CIN	12	30	4.5	80	160	M20	44

W831



C40

Aisi 303



THREADED STEEL SPRING PLUNGER WITH SLOTTED END - STRONGER THRUST

Materials:

W831:

Steel plunger body with property class 5.8.

W831CIN:

Stainless steel plunger body (Aisi 303).

Surface finish:

Smooth.

Colour:

W831:

Black-oxide treated.

W831CIN:

Natural.

Ball:

Hardened stainless steel ball (bearing type) (Aisi 420).

Spring:

W831:

Harmonic steel spring.

W831CIN:

Stainless steel spring (Aisi 301).

Type of spring thrust:

Stronger.

Special requests:

- None.

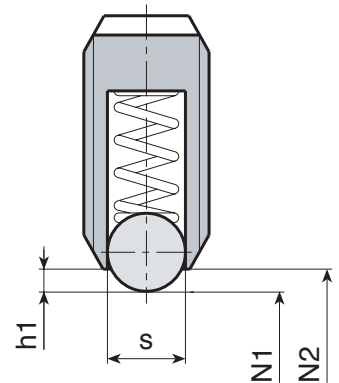
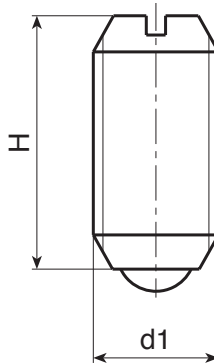

Version W831: black-oxide treated steel

art.	s	H	h1	N1 (N)	N2 (N)	d1 _{6H}	g
W831.VBM04	2.5	9	0.8	12	22	M4	0.4
W831.VBM05	3	12	0.9	19	30	M5	0.9
W831.VBM06	3.5	14	1	28	40	M6	1.5
W831.VBM08	5	16	1.5	47	73	M8	3.5
W831.VBM10	6	19	2	66	100	M10	6.5
W831.VBM12	8	22	2.5	66	120	M12	10
W831.VBM16	10	24	3.5	90	180	M16	24
W831.VBM20	12	30	4.5	115	240	M20	44

Version W831CIN - stainless steel (Aisi 303)

art.	s	H	h1	N1 (N)	N2 (N)	d1 _{6H}	g
W831.INM04CIN	2.5	9	0.8	12	22	M4	0.4
W831.INM05CIN	3	12	0.9	19	30	M5	0.9
W831.INM06CIN	3.5	14	1	28	40	M6	1.5
W831.INM08CIN	5	16	1.5	47	73	M8	3.5
W831.INM10CIN	6	19	2	66	100	M10	6.5
W831.INM12CIN	8	22	2.5	66	120	M12	10
W831.INM16CIN	10	24	3.5	90	180	M16	24
W831.INM20CIN	12	30	4.5	115	240	M20	44

INOX

W834



C40

Aisi 303



THREADED STEEL SPRING PLUNGER WITH HEXAGON SOCKET END

Materials:

W834:

Steel plunger body with property class 5.8.

W834CIN:

Stainless steel plunger body (Aisi 303).

Surface finish:

Smooth.

Colour:

W834:

Black-oxide treated.

W834CIN:

Natural.

Ball:

Hardened stainless steel ball (bearing type) (Aisi 420).

Spring:

W834:

Harmonic steel spring.

W834CIN:

Stainless steel spring (Aisi 301).

Type of spring thrust:

Normal.

Special requests:

- None.

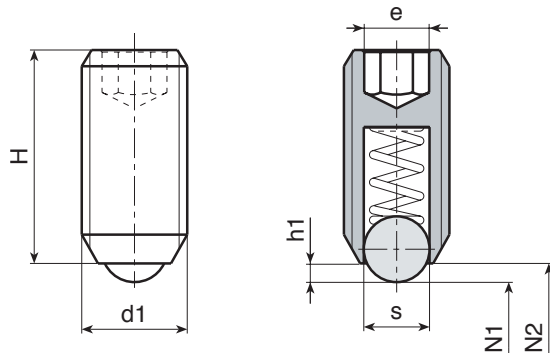

Version W834: black-oxide treated steel

art.	s	H	h1	N1 (N)	N2 (N)	d1 _{6H}	g
W834.VBM03	1.5	9	0.5	1.5	3	M3	0.2
W834.VBM04	2.5	10	0.8	4	10	M4	0.4
W834.VBM05	3	14	0.9	6	11	M5	1.2
W834.VBM06	3.5	15	1	9	13	M6	2
W834.VBM08	5	18	1.5	15	30	M8	4
W834.VBM10	6	23	2	20	35	M10	8
W834.VBM12	8	26	2.5	30	55	M12	12
W834.VBM16	10	33	3.5	65	125	M16	31
W834.VBM20	12	43	4.5	80	160	M20	64
W834.VBM24	15	48	5.5	90	180	M24	100

Version W834CIN - stainless steel (Aisi 303)

INOX

art.	s	H	h1	N1 (N)	N2 (N)	d1 _{6H}	g
W834.INM03CIN	1.5	9	0.5	1.5	3	M3	0.2
W834.INM04CIN	2.5	10	0.8	4	10	M4	0.4
W834.INM05CIN	3	14	0.9	6	11	M5	1.2
W834.INM06CIN	3.5	15	1	9	13	M6	2
W834.INM08CIN	5	18	1.5	15	30	M8	4
W834.INM10CIN	6	23	2	20	35	M10	8
W834.INM12CIN	8	26	2.5	30	55	M12	12
W834.INM16CIN	10	33	3.5	65	125	M16	31
W834.INM20CIN	12	43	4.5	80	160	M20	64
W834.INM24CIN	15	48	5.5	90	180	M24	100

W835



C40

Aisi 303



THREADED STEEL SPRING PLUNGER WITH HEXAGON SOCKET END STRONGER THRUST

Materials:

W835:

Steel plunger body with property class 5.8.

W835CIN:

Stainless steel plunger body (Aisi 303).

Surface finish:

Smooth.

Colour:

W835:

Black-oxide treated.

W835CIN:

Natural.

Ball:

Hardened stainless steel ball (bearing type) (Aisi 420).

Spring:

W835:

Harmonic steel spring.

W835CIN:

Stainless steel spring (Aisi 301).

Type of spring thrust:

Stronger.

Special requests:

- None.

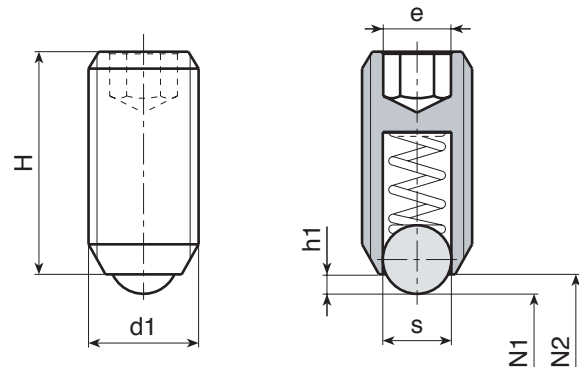

Version W835: black-oxide treated steel

art.	s	H	h1	N1 (N)	N2 (N)	d _{16H}	g
W835.VBM03	1.5	9	0.5	12	22	M4	0.2
W835.VBM04	2.5	10	0.8	12	22	M4	0.4
W835.VBM05	3	14	0.9	19	30	M5	1.2
W835.VBM06	3.5	15	1	28	40	M6	2
W835.VBM08	5	18	1.5	47	73	M8	4
W835.VBM10	6	23	2	66	100	M10	8
W835.VBM12	8	26	2.5	66	120	M12	12
W835.VBM16	10	33	3.5	90	180	M16	31
W835.VBM20	12	43	4.5	115	240	M20	64
W835.VBM24	15	48	5.5	130	270	M24	100

Version W835CIN - stainless steel (Aisi 303)

INOX

art.	s	H	h1	N1 (N)	N2 (N)	d _{16H}	g
W835.INM03CIN	1.5	9	0.5	12	22	M3	0.2
W835.INM04CIN	2.5	10	0.8	12	22	M4	0.4
W835.INM05CIN	3	14	0.9	12	30	M5	1.2
W835.INM06CIN	3.5	15	1	28	40	M6	2
W835.INM08CIN	5	18	1.5	47	73	M8	4
W835.INM10CIN	6	23	2	66	100	M10	8
W835.INM12CIN	8	26	2.5	66	120	M12	12
W835.INM16CIN	10	33	3.5	90	180	M16	31
W835.INM20CIN	12	43	4.5	115	240	M20	64
W835.INM24CIN	15	48	5.5	130	270	M24	100

W832



C40

Aisi 303



THREADED STEEL SPRING PLUNGER WITH SLOTTED END AND NOSE PIN

Materials:

W832:

Steel plunger body with property class 5.8.

W832CIN:

Stainless steel plunger body (Aisi 303).

Surface finish:

Smooth.

Colour:

W832:

Black-oxide treated.

W832CIN:

Natural.

Nose pin:

W832:

Turned hardened and black-oxide treated steel nose pin.

W832CIN:

Turned stainless steel nose pin (Aisi 303).

Spring:

W832:

Harmonic steel spring.

W832CIN:

Stainless steel spring (Aisi 301).

Type of spring thrust:

Normal.

Special requests:

- None.

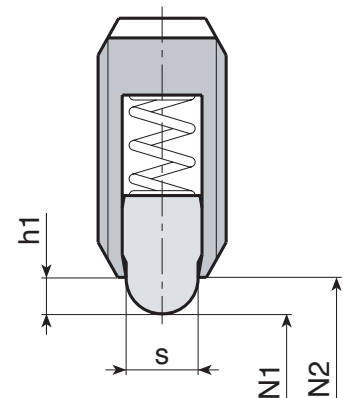
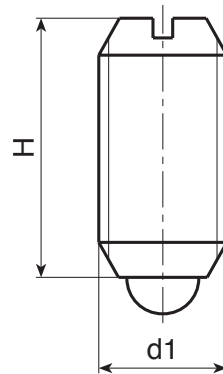

Version W832: black-oxide treated steel

art.	s	H	h1	N1 (N)	N2 (N)	d1 _{6H}	g
W832.VBM04	1.8	9	1.5	6	20	M4	0.5
W832.VBM05	2.4	12	2	6	20	M5	1
W832.VBM06	2.7	14	2	7	20	M6	1.7
W832.VBM08	4	16	2	15	30	M8	4
W832.VBM10	4.5	19	2.5	20	35	M10	7
W832.VBM12	6	22	3.5	30	55	M12	13
W832.VBM16	8.5	24	4.5	45	100	M16	24
W832.VBM20	10	30	6.5	60	120	M20	46

Version W832CIN - stainless steel (Aisi 303)

INOX

art.	s	H	h1	N1 (N)	N2 (N)	d1 _{6H}	g
W832.INM04CIN	1.8	9	1.5	6	20	M4	0.5
W832.INM05CIN	2.4	12	2	6	20	M5	1
W832.INM06CIN	2.7	14	2	7	20	M6	1.7
W832.INM08CIN	4	16	2	15	30	M8	4
W832.INM10CIN	4.5	19	2.5	20	35	M10	7
W832.INM12CIN	6	22	3.5	30	55	M12	13
W832.INM16CIN	8.5	24	4.5	45	100	M16	24
W832.INM20CIN	10	30	6.5	60	120	M20	46

W833



C40

Aisi 303



THREADED STEEL SPRING PLUNGER WITH SLOTTED END AND NOSE PIN - STRONGER THRUST

Materials:

W833:

Steel plunger body with property class 5.8.

W833CIN:

Stainless steel plunger body (Aisi 303).

Surface finish:

Smooth.

Colour:

W833:

Black-oxide treated.

W833CIN:

Natural.

Nose pin:

W833:

Turned hardened and black-oxide treated steel nose pin.

W833CIN:

Turned stainless steel nose pin (Aisi 303).

Spring:

W833:

Harmonic steel spring.

W833CIN:

Stainless steel spring (Aisi 301).

Type of spring thrust:

Stronger.

Special requests:

- None.

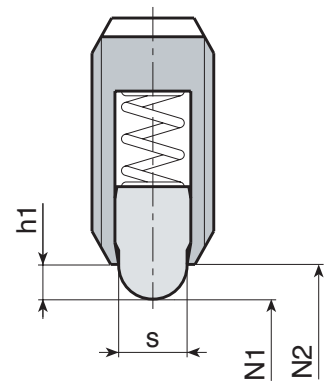
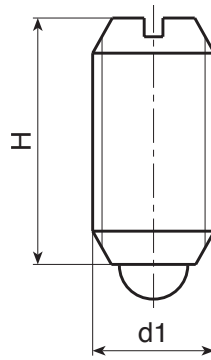

Version W833: black-oxide treated steel

art.	s	H	h1	N1 (N)	N2 (N)	d1 _{6H}	g
W833.VBM05	2.4	12	2	9	25	M5	1
W833.VBM06	2.7	14	2	11	25	M6	1.7
W833.VBM08	4	16	2	22	43	M8	4
W833.VBM10	4.5	19	2.5	20	54	M10	7
W833.VBM12	6	22	3.5	36	94	M12	13
W833.VBM16	8.5	24	4.5	60	110	M16	24

Version W833 CIN - stainless steel (Aisi 303).

INOX

art.	s	H	h1	N1 (N)	N2 (N)	d1 _{6H}	g
W833.INM05CIN	2.4	12	2	9	25	M5	1
W833.INM06CIN	2.7	14	2	11	25	M6	1.7
W833.INM08CIN	4	16	2	22	43	M8	4
W833.INM10CIN	4.5	19	2.5	20	54	M10	7
W833.INM12CIN	6	22	3.5	36	94	M12	13
W833.INM16CIN	8.5	24	4.5	60	110	M16	24

W836



C40

Aisi 303



THREADED STEEL SPRING PLUNGER WITH HEXAGON SOCKET END AND NOSE PIN

Materials:

W836:

Steel plunger body with property class 5.8.

W836CIN:

Stainless steel plunger body (Aisi 303).

Surface finish:

Smooth.

Colour:

W836:

Black-oxide treated.

W836CIN:

Natural.

Nose pin:

W836:

Turned hardened and black-oxide treated steel nose pin.

W836CIN:

Turned stainless steel nose pin (Aisi 303).

Spring:

W836:

Harmonic steel spring.

W836CIN:

Stainless steel spring (Aisi 301).

Type of spring thrust:

Normal.

Special requests:

- None.

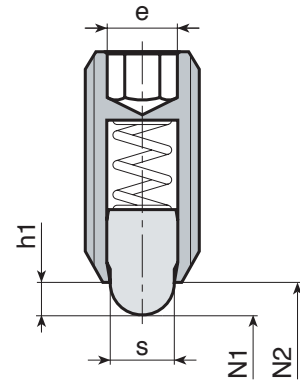
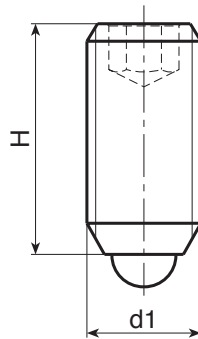

Version W836: black-oxide treated steel

art.	s	H	h1	N1 (N)	N2 (N)	d1 _{6H}	g
W836.VBM05	2.4	14	2	5	13	M5	1.1
W836.VBM06	2.7	15	2	6	17	M6	2
W836.VBM08	3.8	18	2	16	33	M8	4
W836.VBM10	4.5	23	2.5	19	42	M10	8
W836.VBM12	6.2	26	3.5	22	57	M12	12
W836.VBM16	8.5	33	4.5	38	78	M16	31
W836.VBM20	10	43	6.5	39	81	M20	64
W836.VBM24	13	48	8	72	155	M24	100

Version W836CIN - stainless steel (Aisi 303)

INOX

art.	s	H	h1	N1 (N)	N2 (N)	d1 _{6H}	g
W836.INM05CIN	2.4	14	2	5	13	M5	1.1
W836.INM06CIN	2.7	15	2	6	17	M6	2
W836.INM08CIN	3.8	18	2	16	33	M8	4
W836.INM10CIN	4.5	23	2.5	19	42	M10	8
W836.INM12CIN	6.2	26	3.5	22	57	M12	12
W836.INM16CIN	8.5	33	4.5	38	78	M16	31
W836.INM20CIN	10	43	6.5	39	81	M20	64
W836.INM24CIN	13	48	8	72	155	M24	100

W840



C40

Aisi 303



THREADED STEEL SPRING PLUNGER WITH GRUB SCREW AND NOSE PIN

Materials:

W840:

Steel plunger body with property class 5.8.

W840CIN:

Stainless steel plunger body (Aisi 303).

Surface finish:

Smooth.

Colour:

W840:

Black-oxide treated.

W840CIN:

Natural.

Nose pin:

W840:

(1) Turned hardened and black-oxide treated steel nose pin.

W840CIN:

(1) Turned stainless steel nose pin (Aisi 303).

Spring:

W840:

(3) Harmonic steel spring.

W840CIN:

(3) Stainless steel spring (Aisi 301).

Grub screw:

W840:

(2) Black-oxide treated steel grub screw with hexagon socket head (attention: the grub screw is glued in place).

W840CIN:

(2) Stainless steel grub screw (Aisi 303) with hexagon socket head (attention: the grub screw is glued in place).

Type of spring thrust:

Normal.

Special requests:

- None.

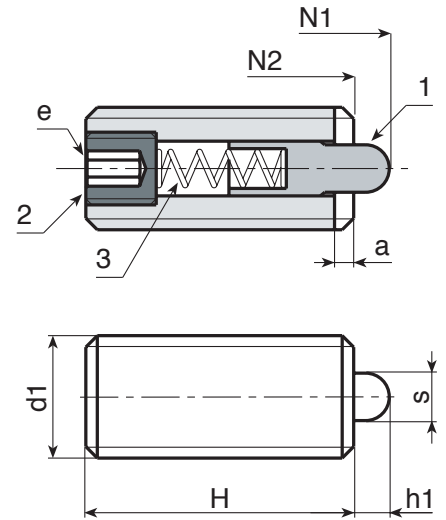

Version W840: black-oxide treated steel

art.	s	H	h1	e	a	b	N1 (N)	N2 (N)	d1 _{6H}	g
W840.VBM04	1.5	15	1.5	1.3	0.6	0.6	5	16	M4	0.8
W840.VBM05	2.4	18	2.3	1.5	0.8	0.8	6	20	M5	1.3
W840.VBM06	2.7	20	2.5	2	1	1	7	20	M6	2.5
W840.VBM08	3.5	22	3	2.5	1.4	1.2	9	35	M8	6
W840.VBM10	4	22	3	3	1.4	1.6	9	35	M10	9
W840.VBM12	6	28	4	4	2	2	10	55	M12	16
W840.VBM16	7.5	32	5	5	2.5	2.5	45	100	M16	35
W840.VBM20	10	40	7	6	3	2.5	60	120	M20	65
W840.VBM24	12	52	10	8	3	2.5	80	160	M24	122

Version W840CIN - stainless steel (Aisi 303)

art.	s	H	h1	e	a	b	N1 (N)	N2 (N)	d1 _{6H}	g
W840.INM05CIN	2.4	18	2.3	1.5	0.8	0.8	6	20	M5	1.3
W840.INM06CIN	2.7	20	2.5	2	1	1	7	20	M6	2.5
W840.INM08CIN	3.5	22	3	2.5	1.4	1.2	9	35	M8	6
W840.INM10CIN	4	22	3	3	1.4	1.6	9	35	M10	9
W840.INM12CIN	6	28	4	4	2	2	10	55	M12	16
W840.INM16CIN	7.5	32	5	5	2.5	2.5	45	100	M16	35

INOX

W842



THREADED STEEL SPRING PLUNGER WITH GRUB SCREW AND PLASTIC NOSE PIN

Materials:

W840:

Steel plunger body with property class 5.8.

W840CIN:

Stainless steel plunger body (Aisi 303).

Surface finish:

Smooth.

Colour:

W840:

Black-oxide treated.

W840CIN:

Natural.

Nose pin:

W840:

(1) Turned hardened and black-oxide treated steel nose pin.

W840CIN:

(1) Turned stainless steel nose pin (Aisi 303).

Spring:

W840:

(3) Harmonic steel spring.

W840CIN:

(3) Stainless steel spring (Aisi 301).

Grub screw:

W840:

(2) Black-oxide treated steel grub screw with hexagon socket head (attention: the grub screw is glued in place).

W840CIN:

(2) Stainless steel grub screw (Aisi 303) with hexagon socket head (attention: the grub screw is glued in place).

Type of spring thrust:

Normal.

Special requests:

- None.

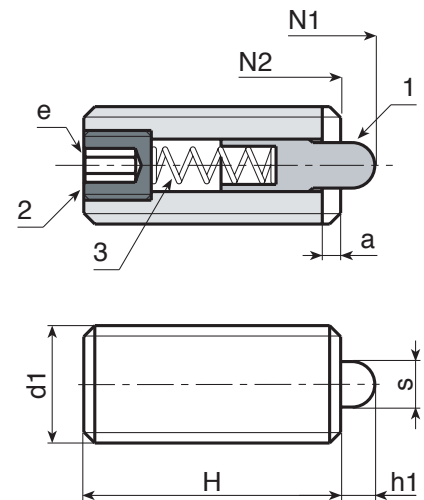

Version W842: black-oxide treated steel

art.	s	H	h1	e	a	b	N1 (N)	N2 (N)	d1 _{6H}	g
W842.VBM04	1.5	15	1.5	1.3	0.6	0.6	5	16	M4	0.8
W842.VBM05	2.4	18	2.3	1.5	0.8	0.8	6	20	M5	1.3
W842.VBM06	2.7	20	2.5	2	1	1	7	20	M6	2.5
W842.VBM08	3.5	22	3	2.5	1.4	1.2	9	35	M8	6
W842.VBM10	4	22	3	3	1.4	1.6	9	35	M10	9
W842.VBM12	6	28	4	4	2	2	10	55	M12	16
W842.VBM16	7.5	32	5	5	2.5	2.5	45	100	M16	35

Version W842CIN - stainless steel (Aisi 303)

art.	s	H	h1	e	a	b	N1 (N)	N2 (N)	d1 _{6H}	g
W842.INM04CIN	1.5	15	1.5	1.3	0.6	0.6	5	16	M4	0.8
W842.INM05CIN	2.4	18	2.3	1.5	0.8	0.8	6	20	M5	1.3
W842.INM06CIN	2.7	20	2.5	2	1	1	7	20	M6	2.5
W842.INM08CIN	3.5	22	3	2.5	1.4	1.2	9	35	M8	6
W842.INM10CIN	4	22	3	3	1.4	1.6	9	35	M10	9
W842.INM12CIN	6	28	4	4	2	2	10	55	M12	16
W842.INM16CIN	7.5	32	5	5	2.5	2.5	45	100	M16	35

INOX

W847-W850CIN

SMOOTH STAINLESS STEEL BALL PLUNGER



INOX

Materials:

Stainless steel plunger body (Aisi 303).

Surface finish:

Smooth.

Colour:

W850CIN:

Body: Natural.

Ball: Natural.

W847:

Body: Natural.

Ball: Natural.

Ball:

W850CIN: Hardened stainless steel ball (Aisi 420).

W847: White moulded plastic ball (POM).

Type of spring thrust:

Normal.

Spring:

Stainless steel spring (Aisi 301).

Special requests:

- None.

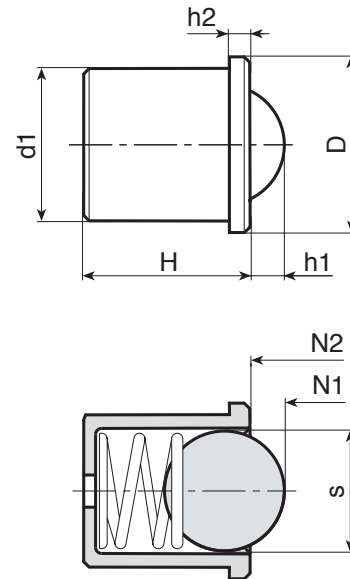

Version W850CIN: with stainless steel ball (Aisi 303)

art.	s	H	h1	h2	D	N1 (N)	N2 (N)	d1(+0.08+0)	g
W850.IND03CIN	2.5	4	0.65	0.8	3.5	1.7	3.5	3	0.2
W850.IND04CIN	3	5	0.8	1	4.6	3	7	4	0.3
W850.IND05CIN	4	6	1	1	5.6	4	7	5	0.6
W850.IND06CIN	5	7	1.5	1	6.5	6	12	6	1
W850.IND08CIN	6.5	9	1.8	1	8.5	6	12	8	2
W850.IND10CIN	8	13.5	2.7	2.5	12	10	20	10	6
W850.IND12CIN	10	16	3.5	2.5	14	15	25	12	10

Version W847: with plastic ball (Delrin)

art.	s	H	h1	h2	D	N1 (N)	N2 (N)	d1(+0.08+0)	g
W847.IND04	3	5	0.8	1	4.6	3	7	4	0.3
W847.IND05	4	6	1	1	5.6	4	7	5	0.6
W847.IND06	5	7	1.5	1	6.5	6	12	6	1
W847.IND08	6.5	9	1.8	1	8.5	6	12	8	2
W847.IND10	8	13.5	2.7	2.5	12	10	20	10	6
W847.IND12	10	16	3.5	2.5	14	15	25	12	10

W850T-W850I



SMOOTH PLASTIC SPRING PLUNGER WITH PLASTIC OR STAINLESS STEEL BALL

Materials:

Moulded plastic plunger body (POM - Delrin).

Surface finish:

Smooth.

Colour:

W850T:
Body: Black (Ral 9011)

Ball: Natural white.

W850I:
Body: Black (Ral 9011)

Ball: Natural.

Ball:

W850T: White plastic ball (POM - Delrin).

W850I: Hardened stainless steel ball (Aisi 420).

Type of spring thrust:

Normal.

Spring:

Stainless steel spring (Aisi 302).

Special requests:

- None.

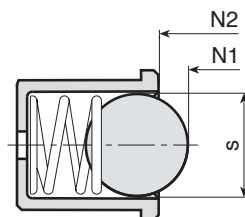
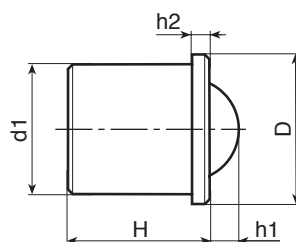

Version W850T: with plastic ball (Delrin)

art.	s	H	h1	h2	D	N1 (N)	N2 (N)	d1(+0.1+0)	g
W850.TND04	3	5	0.7	1	4.6	3	7	4	0.2
W850.TND05	4	6	1	1	5.6	4	7	5	0.35
W850.TND06	5	7	1.5	1	6.5	6	12	6	0.7
W850.TND08	6.5	9	1.8	1	8.5	6	12	8	1.5
W850.TND10	8	13.5	2.7	2.5	12	10	20	10	2
W850.TND12	10	16	3.5	2.5	14	15	25	12	2.3

Version W850I: with stainless steel ball

art.	s	H	h1	h2	D	N1 (N)	N2 (N)	d1(+0.1+0)	g
W850.IND04	3	5	0.7	1	4.6	3	7	4	0.2
W850.IND05	4	6	1	1	5.6	4	7	5	0.4
W850.IND06	5	7	1.5	1	6.5	6	12	6	0.7
W850.IND08	6.5	9	1.8	1	8.5	6	12	8	1.6
W850.IND10	8	13.5	2.7	2.5	12	10	20	10	3
W850.IND12	10	16	3.5	2.5	14	15	25	12	6

W600CIN

SMOOTH FULL STAINLESS STEEL BALL PLUNGER WITHOUT COLLAR



INOX

Materials:

Stainless steel plunger body (Aisi 303).

Surface finish:

Smooth.

Colour:

Natural stainless steel.

Ball:

Hardened stainless steel ball (Aisi 420).

Type of spring thrust:

Normal.

Spring:

Stainless steel spring (Aisi 301).

Special requests:

- None.

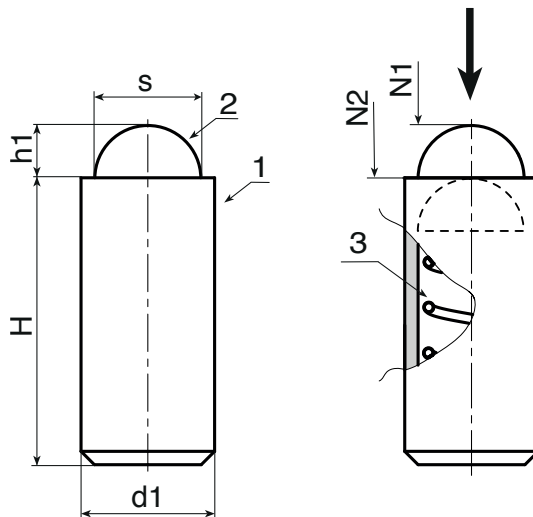

INOX

art.	s	H	h1	N1 (N)	N2 (N)	d1(+0.02 -0.06)	g
W600.IND03CIN	2	7	0.65	5	7	3	0.4
W600.IND04CIN	3	9	0.8	12	22	4	0.6
W600.IND05CIN	4	12	1	19	30	5	1.2
W600.IND06CIN	5	14	1.5	22	40	6	2
W600.IND08CIN	6	16	1.8	42	73	8	5
W600.IND10CIN	8	22	2.7	54	100	10	9
W600.IND12CIN	10	24	3.2	54	122	12	15

W610

SMOOTH BRASS DOUBLE BALL SPRING PLUNGER



Materials:

Plunger body in turned brass.

Ball:

Hardened stainless steel ball (Aisi 420).

Type of spring thrust:

Normal.

Spring:

Stainless steel spring (Aisi 301).

Special requests:

- None.

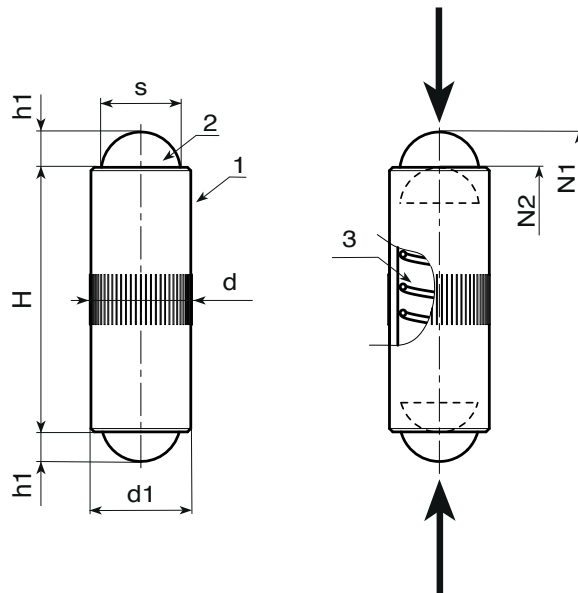

W.P

art.	s	H(+0-0.2)	h1	d(+0.05-0)	N1 (N)	N2 (N)	d1	g
W610.OND04	3	10	0.9	4.05	3	7	4	0.7
W610.OND05	4	12	1.2	5.05	4	8	5	1.3
W610.OND06	5	16	1.6	6.05	6	10	6	2.4
W610.OND08	6	20	2	8.05	8	12	8	5.8
W610.OND10	8	24	2.9	10.05	10	16	10	10.5

W605

NEW

+50°
-20°

POM

Aisi 303

UL94 HB

RoHS COMPLIANT

SMOOTH STAINLESS STEEL BALL PLUNGER WITH PLASTIC OR STEEL NOSE PIN

INOX

Materials:

Stainless steel plunger body (Aisi 303).

Surface finish:

Smooth.

Colour:

Body:
Natural.

Nose pin:

W605POM:
Natural white.

W605CIN:
Natural.

Nose pin:

W605POM:
Plastic nose pin (POM - Delrin).

W605CIN:
Turned stainless steel nose pin (Aisi 303).

Type of spring thrust:

Normal.

Spring:

Stainless steel spring (Aisi 301).

Special requests:

- None.

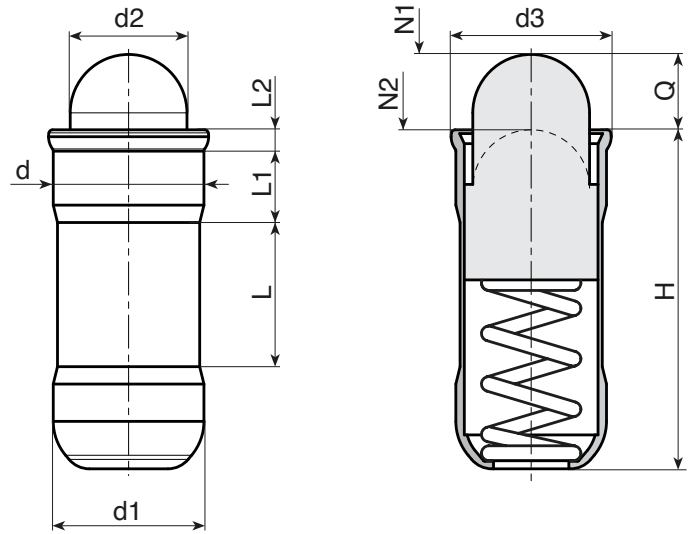

Version W605POM: with white plastic nose pin (POM)

art.	d+0,1	d2	d3	H	L	L1	L2	N1 (N)	N2 (N)	d1(±0.05)	Q	g
W605.IND04POM	4	2,8	4,6	10,7	5,6	1,8	0,9	3	8,2	4	2,7	1
W605.IND05POM	5	3,8	5,6	12	6	2,1	0,9	3,3	9	5	4	1
W605.IND06POM	6	4,8	6,5	15	8,2	2,3	1	6,1	12	6	5,5	1,1
W605.IND08POM	8	6,2	8,5	18	9,5	2,9	1,1	10,7	17	8	6,5	2,3
W605.IND10POM	10	8	11	26	14,3	4,2	1,5	16,2	29	10	8	5

Version W605CIN: with stainless steel nose pin (Aisi303)

art.	d+0,1	d2	d3	H	L	L1	L2	N1 (N)	N2 (N)	d1(±0.05)	Q	g
W605.IND04CIN	4	2,8	4,6	10,7	5,6	1,8	0,9	3	8,2	4	2,7	0,7
W605.IND05CIN	5	3,8	5,6	12	6	2,1	0,9	3,3	9	5	4	1,2
W605.IND06CIN	6	4,8	6,5	15	8,2	2,3	1	6,1	12	6	5,5	2,2
W605.IND08CIN	8	6,2	8,5	18	9,5	2,9	1,1	10,7	17	8	6,5	4,2
W605.IND10CIN	10	8	11	26	14,3	4,2	1,5	16,2	29	10	8	9

W620

SCREW-TYPE SPRING BALL PLUNGER



AVP

Aisi 303

RoHS COMPLIANT

Materials:

W620:

Turned free-cutting steel screw, with hexagon socket head.

W620CIN:

Turned stainless steel screw (Aisi 303), with hexagon socket head.

Surface finish:

Smooth.

Colour:

W620:

Black-oxide treated.

W620CIN:

Natural.

Ball:

Hardened stainless steel ball (Aisi 420).

Spring:

Stainless steel spring (Aisi 301).

Type of spring thrust:

Normal.

Special requests:

- None.

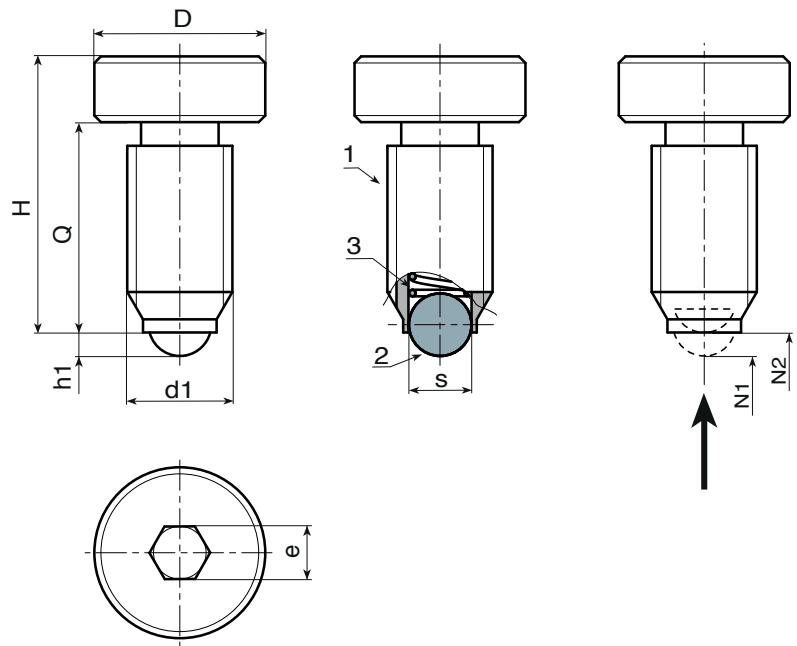

Version W620 - black-oxide treated steel

art.	D(+0-0.2)	H	h1	e	s	N1 (N)	N2 (N)	d1 _{6g}	Q	g
W620.VBM06X12	10	16	1	3	3.5	9	9	M6	12	4
W620.VBM08X16	13	21	1.5	4	5	15	15	M8	16	9
W620.VBM10X20	16	26	2	5	6	20	20	M10	20	17
W620.VBM12X25	18	32	2.5	6	8	30	30	M12	25	27

Version W620 CIN - stainless steel (Aisi 303)

art.	D(+0-0.2)	H	h1	e	s	N1 (N)	N2 (N)	d1 _{6g}	Q	g
W620.INM06X12CIN	10	16	1	3	3.5	9	9	M6	12	4
W620.INM08X16CIN	13	21	1.5	4	5	15	15	M8	16	9
W620.INM10X20CIN	16	26	2	5	6	20	20	M10	20	17
W620.INM12X25CIN	18	32	2.5	6	8	30	30	M12	25	27

INOX

W622



LONG SMOOTH STEEL SPRING PLUNGER WITH HEAD

Materials:

(2) Plunger body in free-cutting steel.

Surface finish:

Smooth.

Colour:

Black-oxide treated.

Nose pin:

Hardened steel nose pin.

Type of spring thrust:

Normal.

Spring:

Harmonic steel spring.

Special requests:

- None.

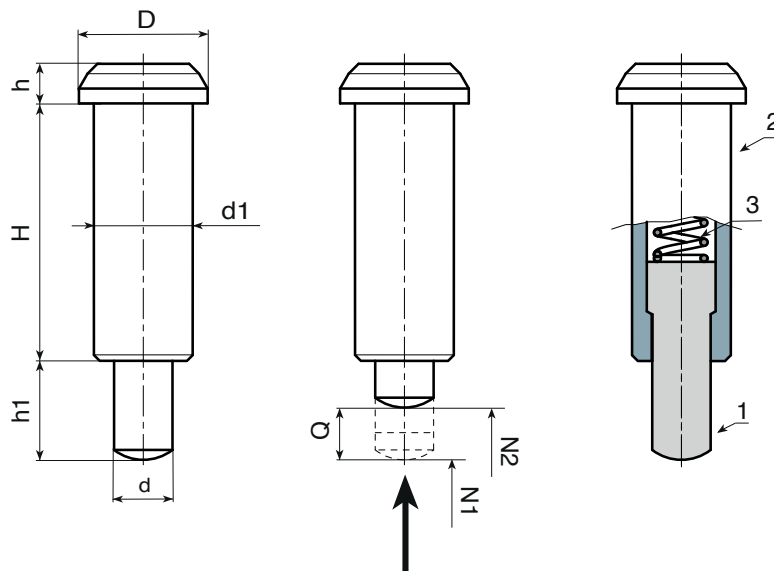

	art.	D	H	h1	h	d	N1 (N)	N2 (N)	d1(+0-0.08)	g
●	W622.VBD08	10	20.8	8	3.2	3.95	30	90	8	8
●	W622.VBD10	13	26	10	4	5.95	42	110	10	14
●	W622.VBD12	16	31	12	5	7.95	50	130	12	26

W624



LONG THREADED STEEL SPRING PLUNGER WITH NOSE PIN

Materials:

Turned and threaded plunger body made of steel with strength class 5.8.

Surface finish:

Smooth.

Colour:

Black-oxide treated.

Nose pin:

Turned point made of high-resistance hardened steel.

Spring:

Harmonic steel spring.

Type of spring thrust:

Normal.

Special requests:

- None.

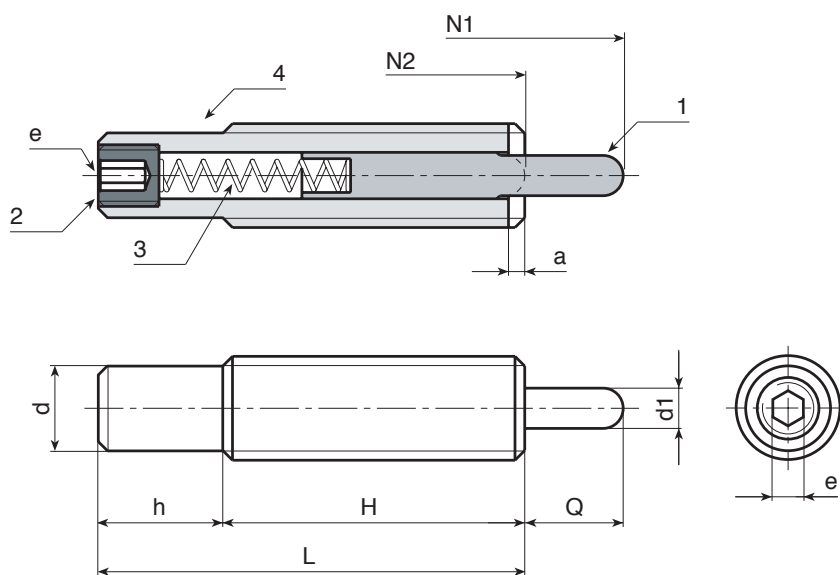

W.P

art.	L	D	H	h	d	a	b	e	d1	Q	g	N1 (N)	N2 (N)
W624030.VBM08Q03.5X06	30	M08	20	10	6.2	1.4	1.2	2.5	3.5	6	9	8	20
W624040.VBM08Q03.5X08	40	M08	20	20	6.2	1.4	1.2	2.5	3.5	8	10	10	28
W624050.VBM08Q03.5X10	50	M08	20	30	6.2	1.4	1.2	2.5	3.5	10	10	12	38
W624060.VBM08Q03.5X15	60	M08	20	40	6.2	1.4	1.2	2.5	3.5	15	14	15	48
W624040.VBM10Q04X08	40	M10	30	10	8	1.4	1.6	3	4	8	15	12	30
W624050.VBM10Q04X10	50	M10	30	20	8	1.4	1.6	3	4	10	18	16	46
W624060.VBM10Q04X15	60	M10	30	30	8	1.4	1.6	3	4	15	21	20	55
W624080.VBM10Q04X20	80	M10	30	50	8	1.4	1.6	3	4	20	28	25	65
W624050.VBM12Q06X10	50	M12	30	20	9.6	2	2	4	6	10	28	20	50
W624060.VBM12Q06X15	60	M12	30	30	9.6	2	2	4	6	15	31	25	76
W624080.VBM12Q06X20	80	M12	30	50	9.6	2	2	4	6	20	40	35	102
W624100.VBM12Q06X25	100	M12	30	70	9.6	2	2	4	6	25	47	40	102
W624060.VBM16Q07.5X12	60	M16	30	30	13.4	2.5	2.5	5	7.5	12	63	30	64
W624080.VBM16Q07.5X10	80	M16	30	50	13.4	2.5	2.5	5	7.5	10	80	30	110
W624100.VBM16Q07.5X30	100	M16	30	70	13.4	2.5	2.5	5	7.5	30	100	30	120
W624120.VBM16Q07.5X40	120	M16	30	90	13.4	2.5	2.5	5	7.5	40	118	20	130



IT'S INEVITABLE
QUALITY
BECOMES A
REFERENCE



BOTECO[®]

W612

LATERAL ALUMINIUM SPRING PLUNGER



Versions:

- W612: Lateral spring plunger with galvanised steel nose pin.
- W613: Lateral spring plunger with galvanised steel nose pin and seal.
- W614: Lateral spring plunger with POM nose pin.
- W615: Lateral spring plunger with POM nose pin and seal.

Materials:

- All:
- (1) Turned aluminium plunger body.
 - (3) Stainless steel spring (Aisi 302).
 - (4) Black seal (W613-W615).

Versions W612-W613

- (2) Hardened steel nose pin.

Versions W614-W615

- (2) White plastic nose pin (POM - Delrin).

Surface finish:

Smooth.

Colour:

- (1,3) Natural.
- (2) W612-W613: Galvanized.
- (2) W614-W615: Natural white.

ATTENTION:

We recommend the plunger hole to be made with a +0.1 mm tolerance.

ATTENTION:

The plunger mount bush can be ordered separately. See the code no. on the product line. Turned galvanised free-cutting steel bush.

Special requests:

- None.



W612



W613

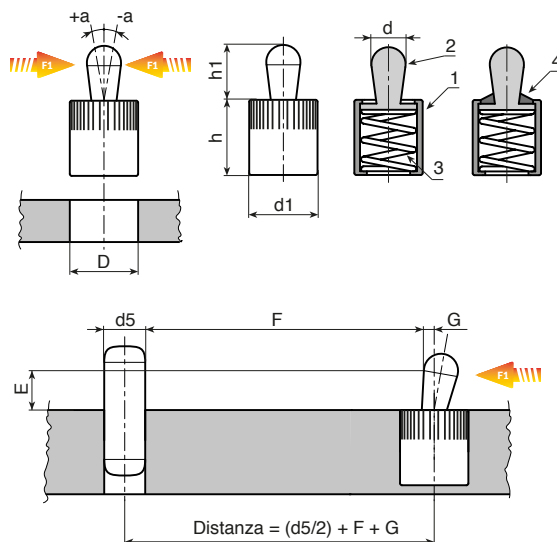
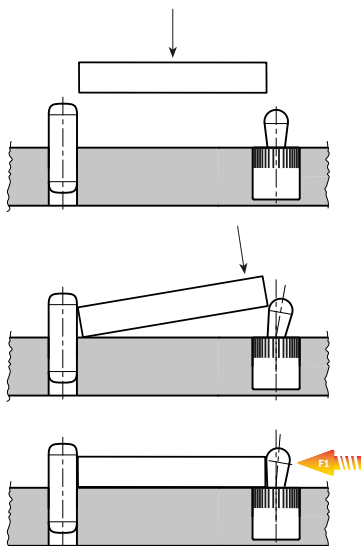
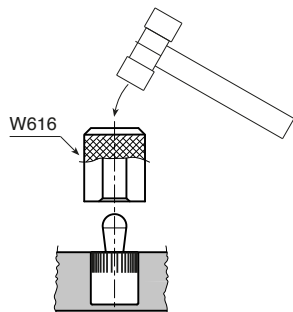

W612

LATERAL ALUMINIUM SPRING PLUNGER



Version W612: Lateral spring plunger with steel nose pin

art.	d1	d	h	h1	D	a	F1 (N)	G E=1	G E=2	G E=3	G E=4,5	G E=6	G E=8	g	Bush
W612006.VZD03F010	6	3	7	4	6,1	0,5	10	0,8	1	1	1	1	1	0,6	W616.03
W612006.VZD03F020	6	3	7	4	6,1	0,5	20	0,8	1	1	1	1	1	0,7	W616.03
W612006.VZD03F040	6	3	7	4	6,1	0,5	40	0,8	1	1	1	1	1	1,3	W616.03
W612010.VZD05F020	10	5	11	6,7	10,1	0,8	20	-	1,5	1,7	1,7	1,7	1,7	2,5	W616.05
W612010.VZD05F050	10	5	11	6,7	10,1	0,8	50	-	1,5	1,7	1,7	1,7	1,7	2,8	W616.05
W612010.VZD05F100	10	5	11	6,7	10,1	0,8	100	-	1,5	1,7	1,7	1,7	1,7	3	W616.05
W612010.VZD06F040	10	6	11	10,7	10,1	1	40	-	-	-	1,7	1,9	1,9	3,5	W616.06
W612010.VZD06F075	10	6	11	10,7	10,1	1	75	-	-	-	1,7	1,9	1,9	3,6	W616.06
W612010.VZD06F100	10	6	11	10,7	10,1	1	100	-	-	-	1,7	1,9	1,9	3,6	W616.06
W612012.VZD08F050	12	8	13	13,9	12,1	1,3	50	-	-	-	-	2,5	2,7	6,8	W616.08
W612012.VZD08F100	12	8	13	13,9	12,1	1,3	100	-	-	-	-	2,5	2,7	7,4	W616.08
W612012.VZD08F150	12	8	13	13,9	12,1	1,3	150	-	-	-	-	2,5	2,7	7,8	W616.08
W612016.VZD10F100	16	10	17	16,7	16,1	1,6	100	-	-	-	-	-	3,1	14,7	W616.10
W612016.VZD10F150	16	10	17	16,7	16,1	1,6	150	-	-	-	-	-	3,1	14,8	W616.10
W612016.VZD10F200	16	10	17	16,7	16,1	1,6	200	-	-	-	-	-	3,1	15,7	W616.10

Version W613: Lateral spring plunger with steel nose pin with seal

art.	d1	d	h	h1	D	a	F1 (N)	G E=1	G E=2	G E=3	G E=4,5	G E=6	G E=8	g	Bush
W613006.VZD03F010	6	3	7	4	6,1	0,5	10	0,8	1	1	1	1	1	0,6	W616.03
W613006.VZD03F020	6	3	7	4	6,1	0,5	20	0,8	1	1	1	1	1	0,7	W616.03
W613006.VZD03F040	6	3	7	4	6,1	0,5	40	0,8	1	1	1	1	1	1,4	W616.03
W613010.VZD05F020	10	5	11	6,7	10,1	0,8	20	-	1,5	1,7	1,7	1,7	1,7	2,6	W616.05
W613010.VZD05F050	10	5	11	6,7	10,1	0,8	50	-	1,5	1,7	1,7	1,7	1,7	2,8	W616.05
W613010.VZD05F100	10	5	11	6,7	10,1	0,8	100	-	1,5	1,7	1,7	1,7	1,7	3	W616.05
W613010.VZD06F040	10	6	11	10,7	10,1	1	40	-	-	-	1,7	1,9	1,9	3,4	W616.06
W613010.VZD06F075	10	6	11	10,7	10,1	1	75	-	-	-	1,7	1,9	1,9	3,7	W616.06
W613012.VZD08F050	12	8	13	13,9	12,1	1,3	50	-	-	-	-	2,5	2,7	6,8	W616.08
W613012.VZD08F100	12	8	13	13,9	12,1	1,3	100	-	-	-	-	2,5	2,7	7,4	W616.08
W613012.VZD08F150	12	8	13	13,9	12,1	1,3	150	-	-	-	-	2,5	2,7	7,8	W616.08
W613016.VZD10F100	16	10	17	16,7	16,1	1,6	100	-	-	-	-	-	3,1	15,1	W616.10
W613016.VZD10F150	16	10	17	16,7	16,1	1,6	150	-	-	-	-	-	3,1	15,2	W616.10
W613016.VZD10F200	16	10	17	16,7	16,1	1,6	200	-	-	-	-	-	3,1	15,8	W616.10

Version W614: Lateral spring plunger with POM nose pin

art.	d1	d	h	h1	D	a	F1 (N)	G E=1	G E=2	G E=3	G E=4,5	G E=6	G E=8	g	Bush
W614006.VZD03F010	6	3	7	4	6,1	0,5	10	0,8	1	1	1	1	1	0,4	W616.03
W614010.VZD05F020	10	5	11	6,7	10,1	0,8	20	-	1,5	1,7	1,7	1,7	1,7	1,3	W616.05
W614010.VZD06F040	10	6	11	10,7	10,1	1	40	-	-	-	1,7	1,9	1,9	1,5	W616.06
W614012.VZD08F050	12	8	13	13,9	12,1	1,3	50	-	-	-	-	2,5	2,7	2,9	W616.08
W614016.VZD10F100	16	10	17	16,7	16,1	1,6	100	-	-	-	-	-	3,1	7,2	W616.10

Version W615: Lateral spring plunger with POM nose pin and seal

art.	d1	d	h	h1	D	a	F1 (N)	G E=1	G E=2	G E=3	G E=4,5	G E=6	G E=8	g	Bush
W615006.VZD03F010	6	3	7	4	6,1	0,5	10	0,8	1	1	1	1	1	0,4	W616.03
W615010.VZD05F020	10	5	11	6,7	10,1	0,8	20	-	1,5	1,7	1,7	1,7	1,7	1,3	W616.05
W615010.VZD06F040	10	6	11	10,7	10,1	1	40	-	-	-	1,7	1,9	1,9	1,6	W616.06
W615012.VZD08F050	12	8	13	13,9	12,1	1,3	50	-	-	-	-	2,5	2,7	2,9	W616.08
W615016.VZD10F100	16	10	17	16,7	16,1	1,6	100	-	-	-	-	-	3,1	7,3	W616.10

W848



THREADED STEEL GRUB SCREW WITH HEAGON SOCKET END AND PLASTIC BALL POINT

Materials:

W848:

Steel grub screw body with strength class 10.9.

W848CIN:

Stainless steel grub screw body (Aisi 303).

Surface finish:

Smooth.

Colour:

W849:

Black-oxide treated.

W849CIN:

Natural.

Ball:

White plastic ball (POM - Delrin).

Special requests:

- None.

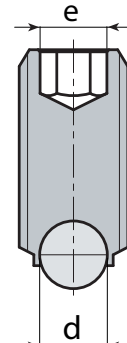
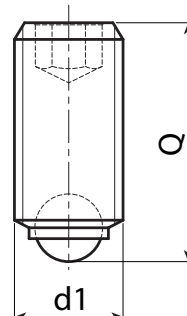

Version W848: black-oxide treated steel

art.	d1 _{6g}	e	d	Q	g
W848.SBM04X..	M4	2	2.5	6-8-10-12-16	1-1-1-1-1
W848.SBM05X..	M5	2.5	3	8-10-16-20-25	1-1-1,7-2-2,9
W848.SBM06X..	M6	3	4	11-13-17-21-26	1,3-1,8-2,4-3-4
W848.SBM08X..	M8	4	5.5	11-13-17-21-26-31	3-3-4-5-7-9
W848.SBM10X..	M10	5	7	14-18-22-27-37	5-6-9-11-16
W848.SBM12X..	M12	6	8.5	18-22-32-42	10-11-18-22

Enter the selected grub screw length in place of the two dots . . in the item code.

Version W848 CIN - stainless steel (Aisi 303).



art.	d1 _{6g}	e	d	Q	g
W848.INM04X..CIN	M4	2	2.5	8-10-12-16	1-1-1-1-1
W848.INM05X..CIN	M5	2.5	3	8-10-16-20-25	1-1-1,7-2-2,9
W848.INM06X..CIN	M6	3	4	11-13-17-21-26	1,3-1,8-2,4-3-4
W848.INM08X..CIN	M8	4	5.5	11-13-17-21-26-31	3-3-4-5-7-9

Enter the selected grub screw length in place of the two dots . . in the item code.

W849



C40

Aisi 303



THREADED STEEL GRUB SCREW WITH HEAGON SOCKET END AND STEEL BALL POINT

Materials:

W849:

Quenched steel grub screw body with strength class 10.9.

W849CIN:

Stainless steel grub screw body (Aisi 303).

Surface finish:

Smooth.

Colour:

W849:

Black-oxide treated.

W849CIN:

Natural.

Ball:

Hardened stainless steel ball (Aisi 420).

Special requests:

- None.

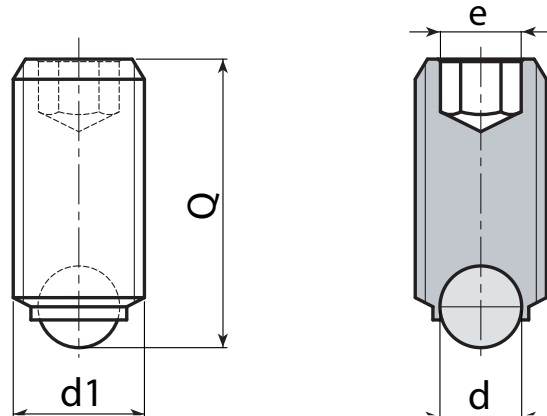

Version W849: black-oxide treated steel

art.	d1 _{6g}	e	d	Q	g
W849.SBM04X..	M4	2	2.5	6-8-10-12-16	1-1-1-1-1
W849.SBM05X..	M5	2.5	3	8-10-12-16-20-25	1-1-1,3-1,7-2-2,9
W849.SBM06X..	M6	3	4	11-13-17-21-26	1,3-1,8-2,4-3-4
W849.SBM08X..	M8	4	4.5	11-13-17-21-26-31	3-3-4-5-7-9
W849.SBM10X..	M10	5	7	14-18-22-27-37	5-6-9-11-16
W849.SBM12X..	M12	6	8.5	18-22-32-42	10-11-18-21,5
W849.SBM16X..	M16	8	12	23-28-38-53	22-28-41-48
W849.SBM20X..	M20	10	15	34-44-64	54-74-120

Enter the selected grub screw length in place of the two dots .. in the item code.

Version W849CIN - stainless steel (Aisi 303)

INOX

art.	d1 _{6g}	e	d	Q	g
W849.INM04X..CIN	M4	2	2.5	6-8-10-12-16	1-1-1-1-1
W849.INM05X..CIN	M5	2.5	3	8-10-16-20-25	1-1-1,7-2-2,9
W849.INM06X..CIN	M6	3	4	11-13-17-21-26	1,3-1,8-2,4-3-4
W849.INM08X..CIN	M8	4	5.5	11-13-17-21-26-31	3-3-4-5-7-9
W849.INM10X..CIN	M10	5	7	14-18-22-27-37	5-6-9-11-16
W849.INM12X..CIN	M12	6	8.5	18-22-32-42	10-11-18-21,5

Enter the selected grub screw length in place of the two dots .. in the item code.

W851



THREADED STEEL GRUB SCREW WITH HEAGON SOCKET END AND FLATTENED BALL POINT

Materials:

W851:

Quenched steel grub screw body with strength class 10.9.

W851CIN:

Stainless steel grub screw body (Aisi 303).

Surface finish:

Smooth.

Surface finish:

W851:

Black-oxide treated.

W851CIN:

Natural.

Ball:

Flattened hardened stainless steel ball (Aisi 420). Optimal angle adjustment between 0° and 9°. The ball is not fixed, it can rotate.

Special requests:

- None.

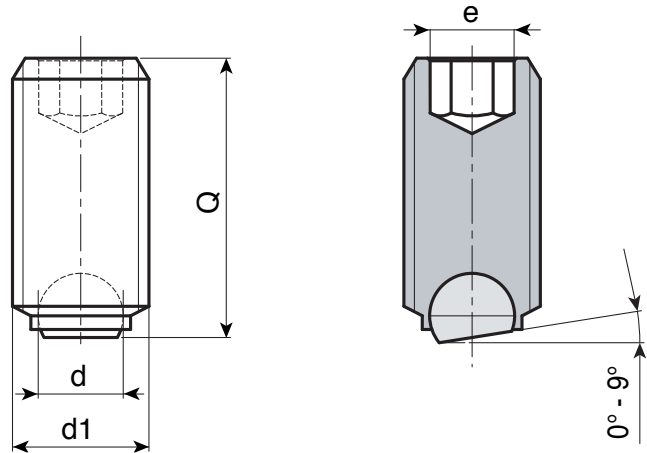

Version W851: black-oxide treated steel

art.	d1 _{6g}	e	d	Q	g
W851.SBM04X..	M4	2	2.5	06-08-10-12-16	0,5-0,5-0,7-0,9-1
W851.SBM05X..	M5	2.5	3	07,5-09,5-11,5-15,5-19,5-24,5	1-1-1,5-1,5-2,5-3
W851.SBM06X..	M6	3	4	10-12-16-20-25	1,5-1,8-2,5-3-4
W851.SBM08X..	M8	4	5.5	10-12-16-20-25-30	2,5-3,5-4-5-7,5-9
W851.SBM10X..	M10	5	7	12-16-20-25-35	5-7-9-11-16
W851.SBM12X..	M12	6	8.5	16-20-30-40	10-12,5-20-28,5
W851.SBM16X..	M16	8	12	20-25-35-50	22-28-41-48
W851.SBM20X..	M20	10	15	30-40-60	54-74-120

Enter the selected grub screw length in place of the two dots . . in the item code.

Version W851CIN - stainless steel (Aisi 303)



art.	d1 _{6g}	e	d	Q	g
W851.INM04X..CIN	M4	2	2.5	06-08-10-12-16	0,5-0,5-0,7-0,9-1
W851.INM05X..CIN	M5	2.5	3	07,5-09,5-11,5-15,5-19,5-24,5	1-1-1,5-1,5-2,5-3
W851.INM06X..CIN	M6	3	4	10-12-16-20-25	1,5-1,8-2,5-3-4
W851.INM08X..CIN	M8	4	5.5	10-12-16-20-25-30	2,5-3,5-4-5-7,5-9
W851.INM10X..CIN	M10	5	7	12-16-20-25-35	5-7-9-11-16
W851.INM12X..CIN	M12	6	8.5	16-20-30-40	10-12,5-20-28,5

Enter the selected grub screw length in place of the two dots . . in the item code.



732 ()

Stock availability as % (🛒)
90% (●) - 40% (●) - 5% (●)

W852



C40



THREADED STEEL GRUB SCREW WITH HEAGON SOCKET END AND FLATTENED KNURLED BALL POINT

Materials:

Quenched steel grub screw body with strength class 10.9.

Surface finish:

Smooth.

Colour:

Nose pin:

Natural

Grub screw body:

Black-oxide treated.

Ball:

Flattened knurled hardened stainless steel ball (Aisi 420). Optimal angle adjustment between 0° and 9°. The ball is not fixed, it can rotate.

Special requests:

- None.

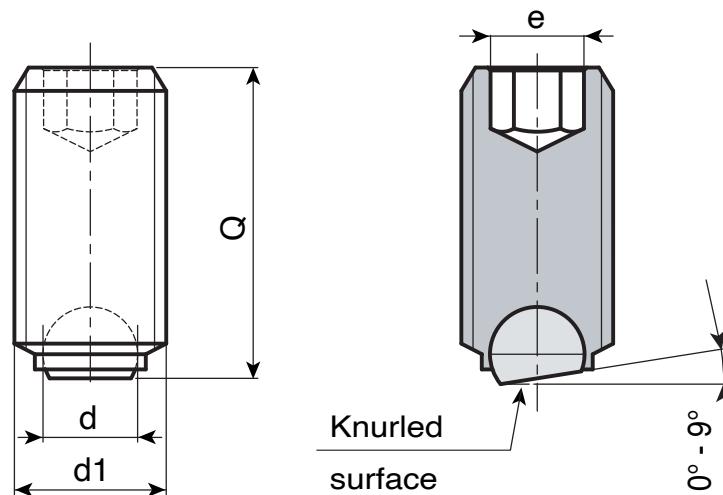

art.	d1 _{6g}	e	d	Q	g
W852.SBM10X..	M10	5	7	12-16-20-25-35	5-7-9-11-16
W852.SBM12X..	M12	6	8.5	16-20-30-40	10-12,5-20-28,5
W852.SBM16X..	M16	8	12	20-25-35-50	22-28-41-48

Enter the selected grub screw length in place of the two dots . . in the item code.

W853



POM

C40

UL94
HB

RoHS
COMPLIANT

THREADED STEEL GRUB SCREW WITH HEAGON SOCKET END AND FLATTENED PLASTIC BALL POINT

Materials:

Quenched steel grub screw body with strength class 10.9.

Surface finish:

Smooth.

Colour:

Nose pin:

Red.

Grub screw body:

Black-oxide treated.

Ball:

Flattened plastic ball (POM - Delrin). Optimal angle adjustment between 0° and 9°. The ball is not fixed, it can rotate.

Special requests:

- None.

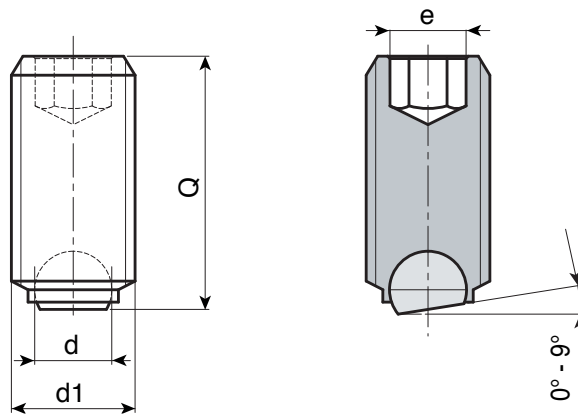

art.	d1 _g	e	d	Q	g
W853.SBM04X..	M4	2	2.5	06-08-10-12-16	0,5-0,5-0,5-0,7-1
W853.SBM05X..	M5	2.5	3	07,5-09,5-11,5-15,5-19,5-24,5	1-1-1,5-1,5-2,5-3
W853.SBM06X..	M6	3	4	10-12-16-20-25	1,5-1,8-2,5-3-4
W853.SBM08X..	M8	4	5.5	10-12-16-20-25-30	2,5-3,5-4-5-7,5-9

Enter the selected grub screw length in place of the two dots . . in the item code.

W860



THREADED STEEL GRUB SCREW WITH HEAGON SOCKET END AND BRASS NOSE PIN

Materials:

W860:

Quenched steel grub screw body with strength class 10.9.

W860CIN:

Stainless steel grub screw body (Aisi 303).

Surface finish:

Smooth.

Colour:

W860:

Black-oxide treated.

W860CIN:

Natural.

Nose pin:

Fixed brass cylindrical nose pin.

Special requests:

- None.

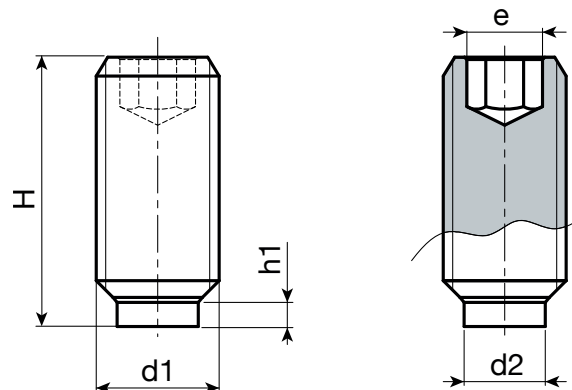

Version W860: black-oxide treated steel

art.	d1 _{6g}	e	h1	d2	Q	g
W860.SBM04X..	M4	2	1.2	2.5	06,5-10,5-16,5-30,5	1-1-1,5-2
W860.SBM05X..	M5	2.5	1.3	3	08,5-12,5-20,5-30,5	1-1,5-2,5-4
W860.SBM06X..	M6	3	1.9	4	11,5-17,5-26,5-41,5	2-2,5-4-6,5
W860.SBM08X..	M8	4	2.5	5.5	12-22-32-52	3,5-6-8,5-14
W860.SBM10X..	M10	5	2.7	7	14-18-27-37-52	5,5-7-11,5-16,5-25
W860.SBM12X..	M12	6	3.4	8.5	18.5-22.5-32.5-42.5-52.5	10,5-13-20-29-38

Enter the selected grub screw length in place of the two dots . . in the item code.

Version W860CIN - stainless steel (Aisi 303)



art.	d1 _{6g}	e	h1	d2	Q	g
W860.INM04X..CIN	M4	2	1.2	2.5	06,5-10,5-16,5	1-1-1,5
W860.INM05X..CIN	M5	2.5	1.3	3	08,5-12,5-20,5	1-1,5-2,5
W860.INM06X..CIN	M6	3	1.9	4	11,5-17,5-26,5	2-2,5-4
W860.INM08X..CIN	M8	4	2.5	5.5	12-22-32	3,5-6-8,5
W860.INM10X..CIN	M10	5	2.7	7	14-18-27-37	5,5-7-11,5-16,5
W860.INM12X..CIN	M12	6	3.4	8.5	22.5-32.5-42.5	12,5-20-29

Enter the selected grub screw length in place of the two dots . . in the item code.



735 ()

Stock availability as % (🛒)
 90% (●) - 40% (●) - 5% (●)

W861



THREADED STEEL GRUB SCREW WITH HEAGON SOCKET END AND PLASTIC NOSE PIN

Materials:

W861:

Quenched steel grub screw with strength class 10.9.

W861CIN:

Stainless steel grub screw body (Aisi 303).

Surface finish:

Smooth.

Colour:

W861:

Black-oxide treated.

W861CIN:

Natural.

Nose pin:

Fixed white plastic cylindrical nose pin (POM-Delrin).

Special requests:

- None.

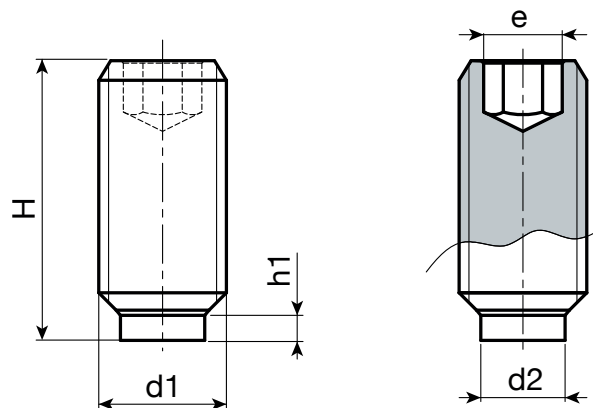

Version W861: black-oxide treated steel

art.	d1 _{6g}	e	h1	d2	Q	g
W861.SBM04X..	M4	2	1	2	07-09-11-13-17-31	1-1-1-1-2,5
W861.SBM05X..	M5	2.5	1	3	09-11-13-17-21-31	1-1-1-2-2-3,5
W861.SBM06X..	M6	3	1.3	3.5	11-13-17-21-26-33-41-51	1-1,5-2-3-4-5-6-8
W861.SBM08X..	M8	4	1.6	5	13,5-17,5-21,5-26,5-33,5-51,5	2-4-5-7-11-14
W861.SBM10X..	M10	5	1.9	6.5	18-22-27-34-42-52-62-82	5-7-9-13-16-21-25-34
W861.SBM12X..	M12	6	2.1	8	22-27-34-42-52-62	9-13-18-24-31-40

Enter the selected grub screw length in place of the two dots . . in the item code.



Version W861CIN - stainless steel (Aisi 303)

art.	d1 _{6g}	e	h1	d2	Q	g
W861.INM04X..CIN	M4	2	1	2	07-09-11-13-17	1-1-1-1-1
W861.INM05X..CIN	M5	2.5	1	3	09-11-13-17-21	1-1-1-2-2
W861.INM06X..CIN	M6	3	1.3	3.5	11-13-17-21-26	1-1,5-2-3-4
W861.INM08X..CIN	M8	4	1.6	5	13,5-17,5-21,5-26,5	2-4-5-7
W861.INM10X..CIN	M10	5	1.9	6.5	18-22-27-37	5-7-9-14
W861.INM12X..CIN	M12	6	2.1	8	22-32-42	9-18-24

Enter the selected grub screw length in place of the two dots . . in the item code.



736 ()

Stock availability as % (🛒)
90% (●) - 40% (●) - 5% (●)